

MARRIPALEM LAY-OUT (PART) IN S. NO 106 & 113.

SCALE :- 1" = 132'-0"



L.P. NO 10/83

FILE RC NO 312/81 G3

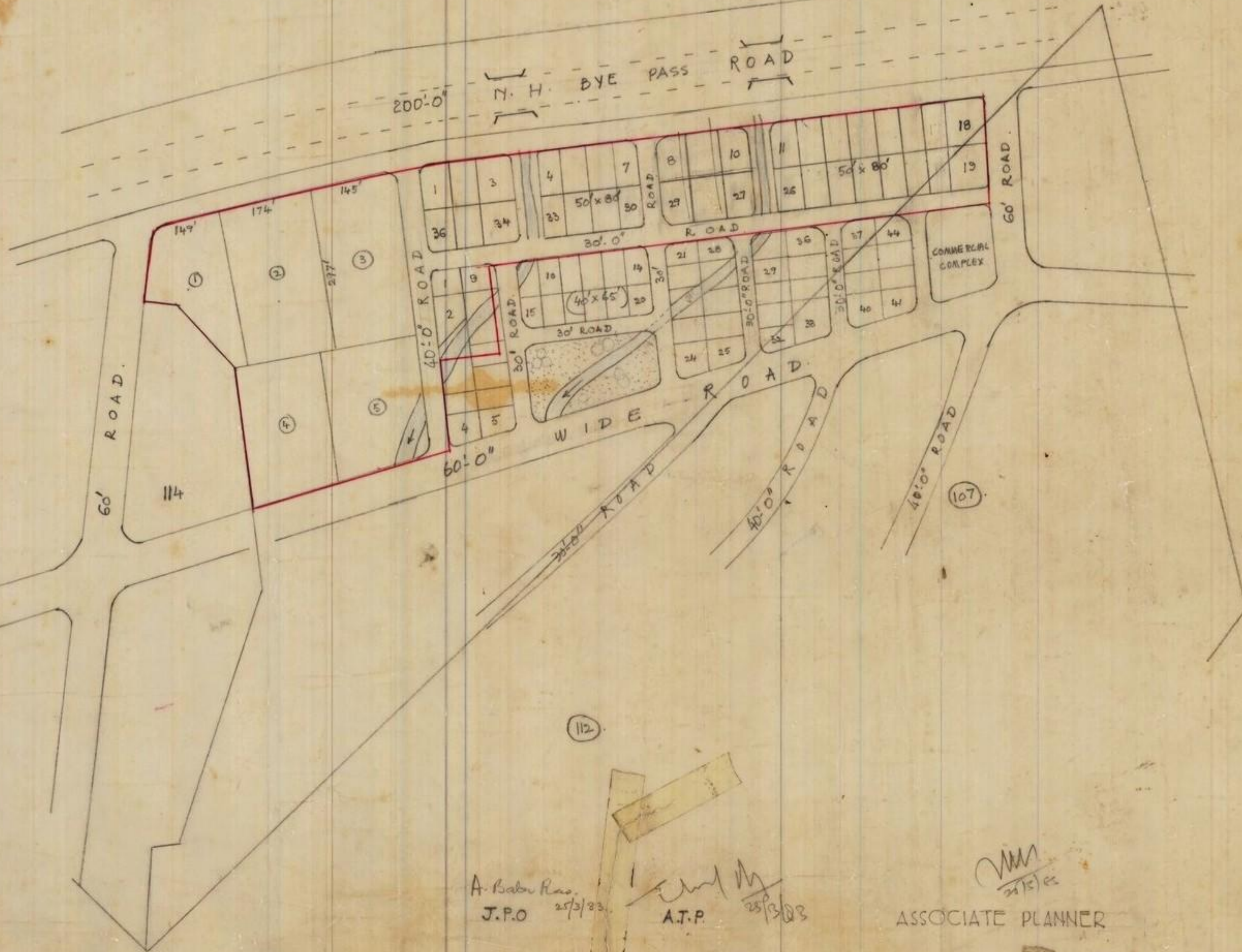

REFERENCE

1. EXTENT OF LAYOUT. AC 10.00.
2. PLOTTED AREA. AC 3-46.
3. ROADS AC 1-33.
4. GEDDAS. AC 0-21.
5. SITE FOR GOVT OFFICES AC 5-00.
6. NO OF PLOTS } 50' x 80' = 36.  
 PROPOSED. } 40' x 65' = 3.  
 39

— LAY-OUT BOUNDARY.

A. Babu Rao  
J.P.O 25/3/83

*[Signature]*  
A.T.P. 25/3/83

*[Signature]*  
ASSOCIATE PLANNER