

AREA SCHEDULE			
S.V. NO.	SUB DIVISION	EXTENT AS PER DOC.	APPROX. EXTENT AS PER GEOMETRIC MEASUREMENT
57	1	3.36 Acs	3.23 Acs
Total Area		3.36 Acs	3.23 Acs

PLAN SHOWING THE PROPOSED LAYOUT IN S.No-57/1P OF RAJULATIMMAPURAM VILLAGE, DENKADA MANDAL, VIZIANAGARAM DIST.

LAND BELONGS TO :-
Sri. RAMA RAO VELPURI

SL. NO.	DESCRIPTION	EXTENT IN ACS. CTS.	PERCENTAGE
1.	PLOTTED AREA	1.84	56.96 %
2.	AMENITIES AREA	0.07	2.17 %
3.	UTILITIES AREA	0.02	0.62 %
4.	ROADS AREA	0.97	30.03 %
5.	OPEN SPACE AREA	0.33	10.22 %
TOTAL AREA		3.23	100.00 %

PLOTS DETAIL :-

SL. NO.	PLOT SIZE	PLOT AREA IN Sq. yds.	PLOTS NOS	NO. OF PLOTS
1.	66' x 115'	843.83	13	01
2.	58' x 76'	489.78	28	01
3.	40' x 75'	333.83	1 to 12	12
4.	40' x 67'	297.78	14 to 16	03
5.	40' x 60'	266.67	17 to 27	11
6.	30' x 30'	100.00	29	01
TOTAL NO. OF PLOTS			29	

- PROPOSED LAYOUT BOUNDARY
- PLOTS MORTGAGE TO VUDA
PLOT NO'S : 03 to 06 (04 PLOTS)
Total Area 0.2870 Cts
- UTILITIES AREA Ac 0.02 Cts

Rama Rao
OWNER SIGNATURE

B.S. Kishan
LICENSED ENGINEER

SCALE : 1 Inch : 66 Feet

FILE R.C.No : 12314/2017/LB

L.P.No : 105/2018

B. Srinivas
15/5/18
S/D Man

Ramkrishna
19/5/18
J.P.O

Ammaiah
ASST. PLANNING OFFICER

Devi
19/5/18
CHIEF URBAN PLANNER

Basant Kumar
21/5/18
VICE-CHAIRMAN

VISAKHAPATNAM URBAN DEVELOPMENT AUTHORITY

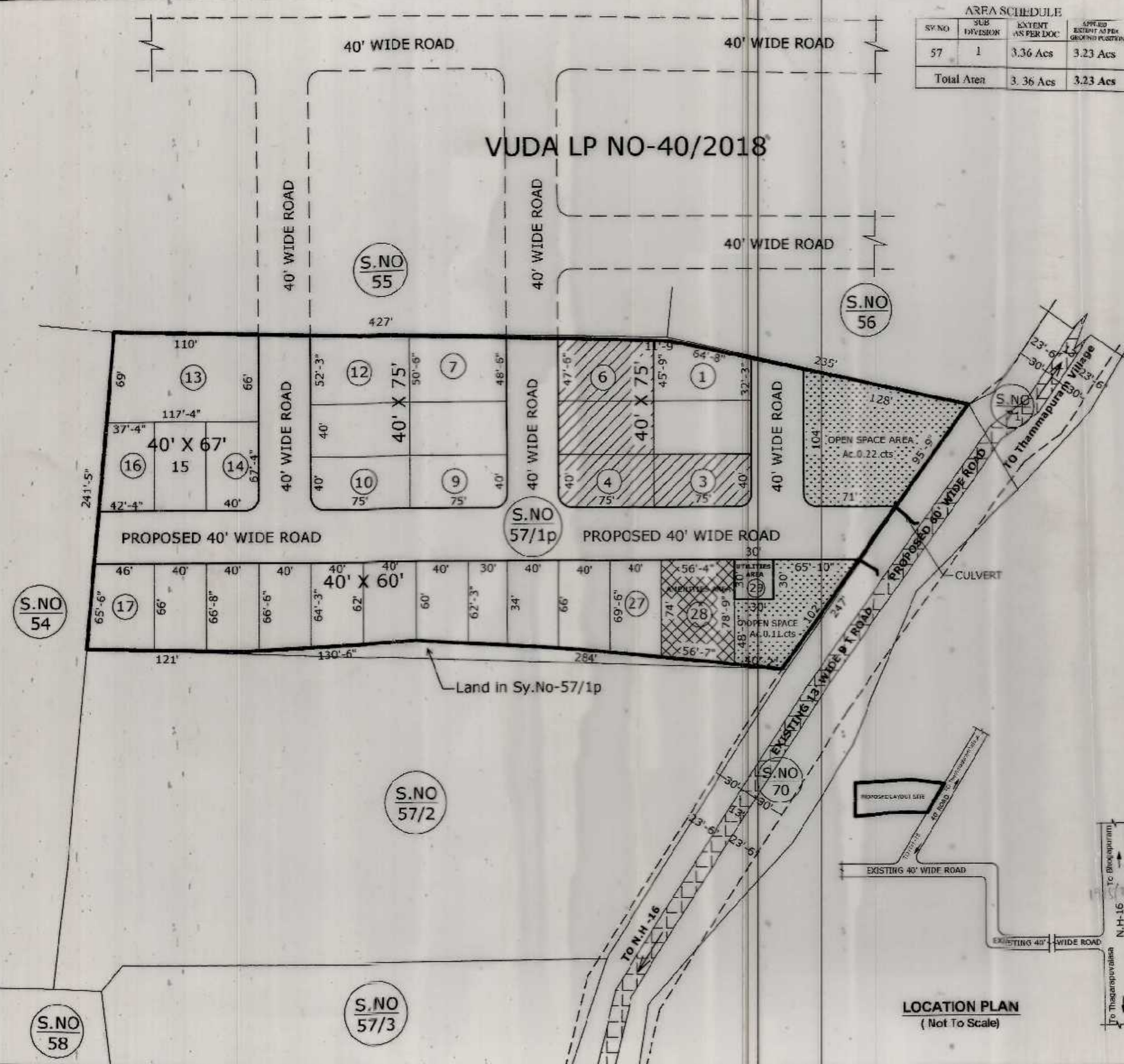

LOCATION PLAN
(Not To Scale)