

PROPOSED LAYOUT IN
S.NO. 383/1P,2 OF MADHURAVADA
VILLAGE, VISAKHAPATNAM
RURAL MANDAL BELONGS TO
JOURNALISTS.

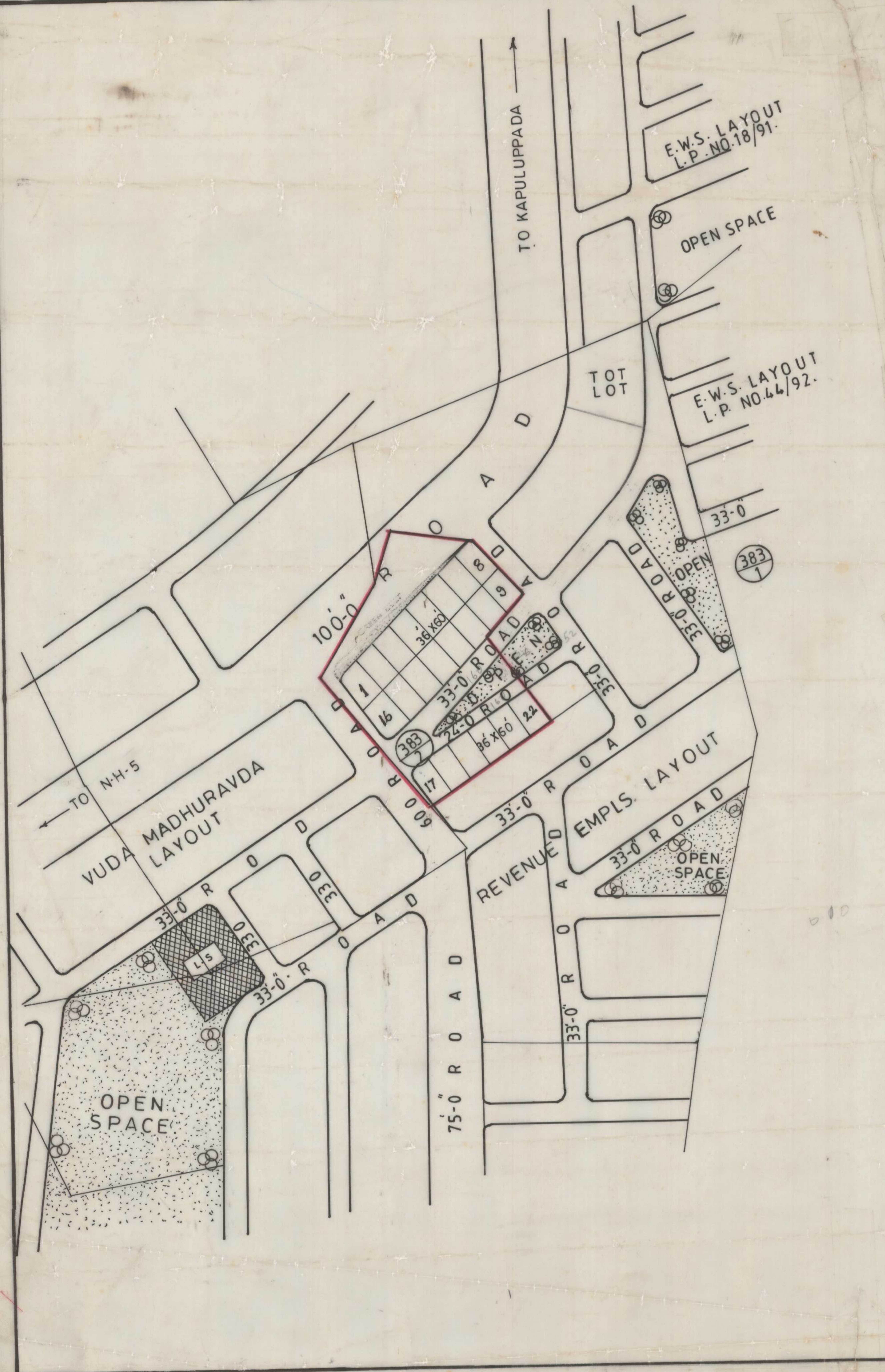
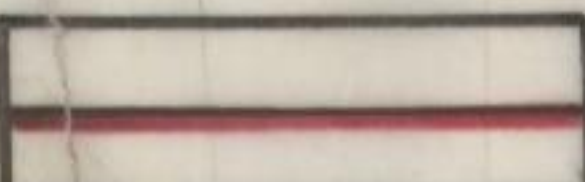

LAND USE ANALYSIS

SL. NO.	DESCRIPTION	EXTENT AC-CT	PERCETAGE
1	PLOTTED AREA	1.10	59.46
2	ROADS AREA	0.65	35.13
3	OPEN SPACE AREA	0.10	5.41
TOTAL EXTENT OF LAYOUT		1.85	100.00

 LAYOUT BOUNDARY

SL. NO.	SIZE OF PLOTS	NO. OF PLOTS
1	36'-0" X 60'-0"	22
TOTAL NO. OF PLOTS		22

SCALE : 1=132'-0"
FILE: RC. NO. 1386/94/G4
VUDA. R-NO. 695. DT. 26-9-94
L. P. NO. 11/98

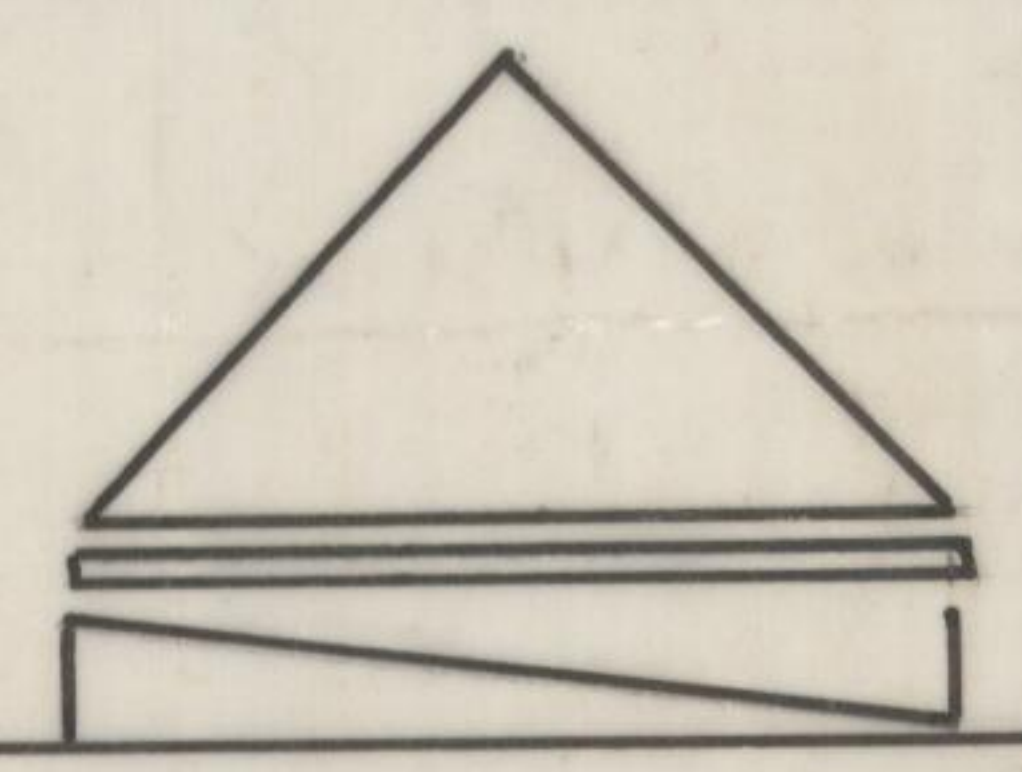

Ch. Rama nath
A.D.M. 3-1-98

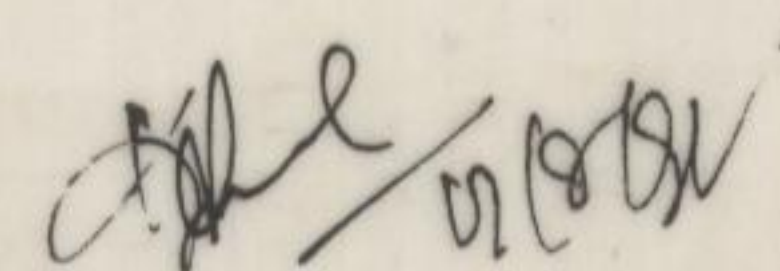
CHIEF PLANNING OFFICER

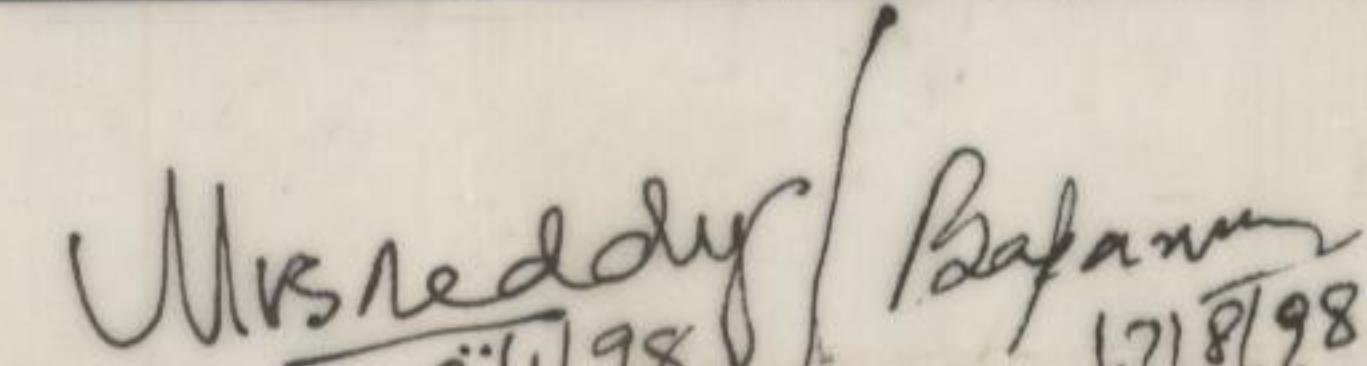
JUNIOR PLANNING OFFICER

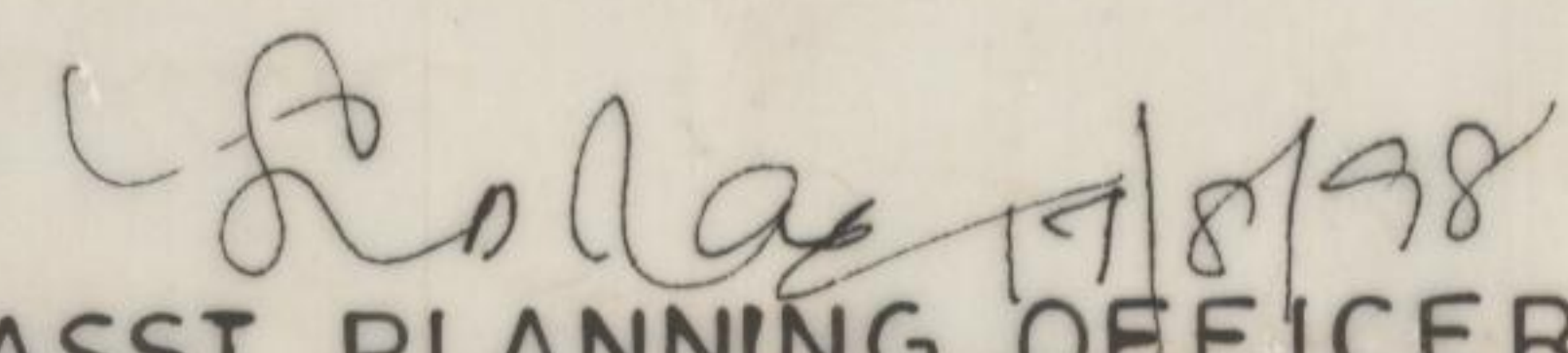
ASST. PLANNING OFFICER

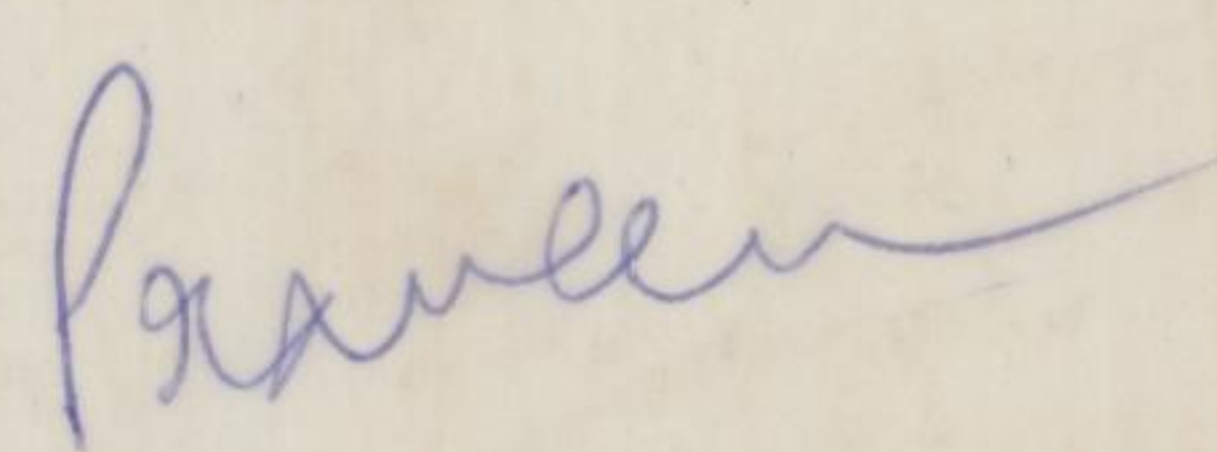
VICE-CHAIRMAN

VISAKHAPATNAM URBAN
DEVELOPMENT AUTHORITY