

SWATHI LAYOUT

S.NO/ Sub Divi.	Applied Extent in Ac-Cts
79/3	0.05
79/12P	0.08
84/1P	0.62
84/5	0.45
84/6	0.18
84/7	1.48
85/5P	0.11
85/6P	0.03
85/7	0.17
85/8	0.15
85/9P	0.14
85/10	0.10
85/11	0.10
85/12	0.22
85/13	0.23
85/14	0.22
85/15	0.20
85/16	0.18
85/17	0.45
85/18	0.48
86/1	0.11
86/2	0.16
86/3	0.08
86/4	0.09
86/5	0.15
86/6	0.06
86/7	0.24
86/8	0.25
86/9	0.23
86/10	1.05
86/11P	0.0275
86/12	0.14
86/13	0.08
86/14	0.12
86/15	0.06
86/16	0.06
86/17	0.27
86/18	0.31
86/19	0.13
86/20	0.13
86/21	0.24
TOTAL	9.6275

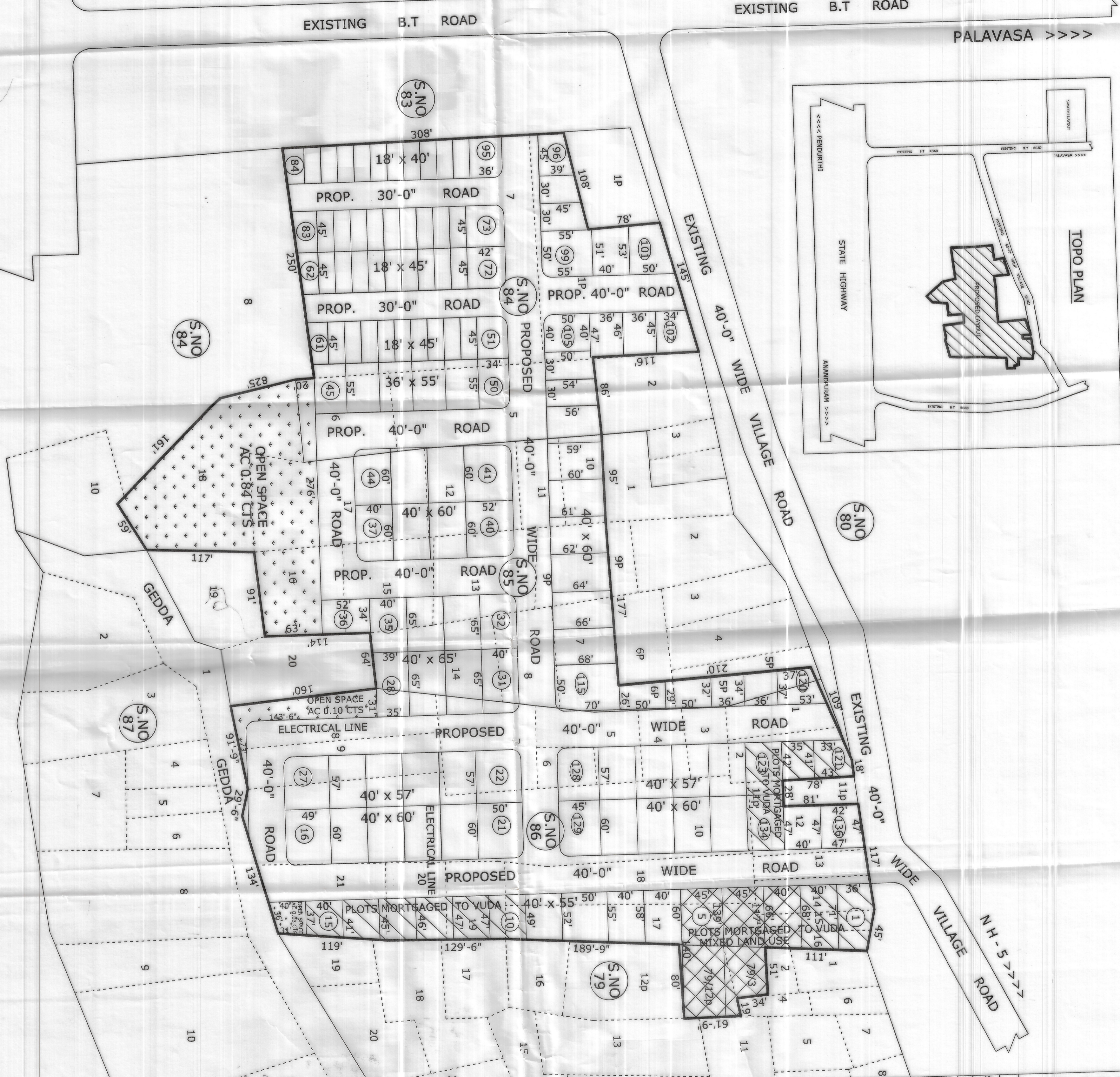
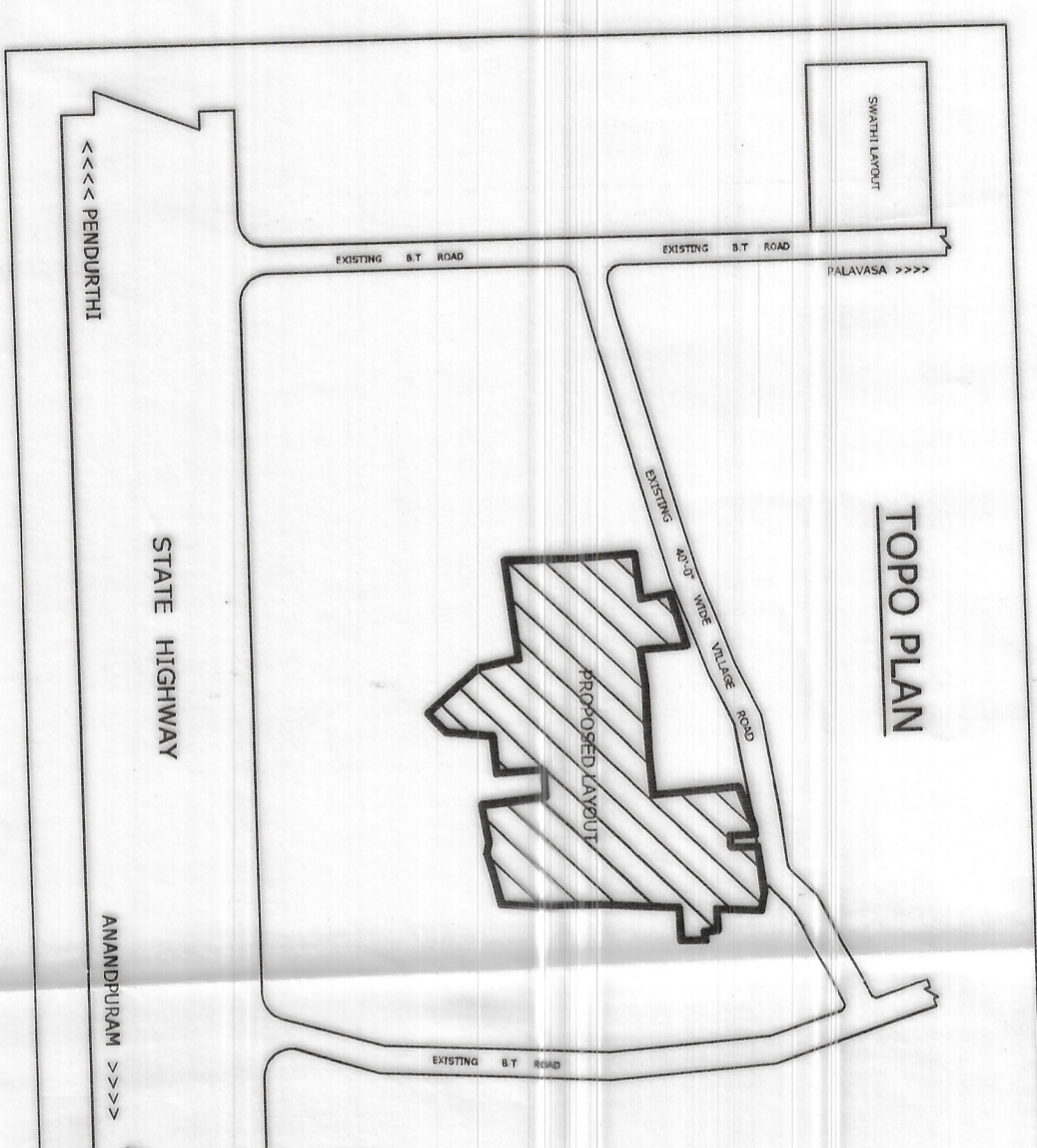

STATE HIGHWAY
ANANDPURAM >>>>
<<<< PENDURTHI

PROPOSED LAYOUT PLAN FOR RESIDENTIAL PLOTS AN EXTENT OF AC 9.6275 CTS IN S.Nos: 79P, 84P, 85P & 86P OF PALAVALASA VILLAGE, ANANDAPURAM MANDAL, VISAKHAPATNAM-DIST.

LAND BELONGS TO: P.V.RAMARAJU & OTHERS

LAND USE ANALYSIS :-

SL.NO.	DESCRIPTION	EXTENT in Ac-Cts	PERCENTAGE
1.	PLOTTED AREA	5.39	59.41 %
2.	MIXED LAND USE	0.33	30.52 %
3.	ROADS AREA	2.9375	10.07 %
4.	OPEN SPACE AREA	0.97	100.00 %
TOTAL AREA		9.6275	

PLOTS DETAILS :-

SL.NO.	PLOT SIZE	PLOT AREA IN Sq Yds	NO OF PLOTS
1	45' X 140'	700.00	01
2	45' X 117'	585.00	01
3	50' X 55'	305.55	01
4	40' X 65'	288.88	06
5	35' X 73'	283.88	01
6	40' X 60'	266.66	35
7	40' X 57'	253.33	13
8	40' X 55'	244.44	11
9	40' X 50'	222.22	02
10	36' X 55'	220.00	06
11	42' X 45'	210.00	02
12	34' X 45'	170.00	04
13	30' X 50'	160.00	04
14	36' X 40'	166.66	02
15	33' X 40'	146.66	02
16	26' X 50'	133.33	02
17	30' X 36'	120.00	03
18	18' X 45'	90.00	11
19	18' X 40'	80.00	30
TOTAL PLOT NOS.			136

SCALE:-
1" = 66'-0"

FILE R.C.NO: 11085 / 2015 / 16
L.P.NO: 169 / 2016

PLOTS MORTGAGED TO YUDA
PLOT NOS: 1 TO 5, 10 TO 15,
121 TO 123 & 134
TOTAL EXTENT: AC 0.88 CTS
TOTAL NO. OF PLOTS: 15

OWNERS SIGN.

LICENSED SURVEYOR

H. Lakshmi Narayan
Vida Licensed Civil Engineer
Region: Urban Development
VISAKHAPATNAM
No - 709314857

Asst. Planning Officer

20/09/2016

Chief Urban Planner

VICE CHAIRMAN

VISAKHAPATNAM URBAN DEVELOPMENT AUTHORITY