

SUGGESTIVE LAY-OUT FOR
S.NO. 94/2 TO 8 OF CHINAMUSHIDIVADA
FOR SRI. R.DEMUDU & OTHERS.

LAND-USE ANALYSIS

S.NO.	DESCRIPTION	EXTENT	%
1.	PLOTTED AREA	Ac - Ck 2 - 48	66.13
2.	ROADS AREA	0 - 89	23.73
3.	OPEN SPACE AREA	0 - 38	10.14
TOTAL		3 - 75	100.00

SIZE OF PLOT 40'0" x 60'0"
NO. OF PLOTS 46.
LAY-OUT BOUNDARY

(PLOT NO 46 FORTY SIX ONLY)

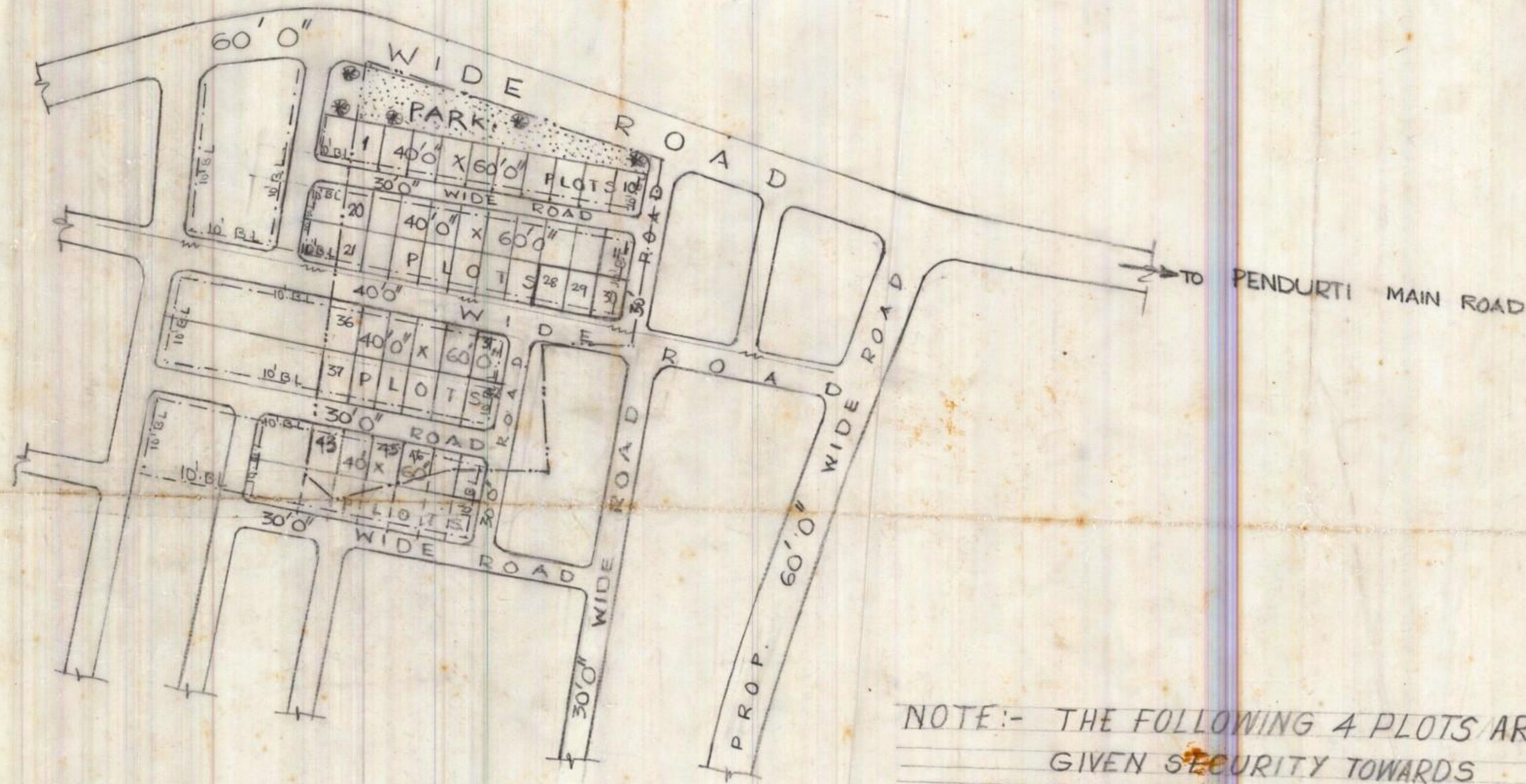

NOTE:- THE FOLLOWING 4 PLOTS ARE
GIVEN SECURITY TOWARDS
ELECTRIFICATION. PLOT NOS 28 TO 31



SCALE
1" = 132'

FILE No. 347/87-H2

L.P. NO 18/88
(BLP 6/87)

T.P.S.
16/3/88
T. P. S.

C.T.P & P.D. /c
16/3/88
C. T. P & P. D. /c

L.S. Mangam
16/3/88
JUNIOR PLANNING OFFICER

S. S. Sanyal
16/3/88
ASST. TOWN PLANNER

VICE-CHAIRMAN
VICE-CHAIRMAN

VISAKHAPATNAM URBAN
DEVELOPMENT AUTHORITY.