

HOUSING BOARD COLONY

EXISTING 60'-0" ROAD → TO H.B. COLONY
 → TO V.S. KRISHNA COLLEGE

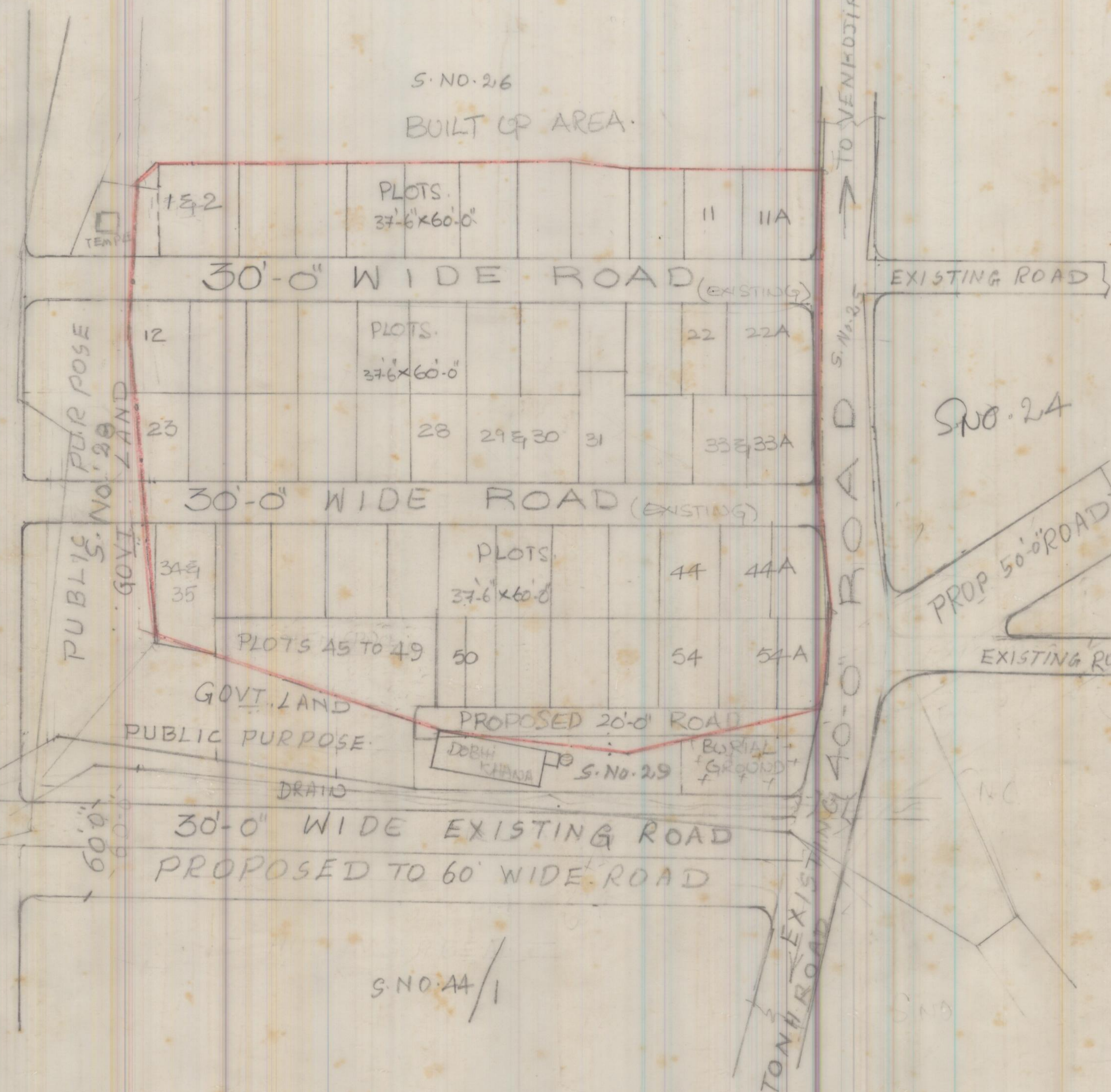

PROPOSED REGULARISATION OF LAY-OUT IN S. NO 27 OF MADDILAPALEM.

ANALYSIS

EXTENT OF LAY-OUT	= AC 3.63
PLOTTED AREA	= AC 2.86 = 79%
ROADS AREA	= AC 0.77 = 21%
OPEN SPACE	= AC NIL
TOTAL	= 3.63 = 100%

REFERENCE

- PROPOSED REGULARISED LAY-OUT BOUNDARY.
- PROPOSED ROADS.
- EXISTING ROADS.
- EXISTING PUCCA DRAIN.

NOTE: PLOT NOS. 45 TO 49 DO NOT HAVE ANY APPROACH. HENCE NO BUILDING PERMISSION.

L.P. NO. 18/92 SCALE 1"=66'
 FILE R.O. NO. 783/91, 63

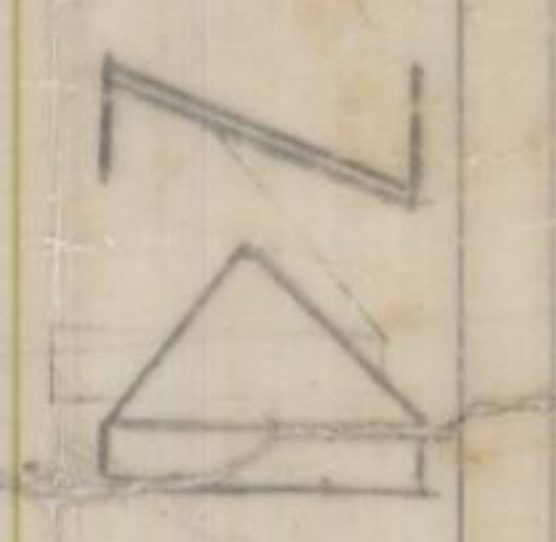

[Signature] 18/92
 SURVEYOR / D.M.A.

[Signature] 30/92
 CHIEF PLANNING OFFICER

[Signature] 28/92
 JUNIOR PLANNING OFFICER

[Signature]
 ASSISTANT PLANNING OFFICER

[Signature] 5/10/92
 VICE-CHAIRMAN

VISAKHAPATNAM URBAN DEVELOPMENT AUTHORITY