

GATEWAY



PROPOSED LAYOUT IN S.NO.1/P  
OF MADDILAPALEM BELONGS  
TO S.C.-EMPLOYEES CO-OPERA-  
TIVE HOUSE BUILDING SOCIETY  
& REG. NO.B-1696  
VISAKHAPATNAM

LAND USE ANALYSIS

SL.NO.	DESCRIPTION	EXTENT AC.CT	PERCENTAGE
1.	PLOTTED AREA	1.567	59.81
2.	ROADS AREA	0.651	24.85
3.	OPEN SPACE AREA	0.402	15.34
TOTAL EXTENT OF LAYOUT		2.620	100.00

— LAYOUT BOUNDARY

SL. NO.	SIZE OF PLOTS	NO OF PLOTS
1	30'-0" X 70'-0"	7 NOS
2	40'-0" X 60'-0"	6 NOS
3	30'-0" X 50'-0"	25 NOS
TOTAL NO OF PLOTS		38 NOS

SCALE: 1" = 33'-0"  
FILE: RC.NO. 1550/33GS  
L.P. NO. 19/93

*[Signature]*  
S/D MAN

*[Signature]*  
CHIEF PLANNING OFFICER

B. Vijayalakshmi  
28/9/93  
JUNIOR PLANNING OFFICER

*[Signature]*  
ASST PLANNING OFFICER

*[Signature]*  
VICE CHAIRMAN

VISAKHAPATNAM URBAN  
DEVELOPMENT AUTHORITY

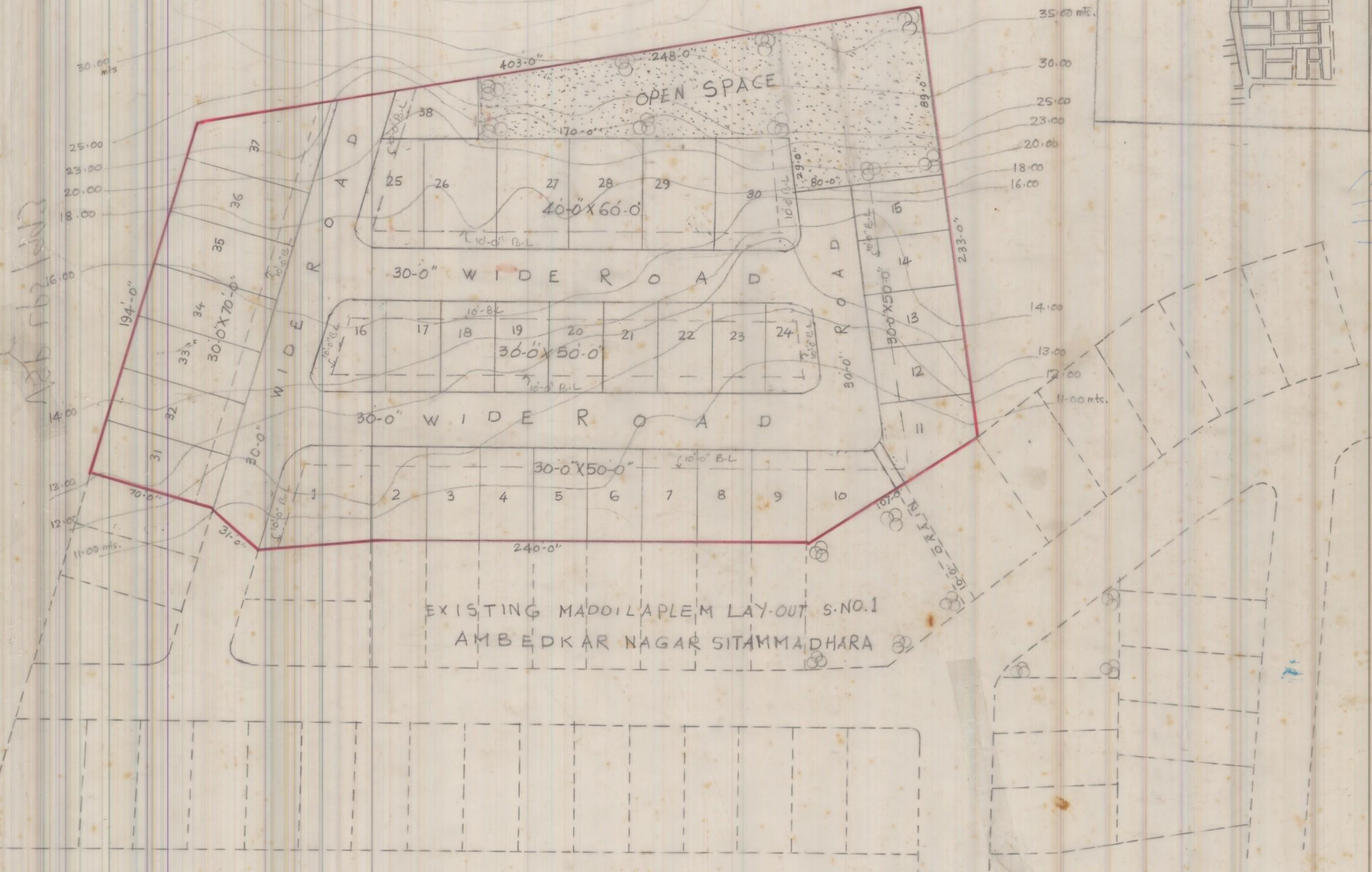

228 562 1003

228 562 1003

228 562 1003