

707

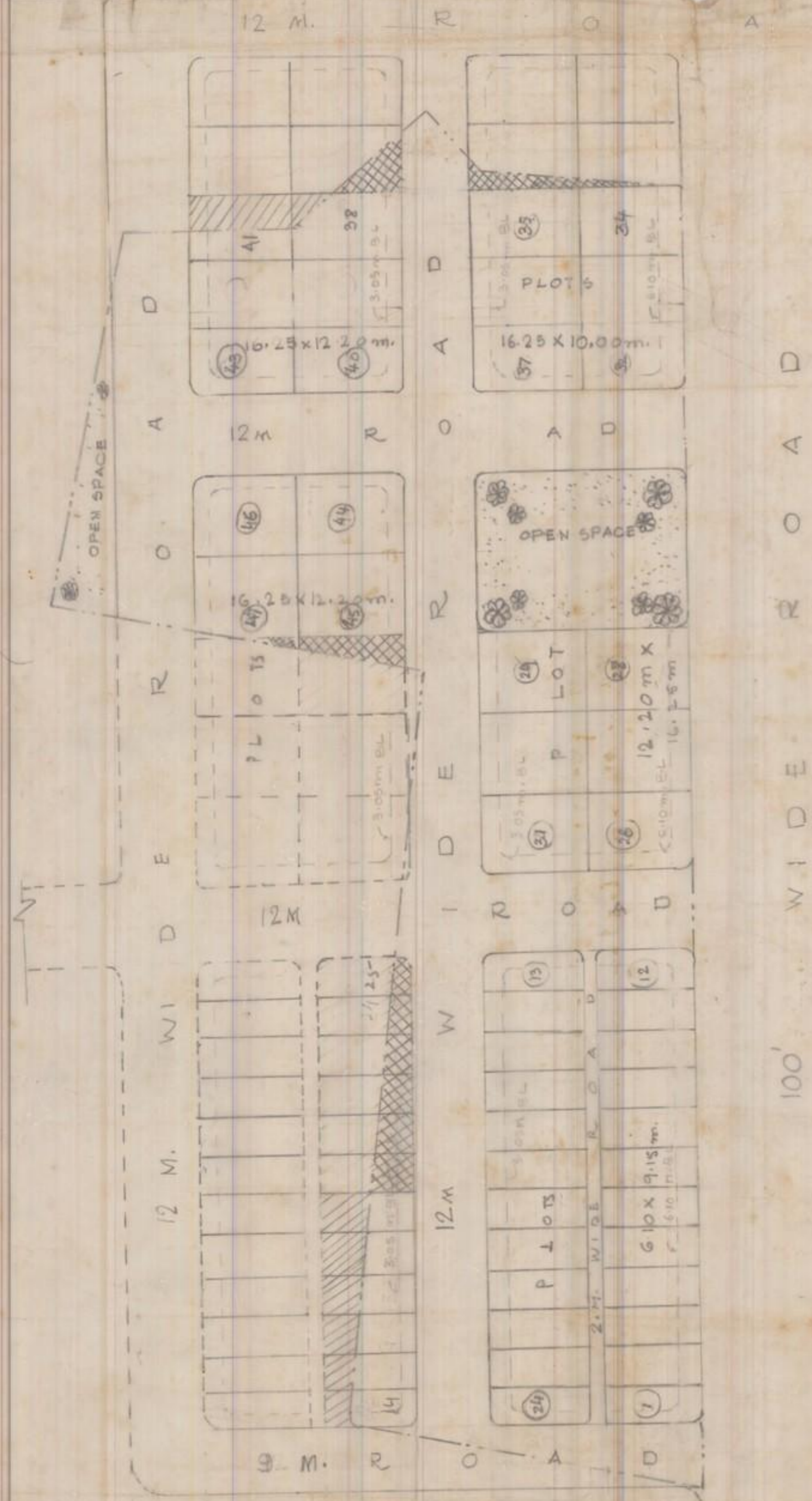

PROPOSED LAY-OUT FOR MINI INDUSTRIAL ESTATE IN S. NO: 79 AT I.D.A BLOCK 'D' VISAKHAPATNAM.

LAND USE ANALYSIS

PLOTTED AREA	AC.	1.60	52.98 %
ROADS AREA	AC.	1.09	36.10 %
OPENSAPCE AREA	AC.	0.33	10.92 %
TOTAL EXTENT	AC.	3.02	100.00

SCALE: 1:500



L. P. NO: 20/87
FILE RC. NO: 4408/86

LAND TO BE ACQUIRED TO CONSTITUTE FULL PLOTS
LAND TO BE DISPOSED TO THE OTHER PARTY.

SIZE OF THE PLOT: 16.25 x 12.20 M, 3, 6.10 x 9.15 M,
2, 12.20 x 6.25 M.

LAY-OUT BOUNDARY

TOTAL NO. OF PLOTS: 47 NOS.

V. Sankar
TPS 28/5/87

M. S. Lakshmi
20/6/87

M. S. Lakshmi
23.6.87
J.P.O

CHIEF TOWNPLANNER &
PROJECT DIRECTOR

V. Sankar
23/6/87
ASSISTANT TOWN PLANNER

V. Sankar
24/7/87
VICE CHAIRMAN
URBAN DEVELOPMENT AUTHORITY
VISAKHA PATNAM.

VISAKHAPATNAM URBAN DEVELOPMENT AUTHORITY