

PROPOSED LAY-OUT FOR SMTK RAMULAMMA & OTHERS IN S.NOS 46/P 48/P 49/P 56/P & 78/P OF CHINAMUSHIDIWADA (VILLAGE) PENDURTHI MANDAL VISAKHAPATNAM (DT)

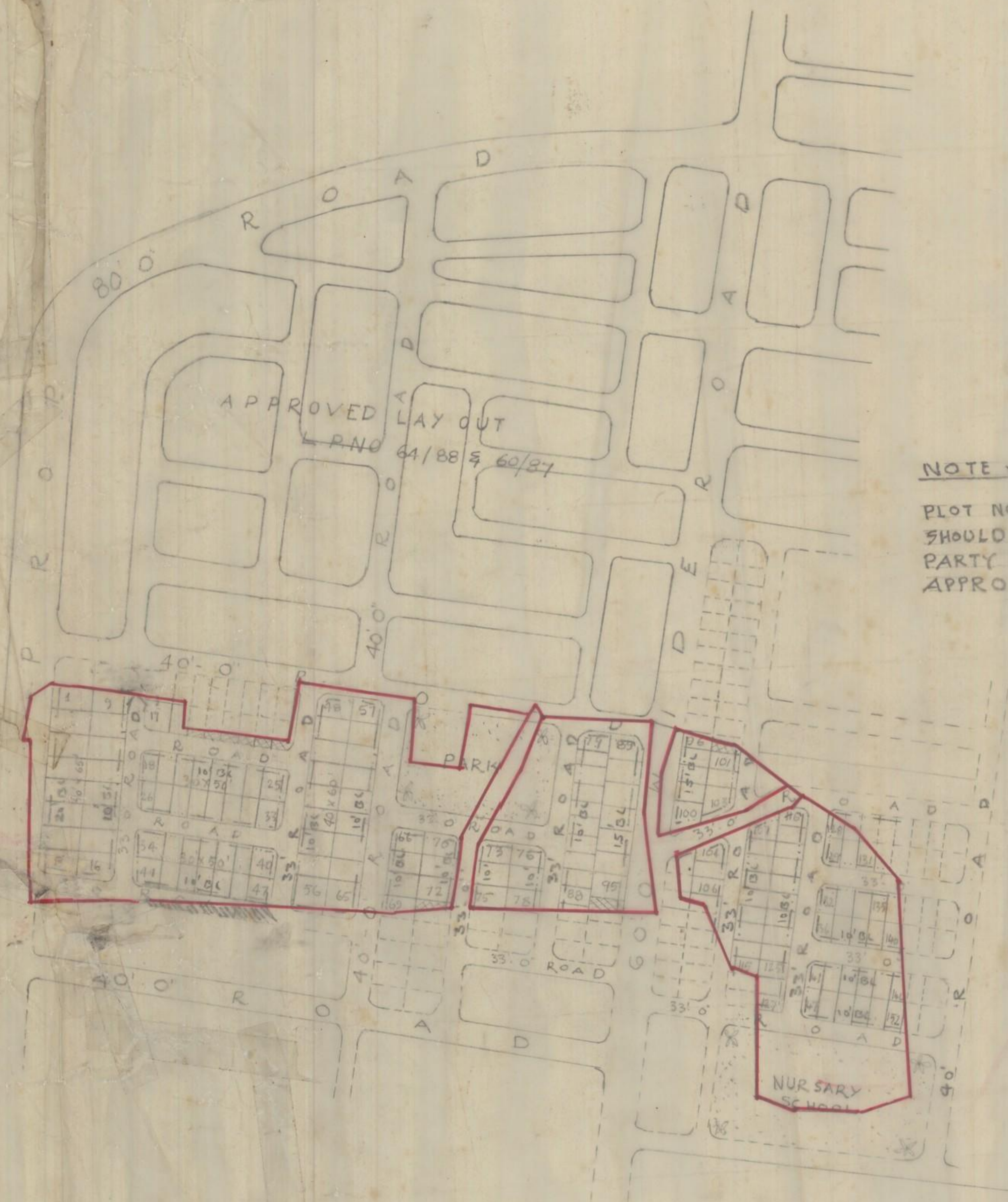

NOTE :-
PLOT NO. 43 TO 46 (FOUR PLOTS) SHOULD NOT BE DISPOSED BY THE PARTY TILL FORMATION OF THE APPROACH ROAD.

LAND USE ANALYSIS

SLNO	DESCRIPTION	EXTENT AC	PERCENTAGE
1	PLOTTED AREA	7.30	59.35
2	ROADS AREA	2.60	21.27
3	OPEN SPACE AREA	1.40	11.38
TOTAL		12.30	100.00

SIZE OF PLOTS	NO OF PLOTS
40'-0" X 65'-0"	16
40'-0" X 60'-0"	38
30'-0" X 50'-0"	98
TOTAL	152

— LAY OUT BOUNDARY

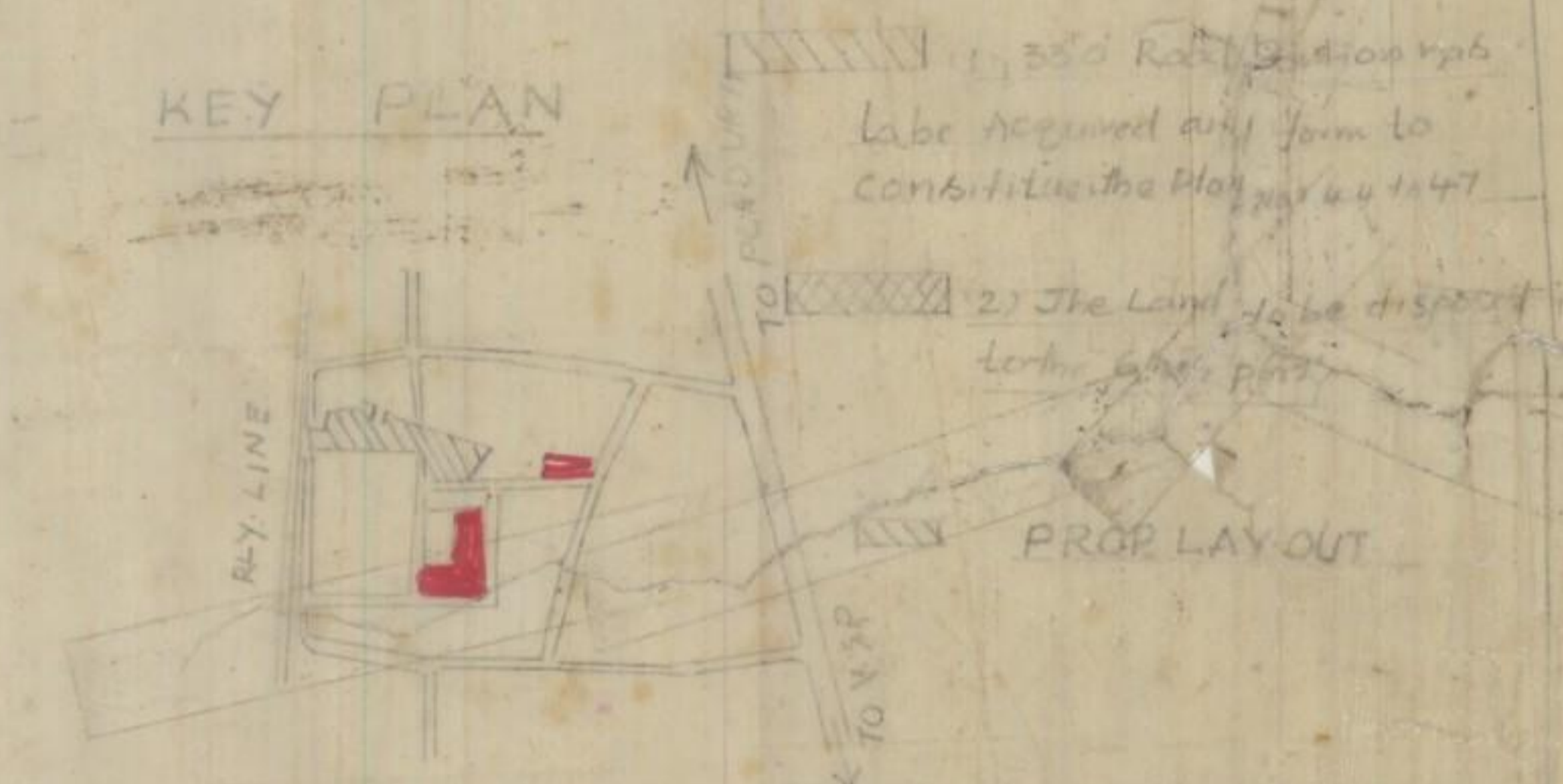

SCALE 1"=132'
FILE RCNO: 680/89 G3
L.P. NO. 22 / 91 (6/2/87)

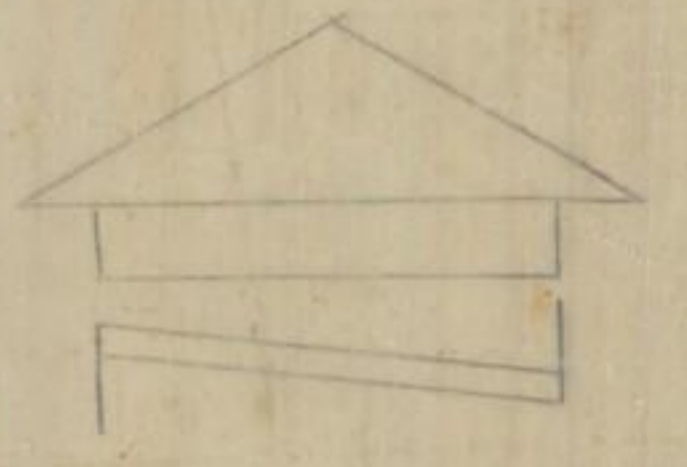

Ch. Ramulamma
A.D.M. 11-7-87

W. Prasad Rao
JUNIOR PLANNING OFFICER

...
ASST TOWN PLANNER

...
CHIEF TOWN PLANNER
PROJECT DIRECTOR /c

...
VICE CHAIRMAN

VISAKHAPATNAM URBAN DEVELOPMENT AUTHORITY

10/11/87