

**PROPOSED LAYOUT IN  
Sy.No : 379/p OF  
BHOGAPURAM VILLAGE,  
BHOGAPURAM MANDAL,  
VIZIANAGARAM DISTRICT.**

LAND BELONGS TO :-  
M/s SAMPADA AVENUES Pvt.Ltd.  
Sri. Y.JOJI REDDY, Director

LAND USE ANALYSIS :-

SL.NO.	DESCRIPTION	EXTENT IN Ac.-cts.	PERCENTAGE
1.	PLOTTED AREA 3% MIXED LAND USE AREA	2.22 0.07	59.79 %
2.	ROADS AREA	1.13	29.50 %
3.	OPEN SPACE	0.41	10.71 %
TOTAL AREA		3.83	100.00 %

PLOTS DETAIL :-

SL.NO.	PLOT SIZE	PLOT AREA IN Sq. yds.	PLOT Nos	NO. OF PLOTS
1.	30' x 60'	200.00	3 to 10	08
2.	36' x 67'	268.00	38 to 45	08
3.	36' x 60'	240.00	49 to 52	04
4.	33' x 58'	212.67	46 to 48	03
5.	30' x 50'	166.67	11 to 18	08
6.	20' x 40'	88.89	19 to 37	19
7.	90' x 130'	1300.00	1	01
8.	80' x 120'	1066.66	2	01
TOTAL NO OF PLOTS				52

— PROPOSED LAYOUT BOUNDARY  
 PLOTS MORTGAGED TO VUDA  
 PLOT NOS: 1 & 2  
 NO OF PLOTS: 2  
 Extent: Acs.0.42 cts.

**AREA STATEMENT**

Sy.No.	Adangal Extent Ac. cts.	Doc. Extent Ac. cts.	Applied Extent Ac. cts.
379/1	0.37	0.37	0.35
379/2	0.22	0.22	0.22
379/2A	0.06	0.06	0.06
379/3A	0.40	0.40	0.40
379/3B	0.08	0.08	0.08
379/4A	0.0975	0.0975	0.0975
379/4B	0.0625	0.0625	0.0625
379/5	0.28	0.28	0.28
379/6	0.19	0.19	0.17
379/12A	0.04	0.04	0.04
379/13A	0.05	0.05	0.05
379/14A	0.23	0.23	0.23
379/15	0.21	0.21	0.21
379/17	0.31	0.31	0.31
379/18	0.30	0.30	0.30
379/19	0.32	0.32	0.32
379/20B	0.21	0.21	0.21
379/21A	0.24	0.24	0.24
379/21B	0.20	0.20	0.20
Total Area			3.83

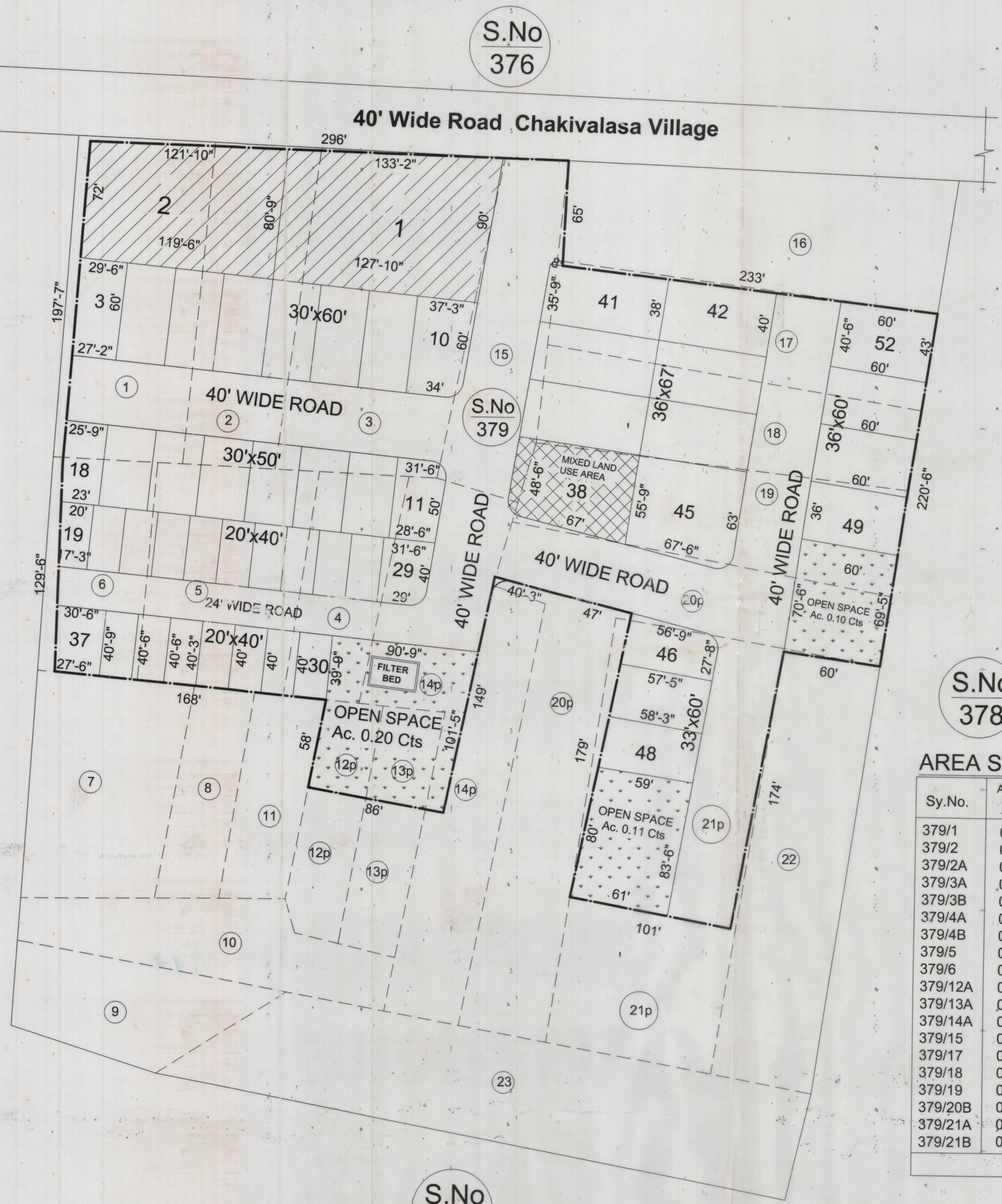

To Srikakulam  
N.H-16  
To Visakhapatnam

S.No  
380

S.No  
376

S.No  
379

S.No  
378

S.No  
382

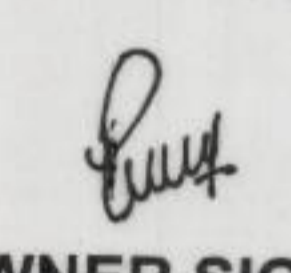
OWNER SIGNATURE:  V. Ravi Kumar  
 (V. RAVI KUMAR)  
 VUDA LICENCED SURVEYOR  
 Regd. No. 127/2015-16  
 VUDA Visakhapatnam  
 Mobile No. 9704408164  
 LICENSED SURVEYOR

SCALE :- 1" : 33'  
 FILE R.C.No :- 3996/2017/L8  
 L.P.No. :- 22/2018

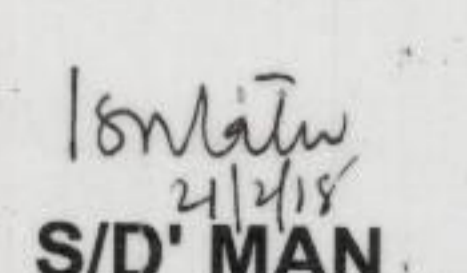
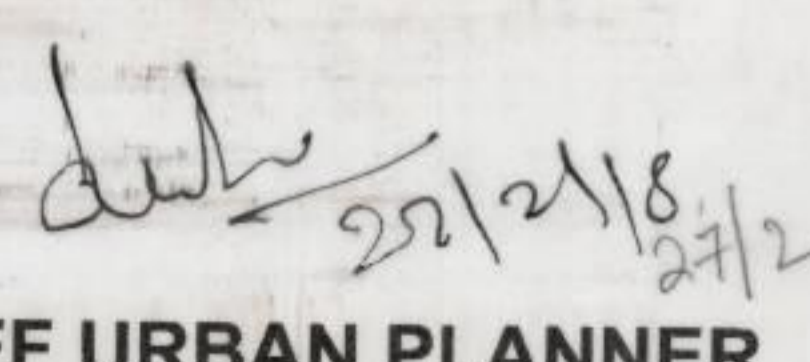
S/D MAN:  J.P.O. CHIEF URBAN PLANNER:  22/2/18

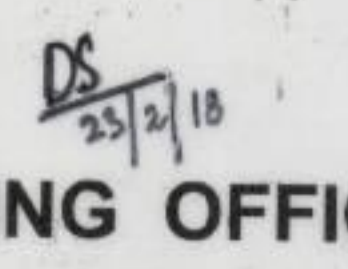
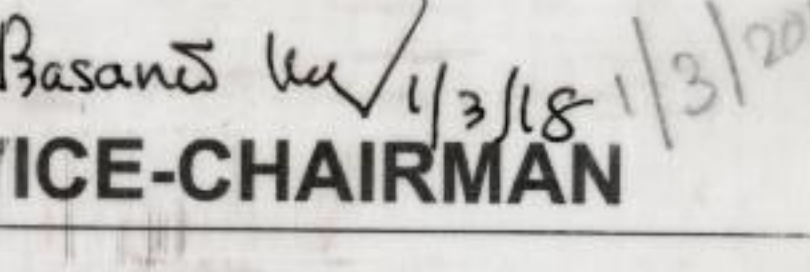
PLANNING OFFICER:  VICE-CHAIRMAN:  Basant Kumar 1/3/18

**VISAKHAPATNAM URBAN  
DEVELOPMENT AUTHORITY**