

PROPOSED LAYOUT IN TS.NO: 576 & 577 OF MAHARAJUPETA SOUTH WARD VIZIANAGARAM, VIZIANAGARAM MUNICIPALITY.

LAND USE ANALYSIS

PLOTTED AREA	AC. 0.95	59.37%
ROADS AREA	AC. 0.47	29.37%
OPEN SPACE AREA	AC. 0.18	11.26%
TOTAL EXTENT	AC. 1.60	100.00

SIZE OF THE PLOT (AVERAGE)	NOS.
30x70'	8
30x50'	14
TOTAL NO OF PLOTS:	22

SCALE: 1" = 66'

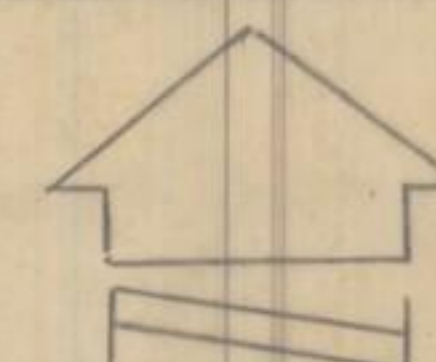

FILE RC NO: 232/1972
L.P.NO: 23/93
(OLP 11/93)

— LAYOUT BOUNDARY

▨ LAND TO BE ACQUIRED/ALIENATED TO CONSTITUTE FULL PLOTS.

KEY PLAN NOT TO SCALE

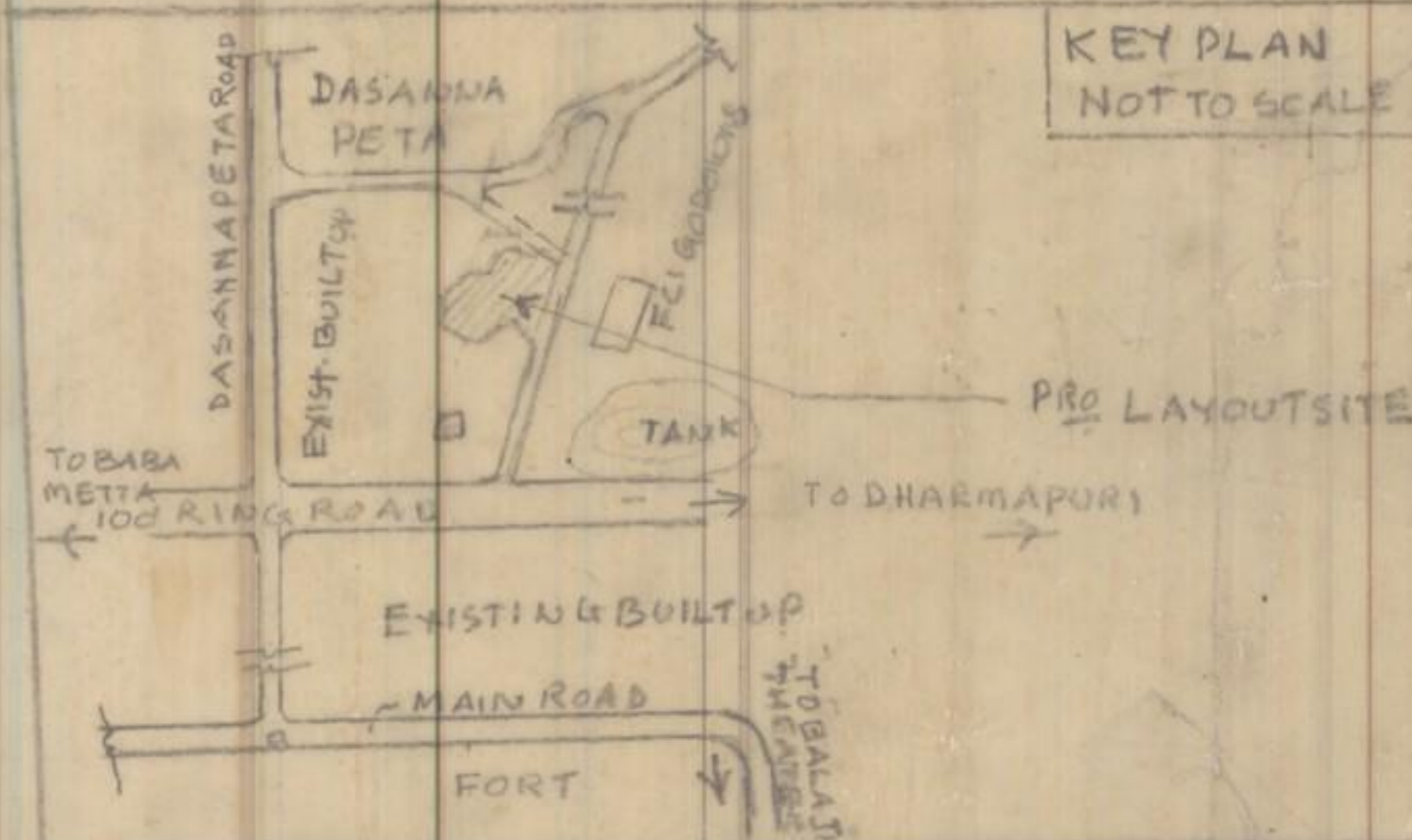

G. Sundar
T.P.S. 10/3/93

H. Chittoor
10/3/93
J.V. PLANNING OFFICER

M. Reddy
10/3/93
PLANNING OFFICER

K. Chandra
17/4/93
CHIEF PLANNING OFFICER

Rmg
22/4/93
VICE CHAIRMAN

VISAKHAPATNAM URBAN DEVELOPMENT AUTHORITY

