

LAND IN S.NO. 72/1
604'

LAND BELONGS TO VENDORS

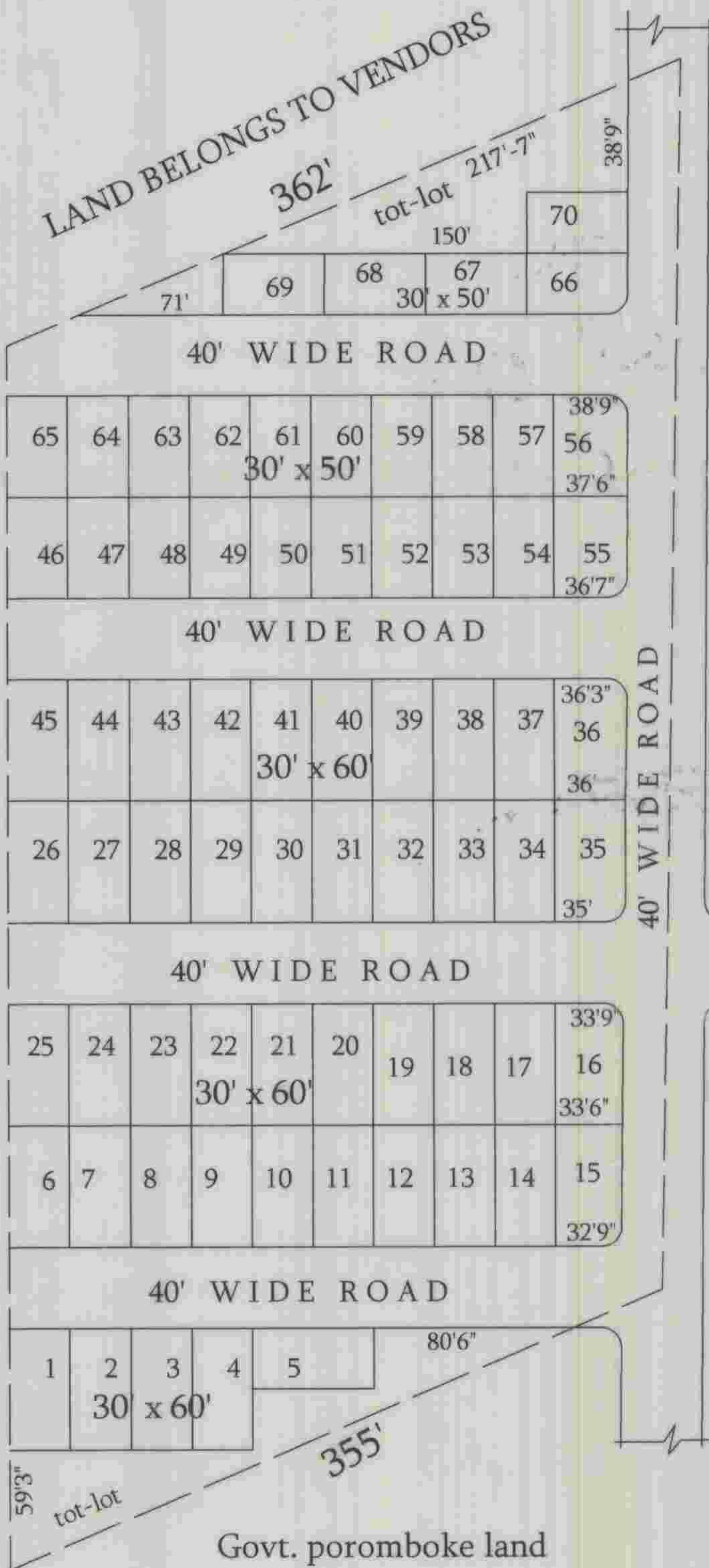

PROPOSED REGULARISATION OF LAYOUT
IN S.NO-72/2 OF PARADESIPALEM VILLAGE
CHINA GADILA MANDAL,
VISAKHAPATNAM DIST.
BELONGS TO " B.V.K.STAFF WELFARE ASSOCIATION"

LAND USE ANALYSIS :-

SL.NO.	DESCRIPTION	EXTENT Acres, -cts.	PERCENTAGE
1.	PLOTTED AREA	2-76	60.79 %
2.	ROADS AREA	1-42	31.28 %
3.	TOT-LOT AREA	0-36	7.93 %
TOTAL AREA		4-54	100.00 %

☐ LAYOUT BOUNDARY
TOTAL NO. OF PLOTS
IN THE LAYOUT] 70

Y. Ramiah
PRESIDENT
ABN Agents
SECRETARY
President
B.V.K. Staff Welfare Association
VISAKHAPATNAM
SIGNATURE OF THE OWNER

M. Seetha Rama Rao
LICENCED SURVEYOR
ORISE LICENSE NO
VUDA LICENSE NO 2 L/06/09
VISAKHAPATNAM
Cell 944038488
LICENCED SURVEYOR

LOCATION PLAN

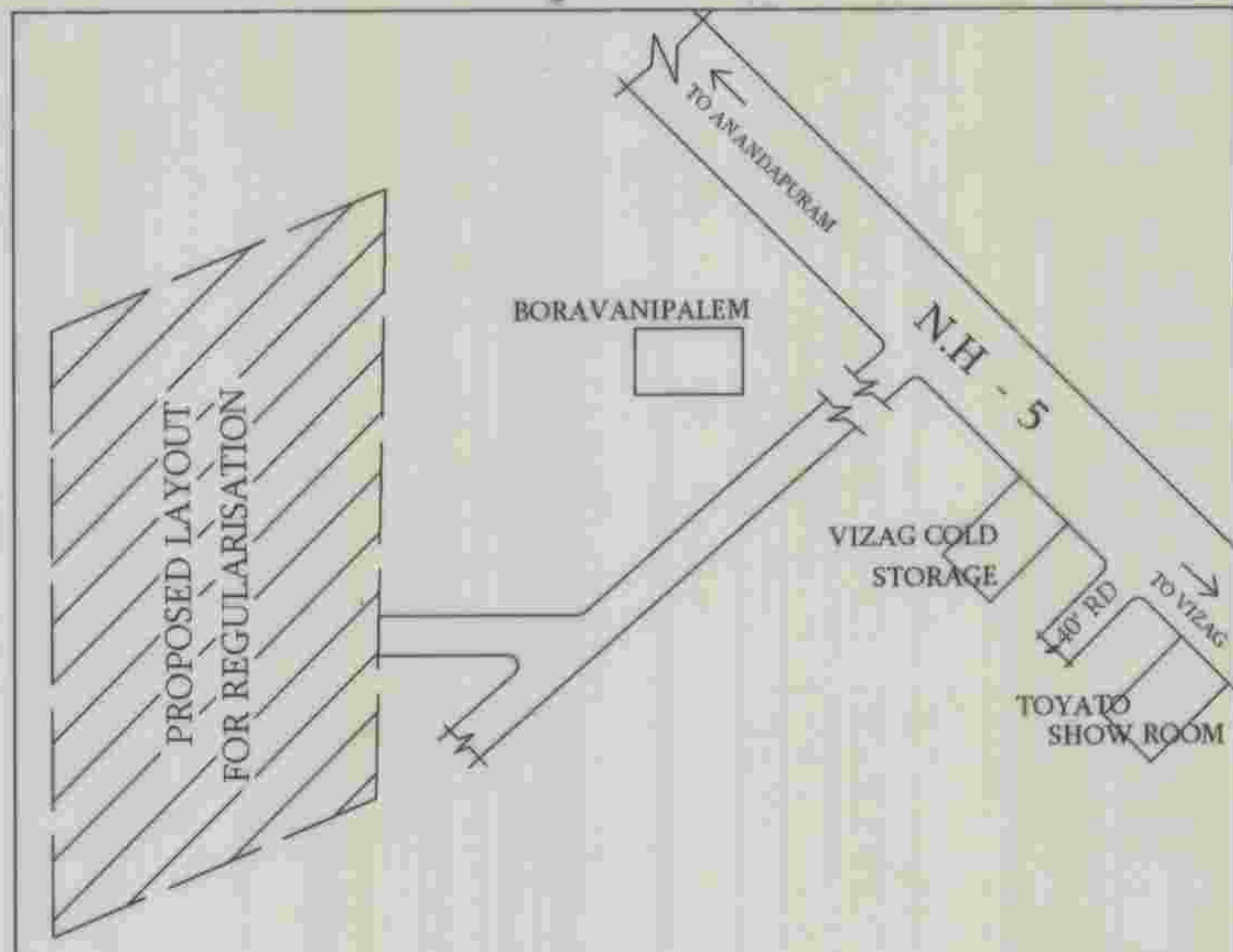

SCALE : 1"-66' FILE R.C. NO- 4670/08/L5
LPNO- 25/2009

28/5/09
A.D.M.
29/5/09
ASST. PLANNING OFFICER C-II

28/5/09
JUNIOR PLANNING OFFICER
20/5
CHIEF URBAN PLANNERS

28/5/09
ASST. PLANNING OFFICER
15/5/09
VICE CHAIR MAN

VISAKHAPATNAM URBAN
DEVELOPMENT AUTHORITY