

LAYOUT PLAN IN Sy.Nos. 4/P, 69/P OF GANTLAM VILLAGE AND 59/P OF D.TALLAVALASA VILLAGE, DENKADA MANDAL, VIZIANAGARAM DISTRICT. BELONGS TO M/s. SUVARNABHOOMI DEVELOPERS PVT. LTD.

TOTAL SITE AREA : Ac. 13.27

LAND USE ANALYSIS:

S.No.	DESCRIPTION	EXTENT (Ac.-Cts.)	PERCENTAGE
1.	PLOTTED AREA (10% EWS plots)	6.691	50.422
2.	AMENITIES (5.35% of platted area)	0.358	2.697
3.	OPEN SPACE AREA	1.355	10.211
4.	ROADS AREA	4.866	36.670
	TOTAL	13.270	100.000

PLOT DETAILS:

SL.NO.	PLOT SIZE	PLOT AREA (Sq.Yds.)	NO. OF PLOTS
1.	50'-0"X90'-0"	500.00	2
2.	55'-0"X66'-0"	403.33	4
3.	50'-0"X66'-0"	366.67	19
4.	50'-0"X45'-0"	250.00	4
5.	55'-0"X33'-0"	201.67	47
6.	55'-0"X36'-0"	220.00	12
7.	50'-0"X33'-0"	183.34	61
8.	30'-0"X25'-0"	83.33	21
9.	30'-0"X27'-0"	90.00	4
10.	45'-0"X18'-0"	90.00	16
TOTAL NO. OF PLOTS			181

REFERENCE:

- PROPOSED LAYOUT BOUNDARY
- EXISTING ROAD
- AMENITIES
- PLOTS MORTGAGED TO VUDA

PLOT NOS. 156 to 167, 170 to 181
TOTAL NO. OF PLOTS : 24
EXTENT : Ac.1.06 Cts.

FILE RC. NO.: 532/14/L8
L.P.NO.29/2014

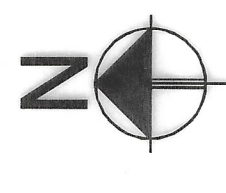

SCALE: 1"=66'-0"

1) D.Sridhar
2) MZ

A. Tulandley

TULANDLEY & ASSOCIATES
TULASI TECHNICAL CONSULTANTS
VUDA ROAD, VIZIANAGARAM
Dist: Vizianagaram
Cell: 9959000000

OWNER'S SIGNATURE

LICENSED ENGINEER

R. Bairavi
19/11/14
A.D.M.

PLANNING OFFICER i/c.

V. Narasimhan
19/11/14

JUNIOR PLANNING OFFICER

CHIEF URBAN PLANNER

ASST. PLANNING OFFICER

VICE CHAIRMAN

VISAKHAPATNAM URBAN DEVELOPMENT AUTHORITY

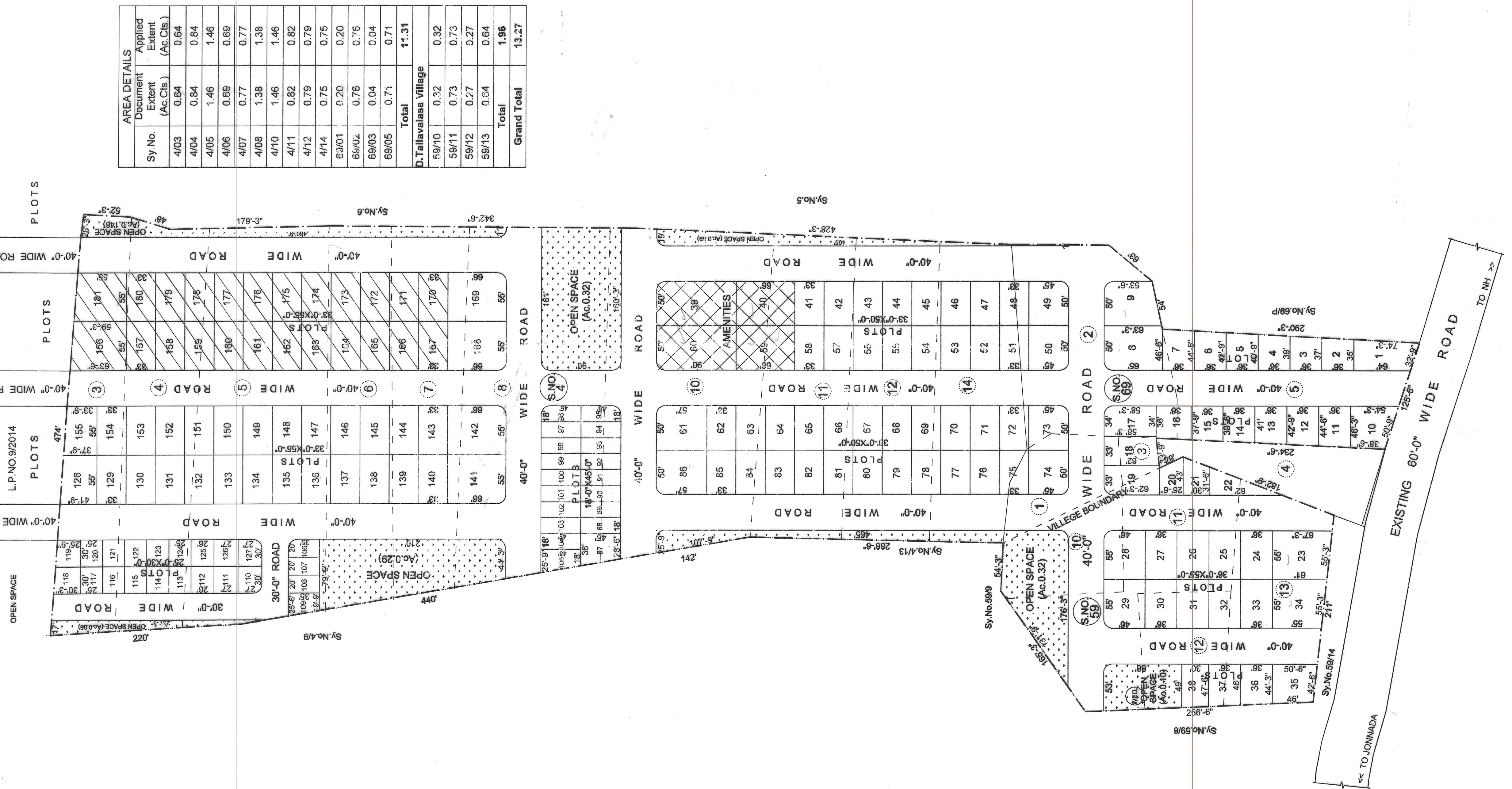

Sy. No.	AREA DETAILS	
	Document Extent (Ac.Cts.)	Applied Extent (Ac.Cts.)
4/03	0.64	0.64
4/04	0.84	0.84
4/05	1.46	1.46
4/06	0.69	0.69
4/07	0.77	0.77
4/08	1.38	1.38
4/10	1.46	1.46
4/11	0.82	0.82
4/12	0.79	0.79
4/14	0.75	0.75
69/01	0.20	0.20
69/02	0.76	0.76
69/03	0.04	0.04
69/05	0.71	0.71
Total	11.31	11.31

D. Tallavaiasa Village	
59/10	0.32
59/11	0.73
59/12	0.27
59/13	0.64
Total	1.96
Grand Total	13.27