

PROPOSED LAYOUT PLAN OF THE ANIMAL HUSBANDRY DEPARTMENT EMPLOYEES CO-OPERATIVE HOUSE BUILDING SOCIETY LTD., IN Sy.No. 133/ 4 & 7 OF CHINAGADILI VILLAGE, VISAKHAPATNAM RURAL MANDAL, VISAKHAPATNAM DISTRICT.

PART-1 EXTENT : Ac 05.20 Cts.
 PART-2 EXTENT : Ac 13.58 Cts.
 TOTAL EXTENT OF LAY-OUT: Ac 18.78 Cts.

LAND USE ANALYSIS :-

SL.NO.	DESCRIPTION	EXTENT IN Acs.-cts.	PERCENTAGE
1.	PLOTTED AREA	10.35	58.42 %
	AMENITIES AREA	0.62	
2.	ROADS AREA	05.89	31.36 %
3.	OPEN SPACE	01.92	10.22 %
TOTAL AREA		18.78	100.00%

PLOT DETAILS

SL.NO.	PLOT SIZE	EXTENT IN SQ.YDS.	NO.OF PLOTS
1.	40'X60'	266.67	68
2.	38'X63'	266.00	28
3.	30'X50'	166.67	101
4.	26'X36'	104.00	34
5.	24'X39'	104.00	27
6.	24'X38'-6"	102.67	34
TOTAL			292

- PROPOSED LAYOUT BOUNDARY
- PROPOSED AMENITIES AREA OF Ac. 0.62 Cts.
- PLOTS MORTGAGED TO V.U.D.A
 PLOTS Nos: 1-10, 33-42, 68-70 & 210 - 221 (Total 35 Plots)
 EXTENT Ac.1.70 Cts. OR 6879.65 Sq.Mts.

OWNER SIGNATURE: *[Signature]*
 Sd/- *[Signature]*
 VUDA Licensed Surveyor
 Regd. No. 222/2017-20
 11-70, Muralidhar, Visakhapatnam
 LICENCED SURVEYOR

SCALE : 1 : 132'
 FILE R.C.NO : 5354 / 2009 / L4
 L.P. No : 29/2018

SK. *[Signature]*
 23/03/2018
 S/D/MAN

[Signature]
 24/3/18
 ASST. PLANNING OFFICER

[Signature]
 29/3/18
 PLANNING OFFICER

[Signature]
 29/3/18
 CHIEF URBAN PLANNER

[Signature]
 29/3/18
 VICE-CHAIRMAN

VISAKHAPATNAM URBAN DEVELOPMENT AUTHORITY

NOTE - THE PLOT NOS 1 TO 10, 33 TO 42, 68 TO 70, 210 TO 221 (35 PLOTS) WHICH ARE UNDER MORTGAGE TO VUDA, VIDE REGISTERED AGREEMENT & DEED OF MORTGAGE NO 2044/2018 DT 31/3/2018 ARE HEREBY RELEASED VMRDA, VIDE REGISTERED DEED OF RECONVEYANCE OF MORTGAGE NO 4440/2019 DT 14/06/2019 VIDE ORDERS OF THE METRO POLITAN COMMISSIONER DT 10/6/2019 NOTE 217 VIDE RCNO 5354/09/L4.

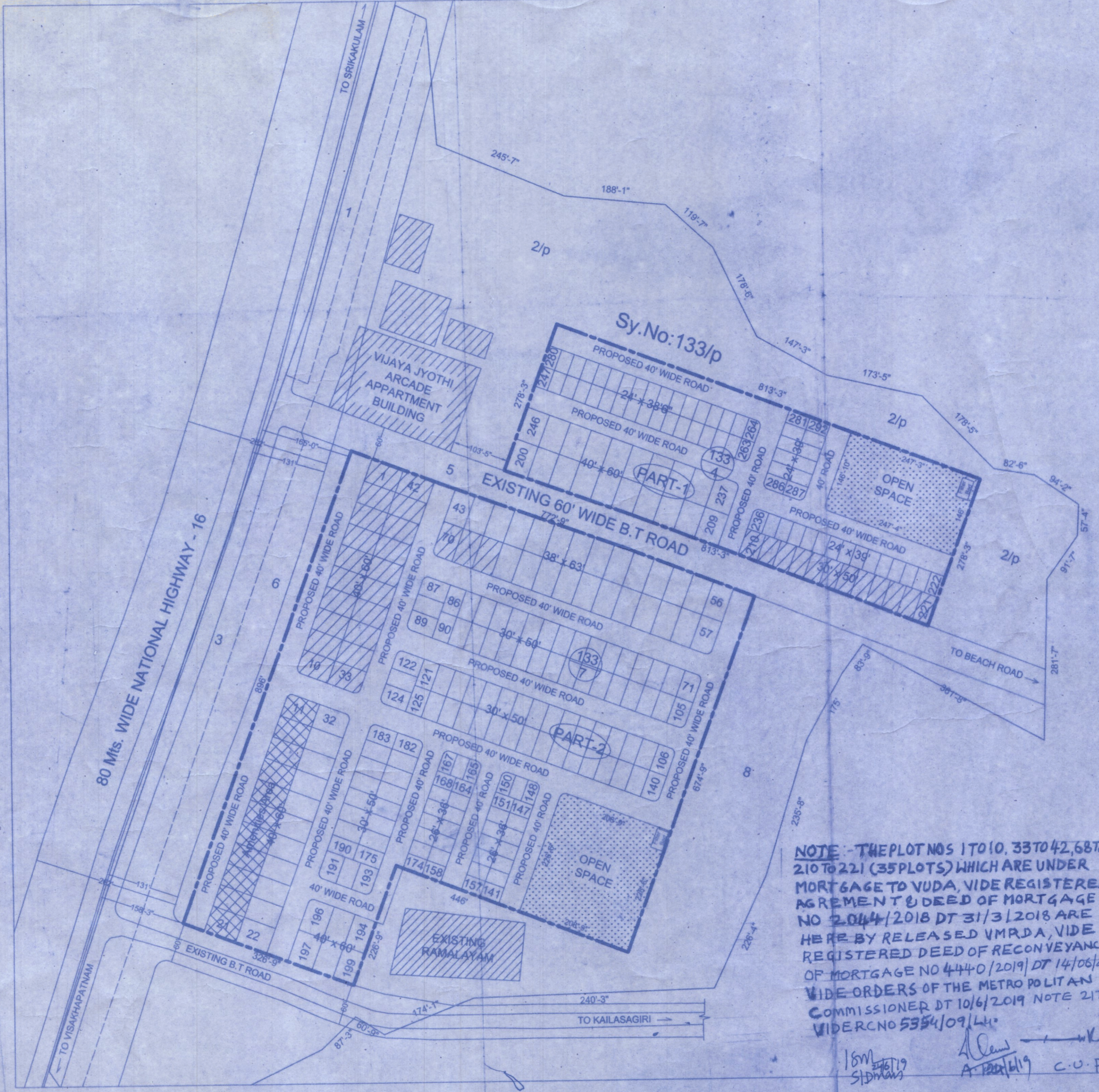

[Signature] 18/3/19
[Signature] 24/3/18
 S/D/MAN C.U.P 24/6