

REVISED LAY OUT PLAN OF SIMH-ADRI NAGAR IN S.NO. 124/P, 130/P OF VIZIANAGARAM I ST. BIT (V), VIZIANAGARAM MUNICIPALITY BELONGS TO SRI K. SURYA RAO AND OTHERS.

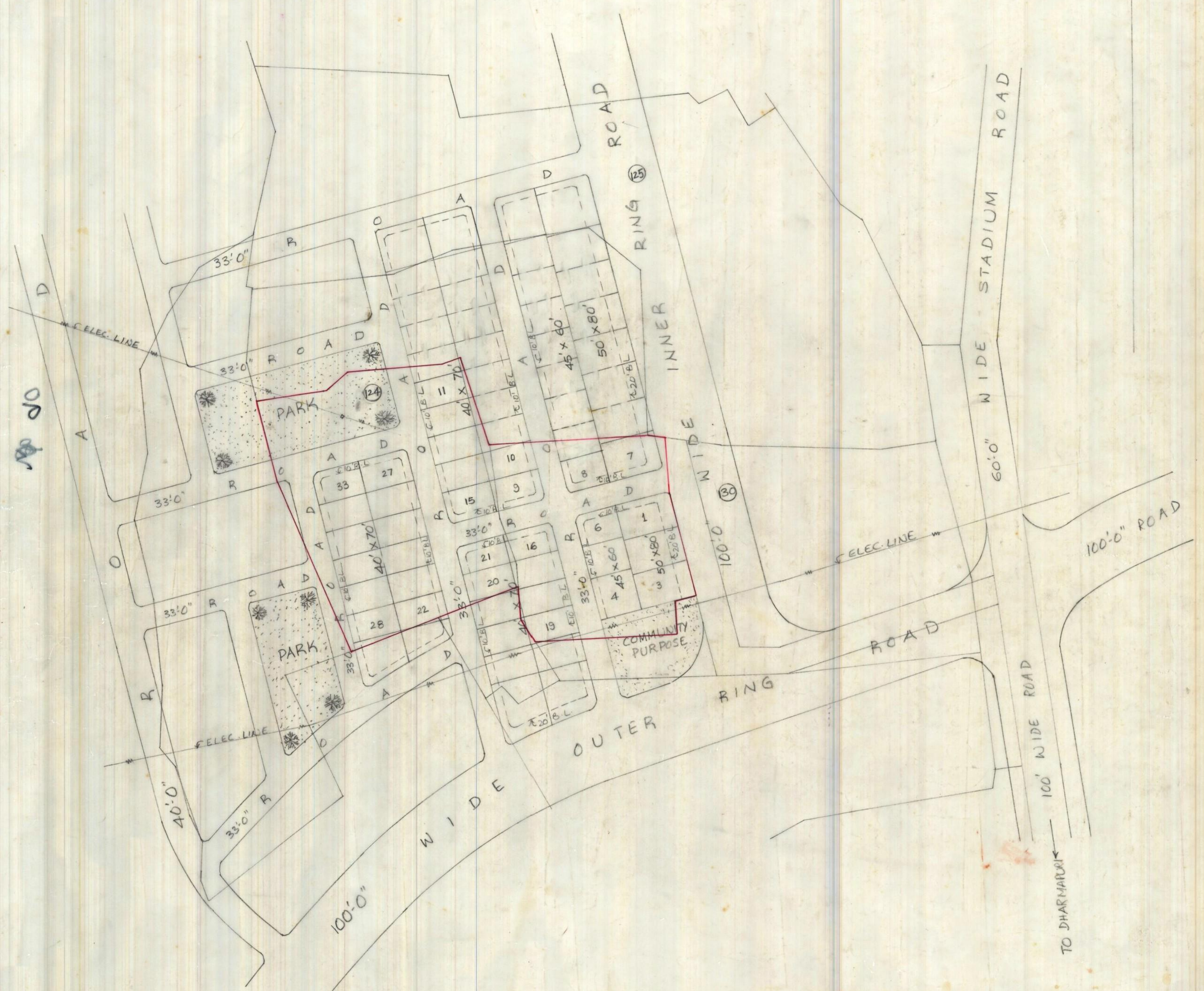

LAND-USE ANALYSIS

SL. NO.	DESCRIPTION	EXTENT AC CT	PERCENTAGE
1.	PLOTTED AREA	2-41	59.36
2.	ROADS AREA	1-20	29.56
3.	OPEN-SPACE AREA	0-45	11.08
TOTAL EXTENT OF LAY-OUT		4-06	100.00

— LAY-OUT BOUNDARY

SL. NO.	SIZE OF PLOTS	NO. OF PLOTS
1	50'-0" X 80'-0"	04
2	40'-0" X 70'-0"	25
3	45'-0" X 60'-0"	04
TOTAL NO. OF PLOTS		33

SCALE: 1" = 66'-0"
 FILE RC. NO. 2811/88 H,
 L.P. NO: 3/90
 (B.L.P. NO. 9/89)

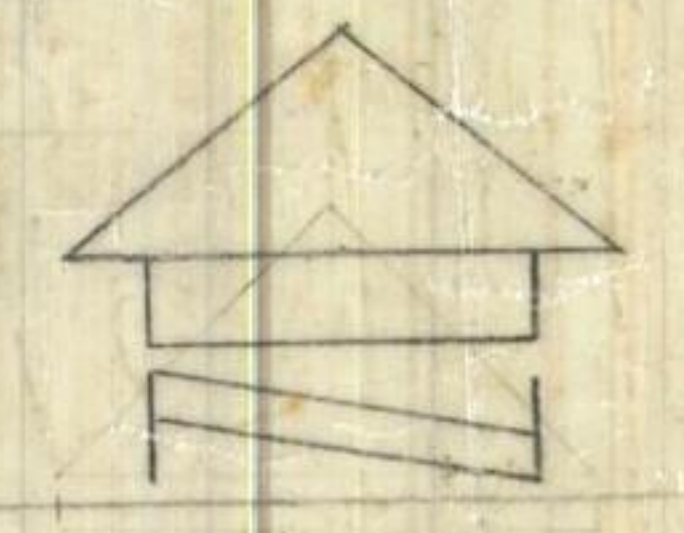

M. S. Jolly
 30.12.89
 SURVEYOR/D. MAN

[Signature]
 4/1/90
 CHIEF PLANNING OFFICER

JUNIOR PLANNING OFFICER

[Signature]
 30/12/89
 ASSISTANT PLANNING OFFICER

[Signature]
 VICE CHAIRMAN

VISAKHAPATNAM URBAN DEVELOPMENT AUTHORITY.