

REVISED LAYOUT OF SRI SITARAMA NAGAR IN S.NO.13/1P 14/2P AND 24/1 OF YENDADA VILLAGE VISAKHAPATNAM BELONGS TO Smt.C.H.BULLEMMMA AND SONS.

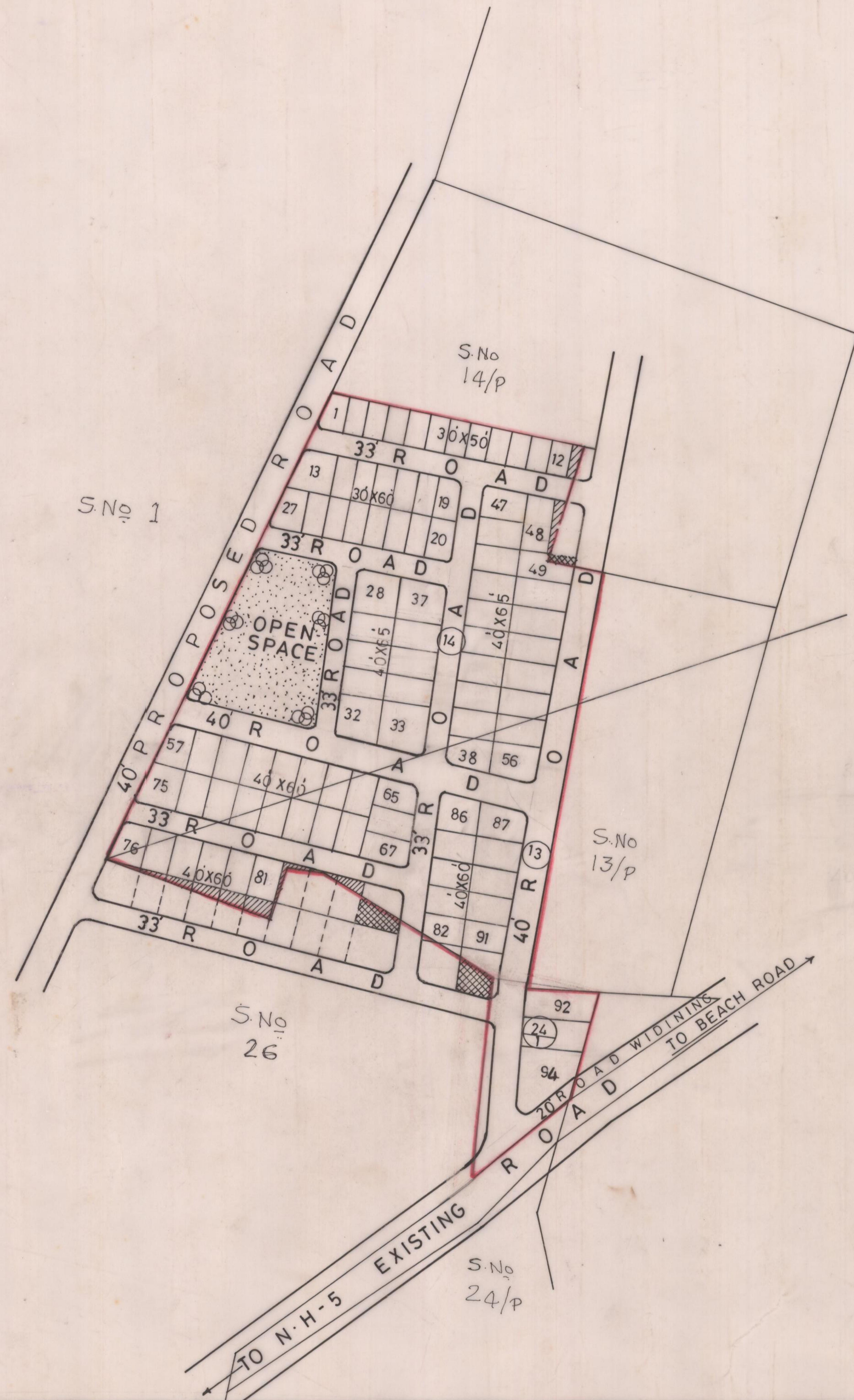

LAND USE ANALYSIS

S.L.NO.	DESCRIPTION	EXTENT AC-CT	PERCENTAGE
1	PLOTTED AREA	5.42	57.48
2	ROADS AREA	2.96	31.39
3	OPEN SPACE AREA	1.05	11.13
TOTAL EXTENT OF LAYOUT		9.43	100.00

LAYOUT BOUNDARY

SL.NO.	SIZE OF PLOTS	NO. OF PLOTS
1	30 X 50	12
2	30 X 60	15
3	40 X 60	35
4	40 X 65 / 80' AVE.	32

TOTAL NO OF PLOTS: 94

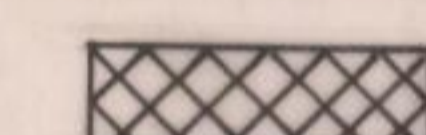
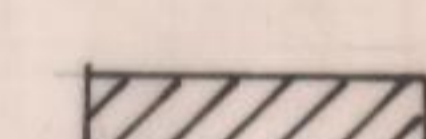
-  LAND TO BE ACQUIRED FROM NEIGHBOURS TO FORM FULL PLOTS
-  LAND TO BE DISPOSED TO THE ADJACENT LAND OWNER TO FORM FULL PLOTS

SCALE: 1"=132'-0"
 FILE: RC. NO. 2508/91/G4
 VUDA.R.NO.
 L.P. NO. 3/98 (BLP.NO.6/95)

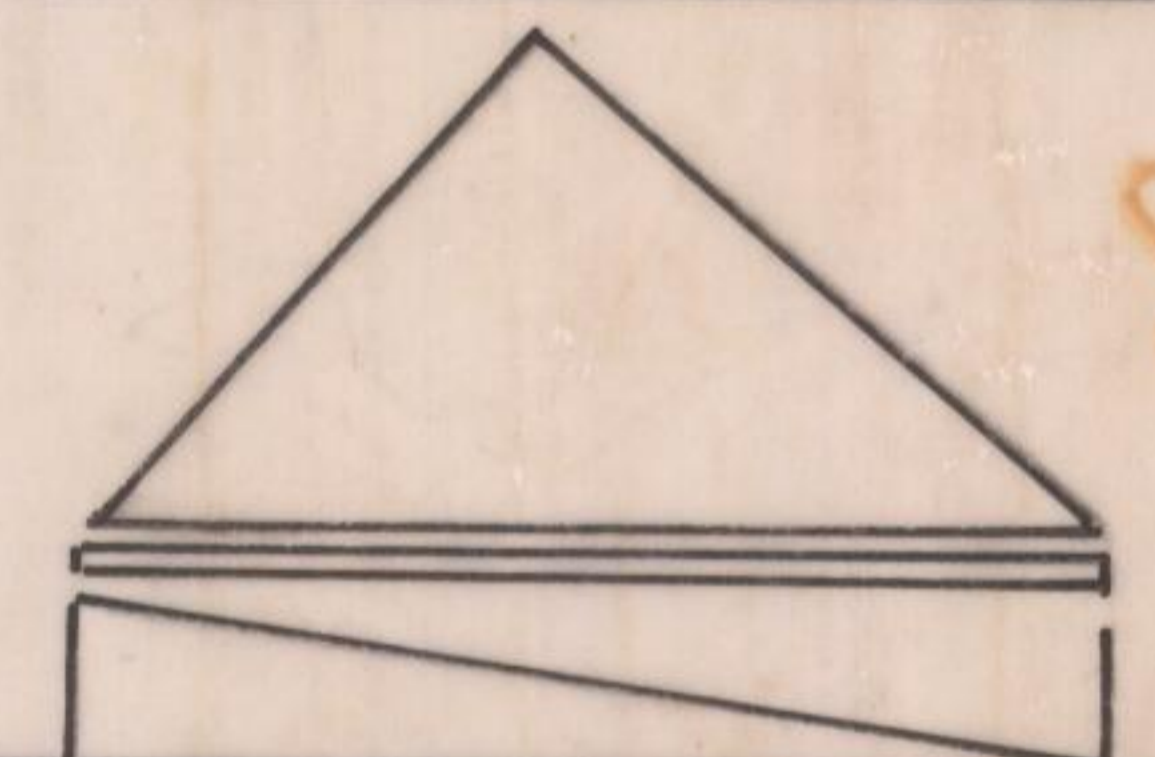

Ch. Ramanaiah
 A.D.M. 12.12.97

M/S Reddy
 12/12/97
 JUNIOR PLANNING OFFICER

CHIEF PLANNING OFFICER

ASST PLANNING OFFICER

VICE CHAIRMAN

VISAKHAPATNAM URBAN DEVELOPMENT AUTHORITY