

REVISED LAY-OUT
 PLAN OF S.NO: 4/PART
 OF MAIDHURAWDA
 (VILLAGE)
 VISAKHAPATNAM DT.

BELONGS TO OWNER:
 SRI. SIVAKRISHNA & OTHERS

LAND USE ANALYSIS

S.NO.	DESCRIPTION	EXTENT	PERCENTAGE
1.	PLOTTED AREA	4.72	57.21%
2.	ROADS AREA	2.70	32.73%
3.	OPEN AREA	0.83	10.06%

TOTAL EXTENT 8.25 100.00%

NO	SIZE OF PLOTS	NO. OF PLOTS
1.	40'0" X 70'0"	49
2.	30'0" X 50'0"	44
TOTAL PLOTS		93

LAY-OUT BOUNDARY

SCALE : 1"=152'0"
 FILE NO: 3123/8894
 I.P. NO: 30/91
 (B.L.P. NO: 4/91)



Ch. Ramakrishna
 SURVEYOR/A.P.M.

CHIEF PLANNING OFFICER

B. Ramesh Babu
 JUNIOR PLANNING OFFICER

V. Prasad
 ASST. PLANNING OFFICER

VICE CHAIR MAN

VISAKHAPATNAM URBAN
 DEVELOPMENT AUTHORITY.

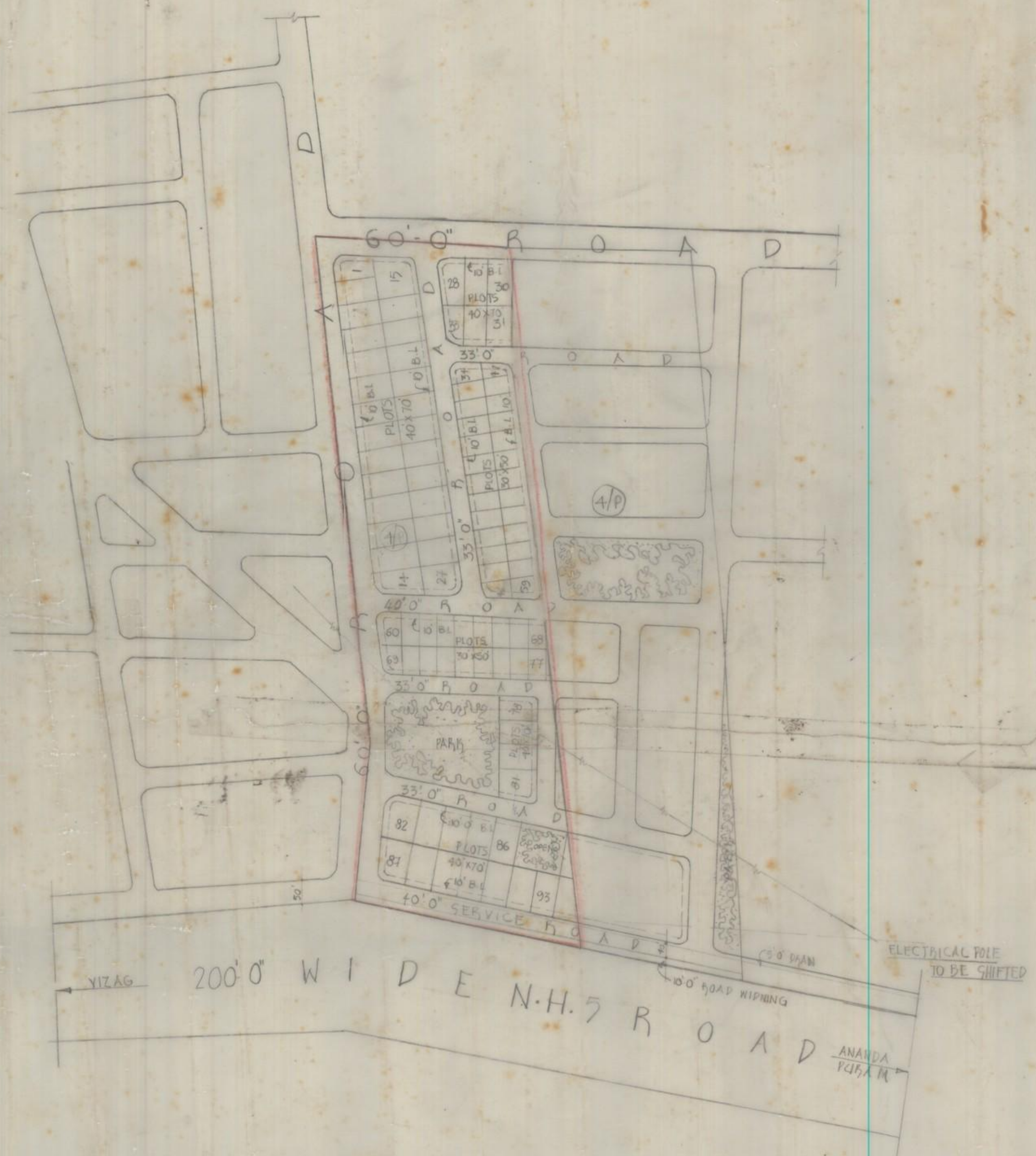

NOTE: OVER HEAD ELE. LINES ARE RUNNING THROUGH
 PLOT NO 79 TO 81 THE APPROVAL OF B.A WILL BE
 CONSIDERED ONLY AFTER OVER HEAD ELE LINES
 ARE SHIFTED BY THE LAYOUT OWNER.

REFERENCE
 ROAD TO BE FORMED BY BOTH PARTIES
 LAND TO BE HANDED OVER TO SIDE OWNERS
 TO BUILT THE REGULAR PLOTS