

TO VISAKHAPATNAM TO SREEKAKULAM

200'0" W I D E N . H . 5 R O A D

NOTE:- As per the order of the V.C. dt 30-6-15,
 THE PLOT NOS : 92, 117 TO 128 (13 PLOTS) WHICH ARE UNDER
 MORTGAGE TO VUDA, VIDE REGISTERED AGREEMENT &
 DEED OF MORTGAGE NO-2735/2012, DT-22-5-2012 ARE
 HERE BY RELEASED BY VUDA, VIDE REGISTERED DEED
 OF RE-CONVEYANCE OF MORTGAGE DEED NO-5252/2015,
 DT-3-7-2015.

(Signature)
 A.D.M
(Signature)
 P.O
(Signature)
 C.U.P

**PROPOSED LAY-OUT PLAN IN S.NOS.
 69/22 TO 42,70/2p AND 71/1 TO 9,20 TO 22
 OF ERUKONDA(V) PUSAPATIREGA (M)
 VIZIANAGARAM-DIST. BELONGS TO
 SRI.DR.K.V.RAVINDRANATH & SMT.CH.UMA.**

LANDUSE ANALYSIS :

SL.NO.	DESCRIPTION	EXTENT IN ACS.	PERCENTAGE
1.	PLOTTED AREA	ACS. 5.96	59.07 %
2.	LOCAL SHOPS AREA	ACS. 0.06	00.59 %
3.	ROADS AREA	ACS. 3.06	30.33 %
4.	OPEN SPACE AREA	ACS. 1.01	10.01 %
TOTAL EXTENT :		ACS. 10.09	100.00 %

SL.NO.	PLOT SIZES	EXTENT Sq.yds.	NO.OF PLOTS
1.	70' 0" X 85' 0"	661.11	02Nos.
2.	50' 0" X 85' 0"	472.22	16 Nos.
3.	40' 0" X 60' 0"	266.66	24 Nos.
4.	45' 0" X 60' 0"	300.00	14 Nos.
5.	36' 0" X 60' 0"	240.00	18 Nos.
6.	30' 0" X 50' 0" (L16)	166.66	07 Nos.
7.	18' 0" X 45' 0" (EWS)	90.00	09 Nos.
8.	18' 0" X 30' 0" (EWS)	60.00	38 Nos.
TOTAL NO.OF PLOTS :			128 Nos.

— — — — — PROP.LAY-OUT BOUNDARY
 PLOTS MORTGAGED TO V.U.D.A.
 PLOT NOS. From 92;117 to 128 (13 Nos).
 EXTENT : ACS.0.97 CENTS.

(Signature)
 OWNER SIGN.
 T. S. GOPAL
 Licenced Civil Engineer
 Regd. No. 281/10
 Urban Development Authority
 VISAKHAPATNAM
 Cell : 9959816766, 2523082 (R)
 LICENSED SURVEYOR.

SCALE : 1"= 66'-0" *This Revised LP No 30/2012*
LPNO-30/2012
 RC.NO : 22662/11/PLG/L8.

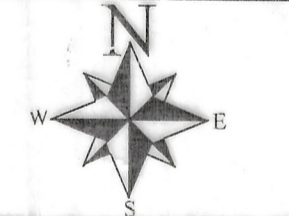

(Signature)
 25/4/12
 S/D'MAN.

(Signature)
 25/04/12
 ASST.PLANNING OFFICER.

(Signature)
 27/4/12
 PLANNING OFFICER.I/C

(Signature)
 VICE-CHAIRMAN.

**VISAKHAPATNAM URBAN
 DEVELOPMENT AUTHORITY.**

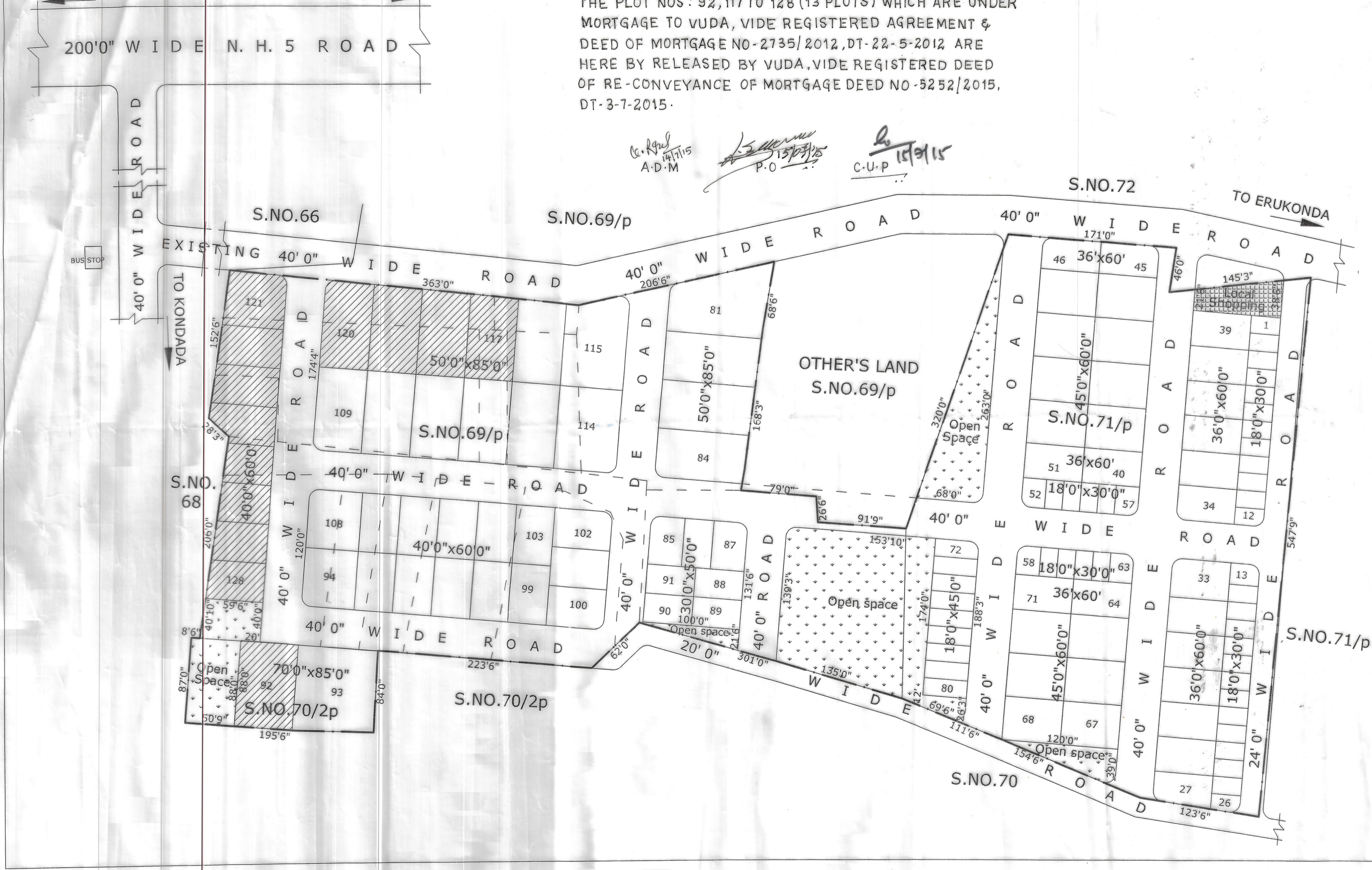

**VISAKHAPATNAM URBAN
 DEVELOPMENT AUTHORITY.**