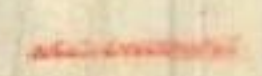

PROPOSED REGULARI-
SATION OF LAY-OUT IN
S. NO. 113/P OF CHINAMU-
SHIDIWADA VILLAGE

SNO	DESCRIPTION	EXTENT AC - CTS	%
1	PLOTTED AREA	2-46	59.27
2	ROADS AREA	1-13	27.24
3	SCHOOL & PLAY GROUND	0-56	13.49
TOTAL		4-15	100.00

LAYOUT BOUNDARY 
SCALE - 1" = 66'

 APPLICANT SITE

NO. OF PLOTS PROPOSED 28

L.P. NO 31/90
(THIS REVISE LP NO. 12/86)
FILE RC NO 124/87H₂

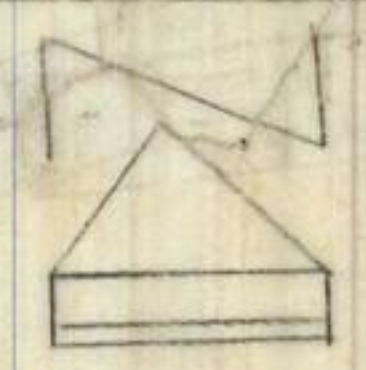

TPS	Sd. K.B. ARUNACHALAM 7/6/87 ASSOCIATE PLANNER
Sd. A. BABURAO 6/6/87 JPO	Sd. M.V. TELANG 9/1/87 CTP & PD
Sd. S.B. BHUYAN 6/6/87 ASST. TOWN PLANNER	M. KRISHNA SWAMY Sd. x x x VICE CHAIRMAN

VISAKHAPATNAM URBAN
DEVELOPMENT AUTHORITY

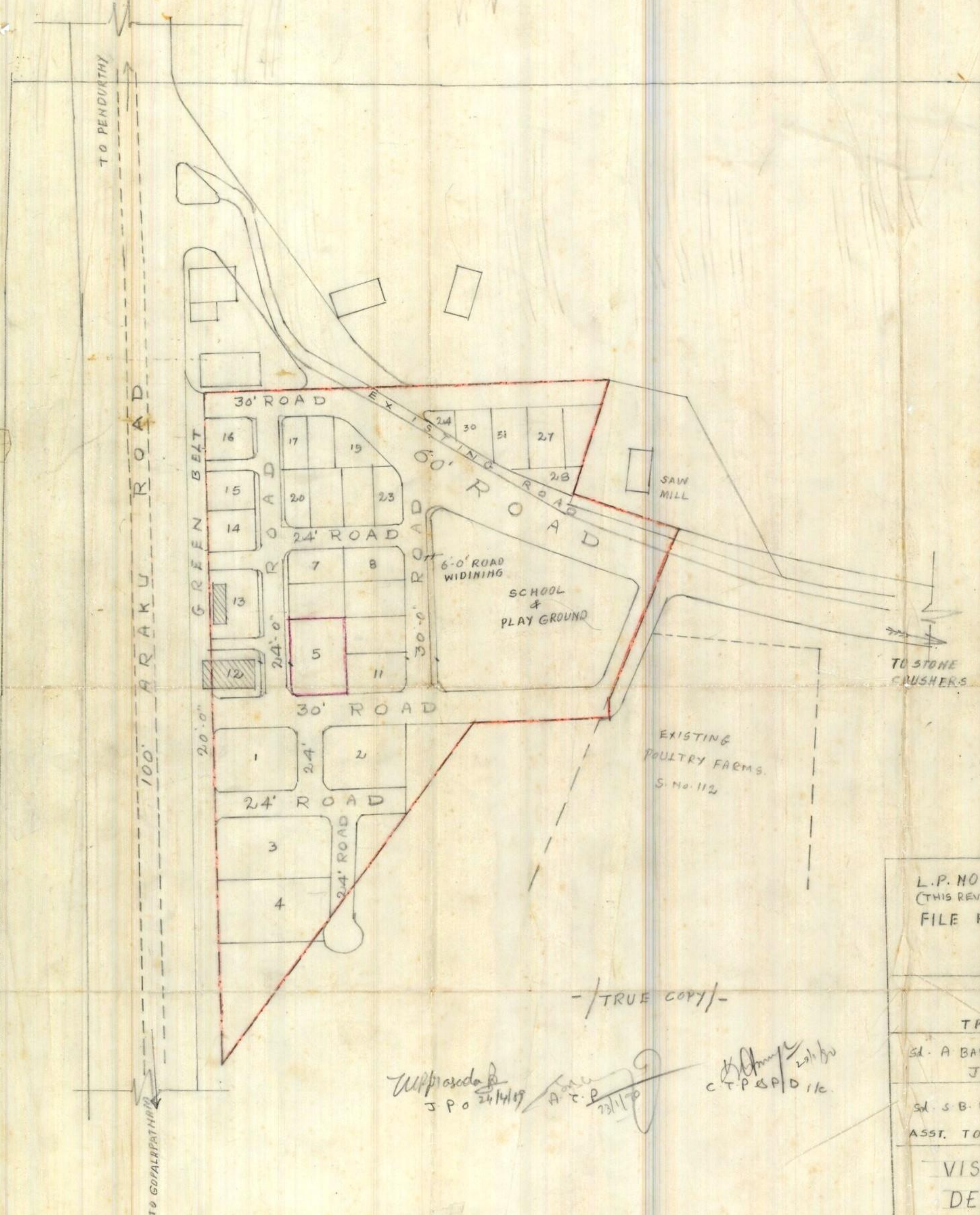

- / TRUE COPY / -

Approved by
J.P.O. 24/1/87
A.C.P.
23/1/87
Sd. M.V. Telang
23/1/87
C.T.P. & P.D. etc.