

Conilla

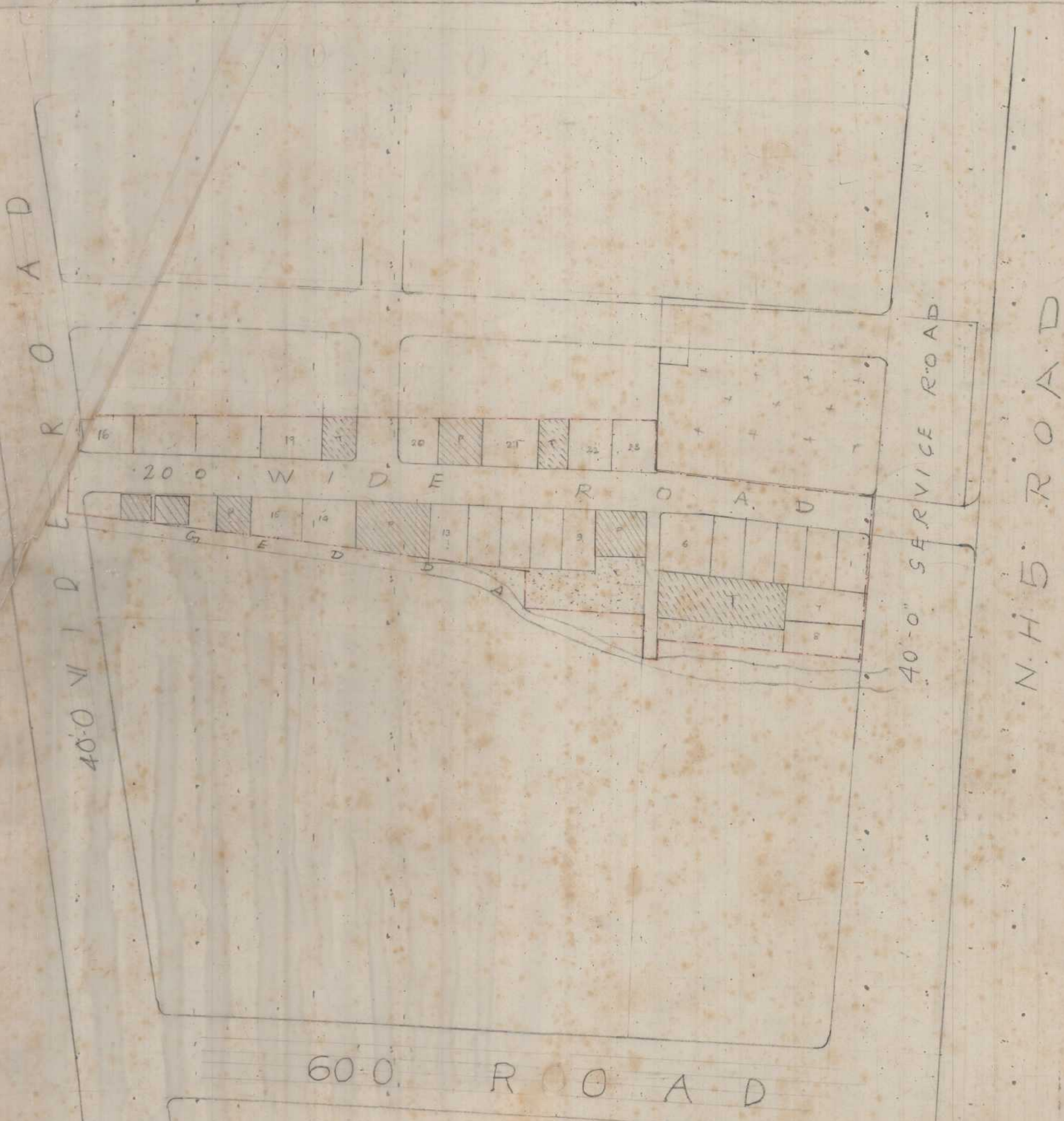

PROPOSED LAY-OUT FOR
 E.W.S. AT DR ZAKIR HUSSAIN
 NAGAR IN S NO. 91/PART OF
 MARRIPALEM, VISAKHAPATNAM

TOTAL EXTENT:

LAND USE ANALYSIS

PERTICULARS	ACS	%
PLOTTED AREA	0.24	39.34
ROADS AREA	0.20	32.79
OPEN SPACE	0.05	8.20%
EXISTING BUILDINGS	0.12	19.67%
TOTAL	0.61	100.0%

REFERENCE:

PLOT SIZE 15-p x 30-d

TOTAL NO. OF PLOTS 23

LAY-OUT BOUNDARY

SCALE: 1:330
 DRAWN BY *B. S. S. 20-5-87*
 LP NO. 32/88
 FILE RCND4565/88

W. P. S. R. 20-5-87
 JUNIOR PLANNING OFFICER
M. S. S. 20-5-87
 CHIEF TOWN PLANNER & PROJECT DIRECTOR

M. S. S. 20-5-87
 ASST. TOWN PLANNER
C. S. S. 20-5-87
 VICE CHAIRMAN

VISAKHAPATNAM URBAN
 DEVELOPMENT AUTHORITY

ppp
ss