

DOCUMENT STATEMENT

S.NO	NAME OF THE DOC. OWNER	PATTA.NO.	SURVEY NO SUB DIVISION	APPLIED EXTENT
1.	SYED MOHAMMED JAVID		2/1	1.30 3/4
			2/2	1.85 1/2
2.	SYED MOHAMMED NAVID		2/1	1.30 3/4
			2/2	1.85 1/2
3.	SYED MOHAMMED SAYEED		2/1	1.30 1/2
			2/2	1.86
				09.49

PROPOSED LAYOUT PLAN IN S.NO. 2/1P,2P OF KOTHAPETA NORTH WARD, LANKAPATNAM VIZIANAGARAM MUNICIPALITY, VIZIANAGARAM DISTRICT

LAND BELONGS TO

1. SYED MOHAMMED JAVID
2. SYED MOHAMMED NAVID
3. SYED MOHAMMED SAYEED

LAND USE ANALYSIS

S.NO.	DESCRIPTION	EXTENT (Ac. cts.)	PERCENTAGE
1.	PLOTTED AREA (Including 3% Mixed land use area)	5.28	55.63 %
2.	ROADS AREA	3.26	34.37 %
3.	OPEN SPACE	0.95	10.00 %
TOTAL:		9.49	100.00%

PLOT DETAILS

S.NO.	SIZE OF PLOT	EXTENT (IN SQ.YDS)	NO OF PLOTS
1.	18'x40'	80.00	28 (E.W.S)
2.	18'x45'	90.00	39 (E.W.S)
3.	30'x40'	133.33	07
4.	30'x45'	150.00	07
5.	30'x50'	166.66	16
6.	30'x55'	183.33	38
7.	30'x70'	233.33	13
8.	36'x55'	220.00	06
9.	58'x50'	329.13	03
10.	42'x94'	438.66	01
11.	40'x96'	426.66	01
12.	50'x96'	533.33	01

TOTAL 160

- PROPOSED LAY-OUT BOUNDARY
- MORTGAGE PLOT NOS : 23 TO 44
EXTENT: 4114 Sq.yds(0.85 Cents.)
- MIXEDLAND USE PLOT NOS : 1 TO 7
EXTENT: 1419 Sq.yds

EWS : 6170 Sq.yds



RC NO : 9349/2014/L8 LP NO. 32/2017

Syed Mohammed Javid
Syed Mohammed Navid
Syed Mohammed Sayeed
OWNERS SIGNATURES

S. Srinivasulu Reddy
LICENCED ARCHITECT/ SURVEYOR
K.R.No: 01/94/2010
VIZIANAGARAM MUNICIPALITY
VIZIANAGARAM DISTRICT

G. Anand
ADM

Ch. Srinivasulu Reddy
CHIEF URBAN PLANNER

28/12/16
JUNIOR PLANING OFFICER

28/12/16
ASSISTANT PLANING OFFICER

Beema
VICE CHAIRMAN

VISAKHAPATNAM URBAN DEVELOPMENT AUTHORITY

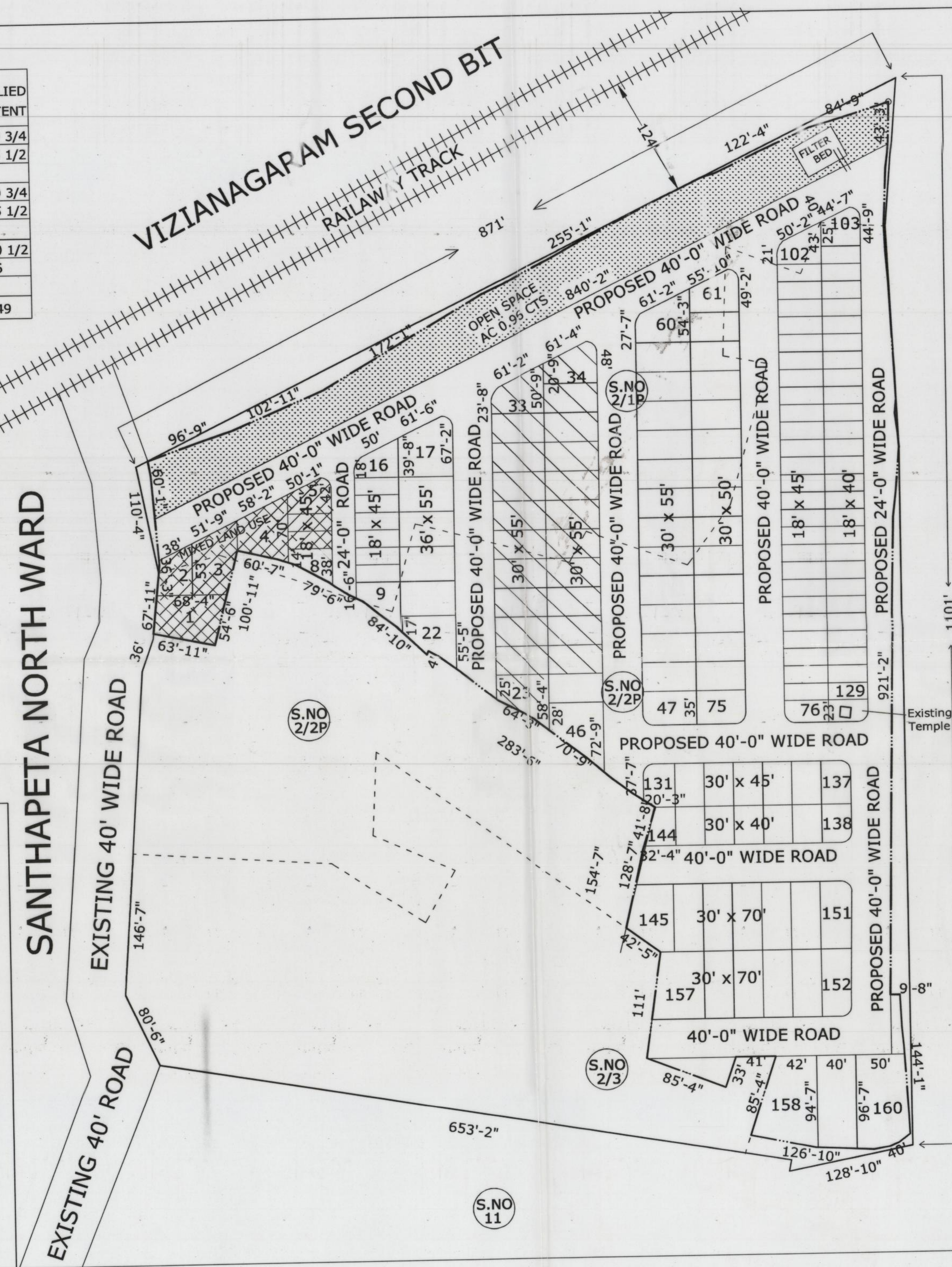

ROUTE MAP

