

PROPOSED LAYOUT PLAN
ALANKRITHA - III
IN SURVEY Nos. 26p,27p,28p, OF
KORADA VILLAGE
PADMANABHAM MANDAL
VISAKHAPATNAM DISTRICT.

NOTE: THE PLOT NOS 111 TO 146 AND 159 (37 PLOTS) WHICH ARE UNDER MORTGAGED TO VUDA VIDE REGISTERED AGREEMENT & DEED OF MORTGAGED NO-1918/2012, DT-18-06-2012 ARE HERE BY RELEASED BY VUDA VIDE REGISTERED DEED OF RECONVEYANCE OF MORTGAGED DEED NO-2671/2014, DT-24-06-2014.

(Signature)
 A.D.M.
 C.U.P.

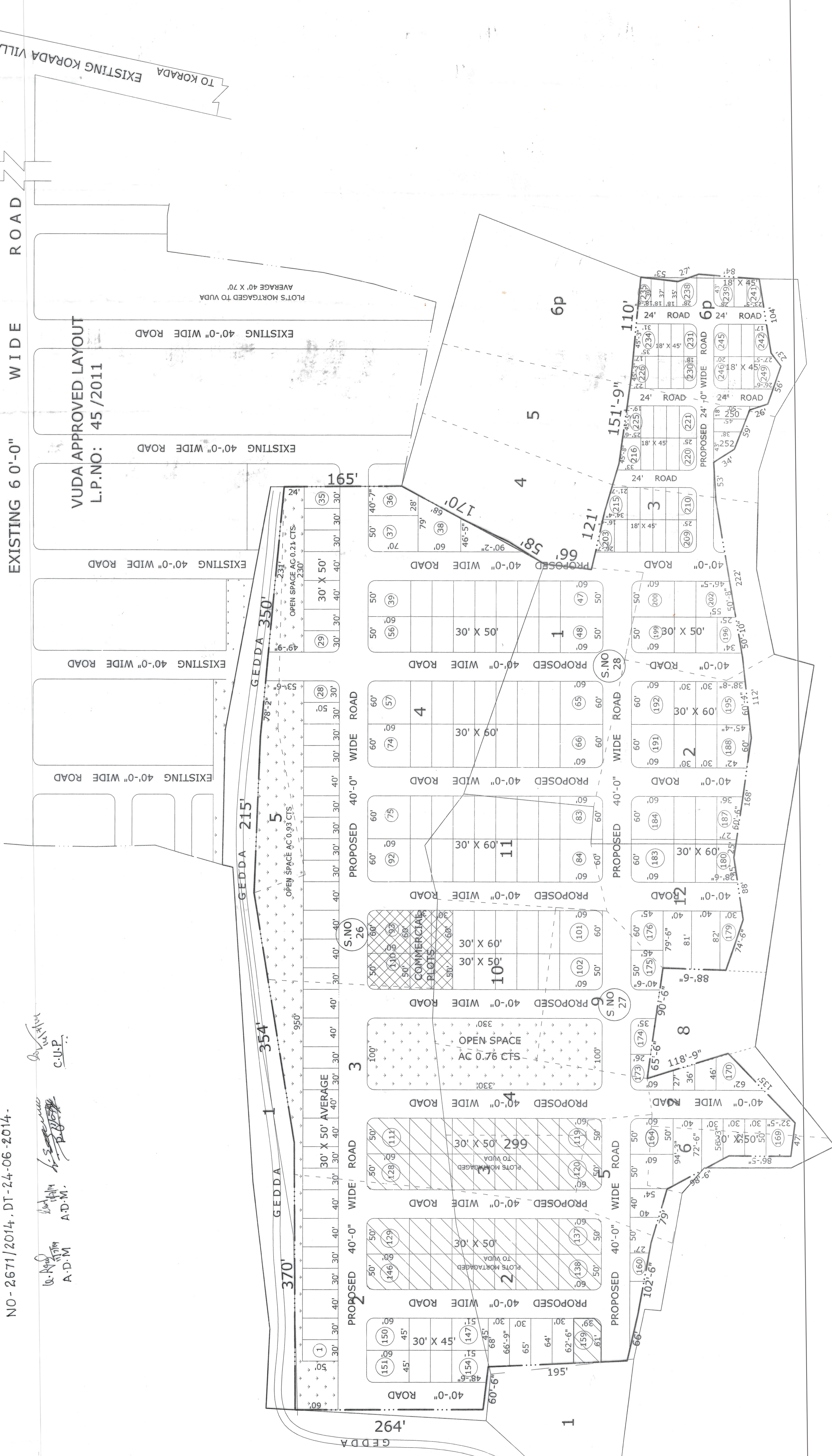

LAND USE ANALYSIS :-

SL.NO.	DESCRIPTION	EXTENT Acs.-cts.	PERCENTAGE
1.	PLOTTED AREA	10.03	54.83 %
2.	COMMERCIAL AREA	0.30	35.09 %
3.	ROADS AREA	6.61	10.08 %
4.	OPEN SPACE AREA	1.90	100.00 %
TOTAL AREA		18.84	

PLOTS DETAILS :-

SL.NO.	PLOT SIZE	PLOT AREA IN Sq Yds	NO OF PLOTS	AC CTS	PERCENT %
1	40' X 80'	355.55	03	0.19	01.839 %
2	45' X 60'	300.00	02	0.143	01.385 %
3	40' X 70'	311.11	03	0.219	02.120 %
4	50' X 60'	333.33	05	0.257	02.488 %
5	30' X 65'	216.66	05	0.233	02.255 %
6	30' X 60'	200.00	61	3.12	30.203 %
7	45' X 50'	250.00	01	0.055	00.532 %
8	30' X 50'	166.66	114	4.730	45.789 %
9	30' X 45' LIG	150.00	8	0.350	03.389 %
10	18' X 45' (EWS)	90.00	50	1.033	10.00 %
TOTAL PLOTS			252	10.33	100.00 %

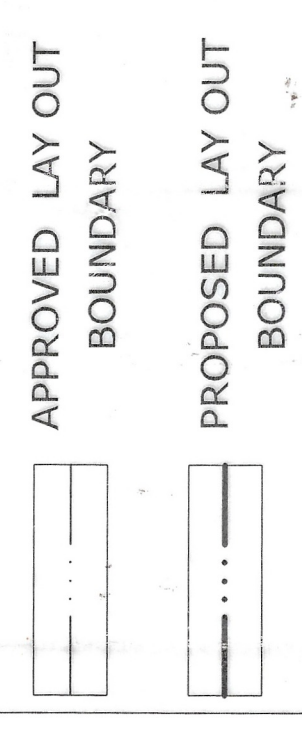

SCALE :- 1" = 660'
 FILE R.C.No.:26482/2011 /1,8
 L.P.No.: 33/2012

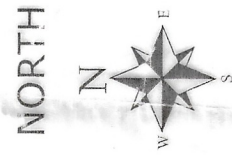

PLOTS MORTGAGED TO VUDA
 PLOT NOS 111 TO 146 & 159
 TOTAL NO OF PLOTS : 37 NOS
 EXTENT : AC 1.565 CTS

(Signature)
 N. Kalayam c/o
 V. Ramani
 OWENERS SIGN.

S. GOPALA RAO
 Licensed Civil Engineer / Surveyor
 Regd. No. 394/2010
 Registration with Development Authority
LICENCED SURVEYOR

(Signature)
 S/D' man.
 Chief Urban Planner

(Signature)
 Asst-Planning Officer

(Signature)
 Planning Officer

(Signature)
 VICE CHAIRMAN

VISAKHAPATNAM URBAN DEVELOPMENT AUTHORITY