

DESCRIPTION OF LAY - OUT IN SNOS

S.NO.	AC - CENTS
125 / 1	1 - 05
125 / 2	0 - 54
125 / 3	0 - 54
125 / 4	3 - 21
125 / 5	0 - 35
125 / 6	0 - 35
TOTAL	6 - 04

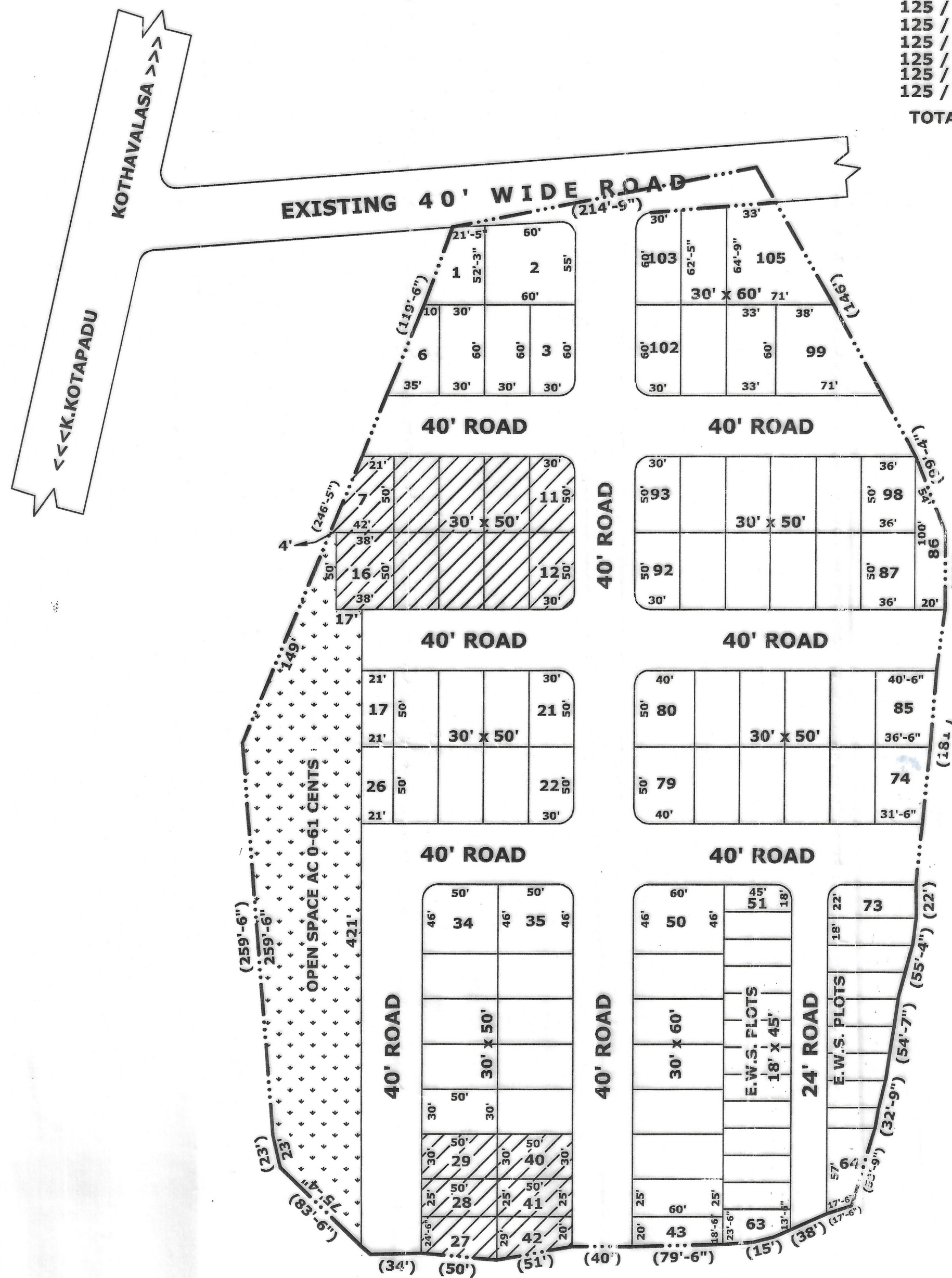

PROPOSED VUDA LAY - OUT PLAN FOR RESIDENTIAL PLOTS IN S.Nos: 125 OF CHIPURUVALASA REVENUE (V) KOTHAVALASA PANCHAYAT KOTHAVALASA - MANDAL VIZIYANAGARAM- DISTRICT.

Belongs to:-

- GOKINA KONDA HANUMANTHAYYA S/O (LATE) VENKATA SUBBAYYA
- MULLAPUDI KRISHNA RAO S/O (LATE) SATYAM

DOVELOPER :- LANKA RAMANA PATRUDU. VIJAYA CHAITANYA INFRA STRUCTURES. (KOTTA VALASA.)

LAND USE ANALYSIS:

SL. NO.	DESCRIPTION	EXTENT IN Ac - cts.	PERCENTAGE
1.	PLOTTED AREA	3 - 57	59.10 %
2.	ROAD AREA	1 - 86	30.80 %
3.	OPEN SPACE	0 - 61	10.10 %
4.	TOTAL AREA	6 - 04	100.00 %

PLOT DETAIL:

NO. SL.	PLOT SIZE	PLOTAREA IN Sq. Yds	NO.OF PLOT:
1.	30' X 60'	200.00	18
2.	30' X 50'	166.66	42
3.	18' X 45' E.W.S	90.00	21
4.	OTHER SIZES		24
TOTAL NO.OF PLOTS			105

PROPOSED LAYOUT BOUNDARY

PLOTS MORTGAGED TO VUDA 16 nos
PLOT NOS: 7 To 16, 27 to 29, 40 TO 42.
EXTENT: Ac.- 0 - 54 cts.Or 2613 sqyards

1.

2.

OWNER'S SIGN

LICENSED SURVEYOR

SCALE: 1" = 132'-0"
FILE RC. NO: 422/12/18
L.P.NO: 33/2014

N

10/3/14
ADM

Chief Urban Planned

11/3/14
JPO

13/3/14
Planning Officer

18/1/14
Vice-Chairman

VISAKHAPATNAM URBAN DEVELOPMENT AUTHORITY.