

NOTE:- 1 PLOT Nos 96, 111, 77: DELTED
 SINCE NOT AVAILABLE ON GROUND
 2 BUILDING LINE 10'-0" TO PLOT SIZE 30'x50'
 TO BE OBSERVED TO 100'-0" ROAD IN TERMS OF
 G.O.MS NO-76 M.A dt 6-2-92 SET BACK FOR
 A 50' DEPTH PLOT IS ONLY 2.25 MTS. HENCE
 IT IS ADOPTED 3.0M

Handwritten signatures and dates:
 A.D.M. 21-6-93, J.P.O., A.P.O., C.P.O. 2/6/93

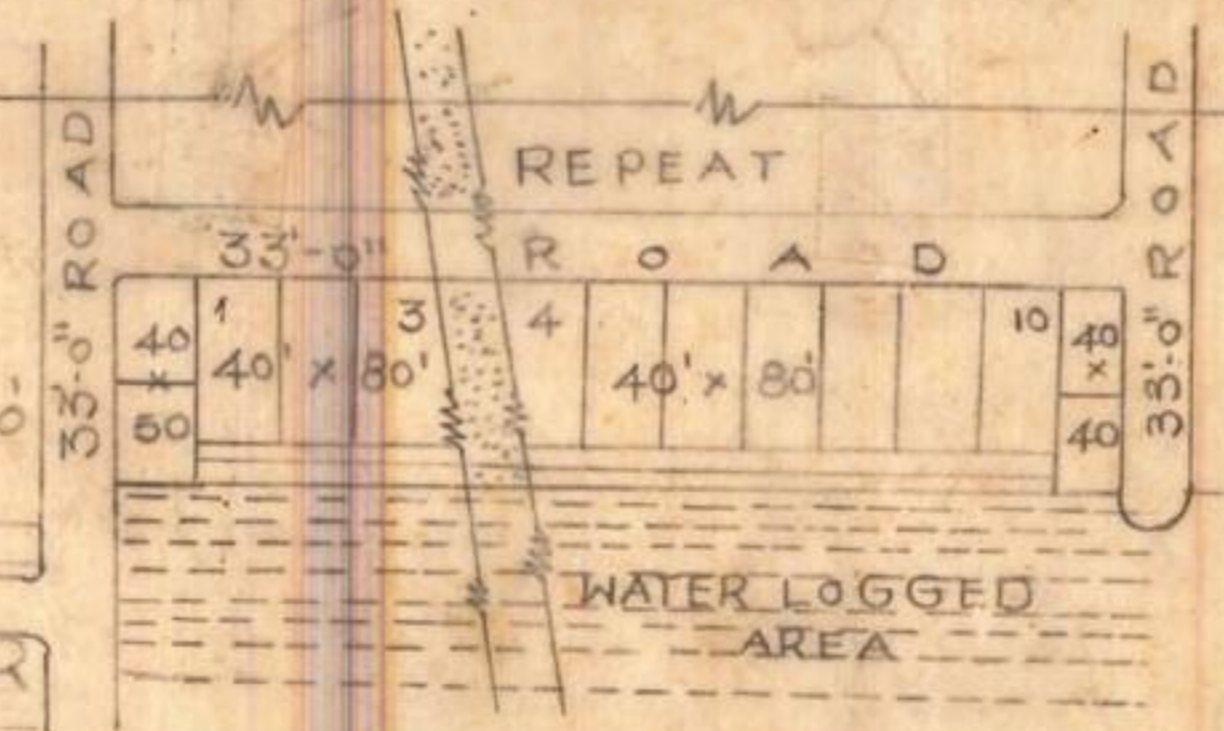

SNO	SIZES	EARLIER NO-OF PLOTS	REVISED NO-OF PLOTS
1	50' x 80'	26	26
2	40' x 60'	81	81
3	30' x 50'	201	175
4	40' x 80'	-	10
TOTAL		308	292

PROPOSED LAY-OUT FOR
 O.H.P.E. CO-OPERATIVE H.B
 SOCIETY LTD. REGD. NO. B119
 IN S.NOS 115 118 TO 123 136 &
 138/P. OF GOPALAPATNAM
 OF VISAKHAPATNAM MANDAL

LAND USE ANALYSIS

SL. NO	DESCRIPTION	EXTENT AC-CT	PERCENTAGE
1.	PLOTTED AREA	14.45	59.30
2.	ROADS AREA	6.72	27.60
3.	OPEN SPACE AREA	3.20	13.10
TOTAL EXTENT OF LAY OUT		24.37	100.00

— LAY OUT BOUNDARY

SL. NO	SIZE OF PLOTS	NO OF PLOTS
1.	50' x 80'	26
2.	40' x 60'	81
3.	30' x 50'	201
TOTAL NO OF PLOTS		308

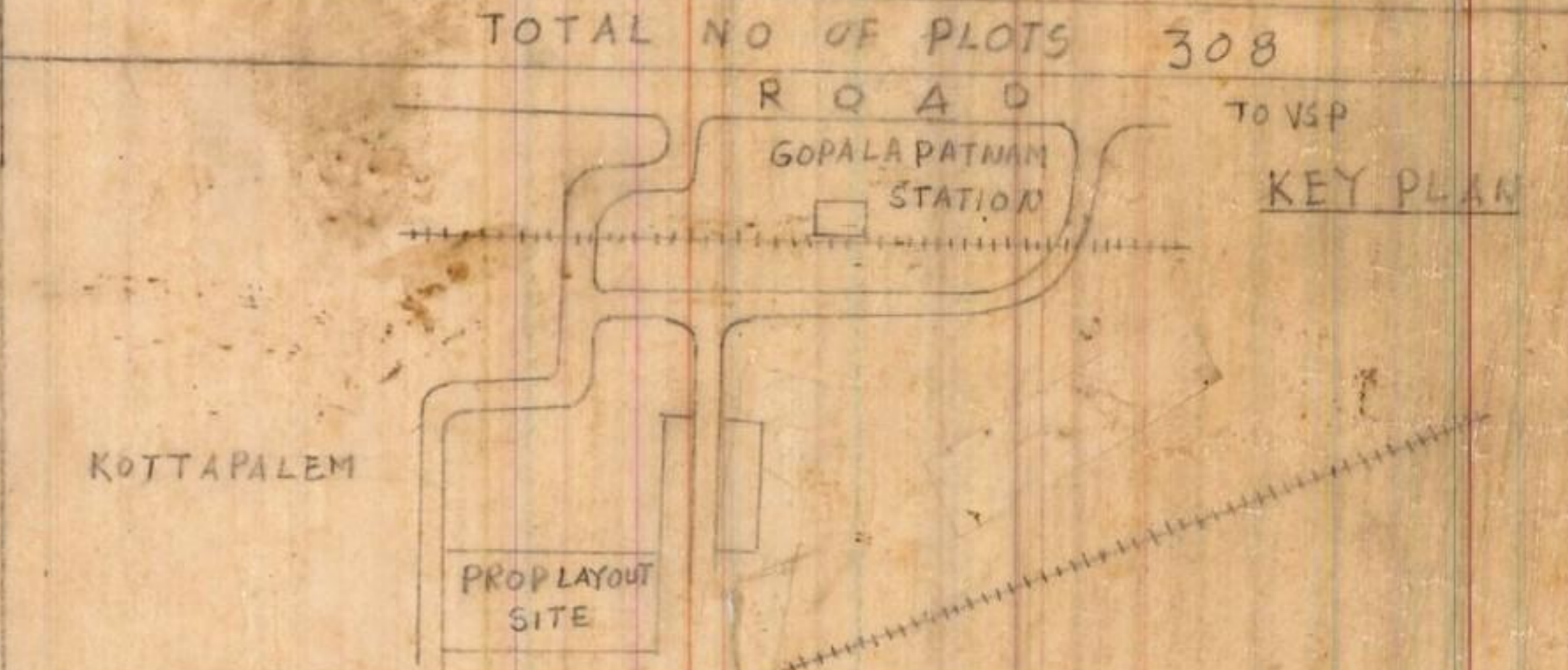

SCALE: 1" = 132'-0"
 FILE: R.C. NO 1321/89
 L.P. NO 34/89
 C.B.L.P. NO 16/89

Ch. Ramakrishna
 SURVEYOR/D MAN
 CHIEF TOWN PLANNER

W. Appala Rao
 JUNIOR PLANNING OFFICER

S. S. Kumar
 ASSISTANT TOWN PLANNER

Binay Kumar
 VICE CHAIRMAN

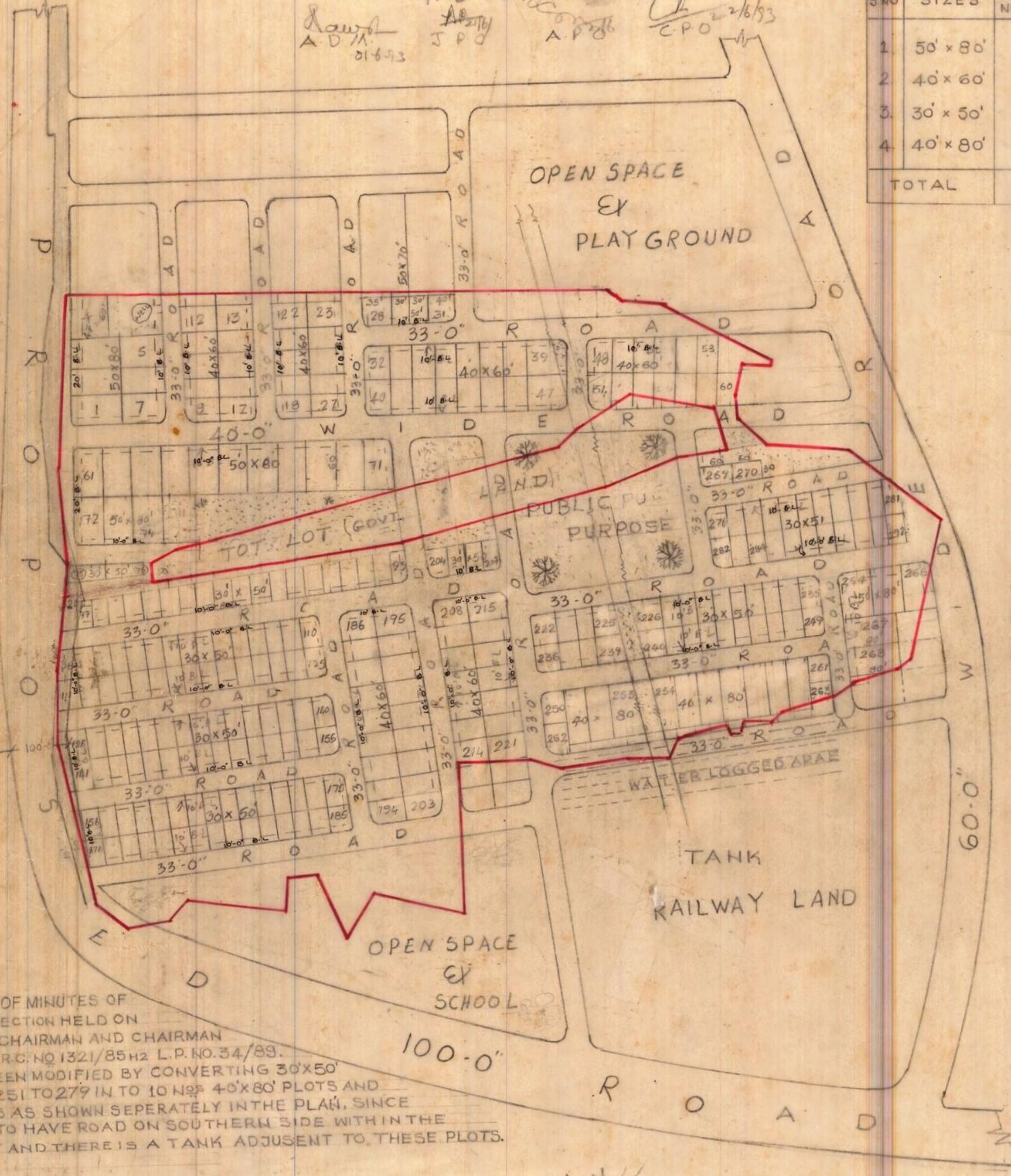

NOTE:-
 AS PER THE APPROVAL OF MINUTES OF
 SUB-COMMITTEE'S INSPECTION HELD ON
 6-9-89 BY THE VICE-CHAIRMAN AND CHAIRMAN
 ON DATED-14-9-89 IN R.C. NO 1321/85 H2 L.P. NO. 34/89.
 THE LAY-OUT HAS BEEN MODIFIED BY CONVERTING 30'x50'
 PLOTS BEARING NOS 251 TO 279 IN TO 10 NOS 40'x80' PLOTS AND
 4 NOS 30'x50' PLOTS AS SHOWN SEPERATELY IN THE PLAN, SINCE
 THERE IS NO LAND TO HAVE ROAD ON SOUTHERN SIDE WITH IN THE
 LAY-OUT BOUNDARY AND THERE IS A TANK ADJUSENT TO THESE PLOTS.

B. V. Jayashankar
 ARCH. D.MAN
 13-11-89

B. Vijayashankar
 J.P.O. 13/12/89

A.P.O.

A.P.O.