

PROPOSED LAND DETAILS			
S.No.	Survey No.	Extent in Acres	
		Adangal	Registered
1.	58/1	0.28	0.28
2.	58/2	0.12	0.12
3.	58/3	0.15	0.15
4.	58/4	0.13	0.13
5.	58/5	0.20	0.20
6.	58/6	0.24	0.24
7.	58/7	0.30	0.30
8.	58/8	0.16	0.16
9.	58/9	0.34	0.34
10.	58/10	0.21	0.21
11.	58/11	0.11	0.11
12.	58/12	0.14	0.14
13.	58/13	0.19	0.19
14.	58/14	0.16	0.16
15.	58/15	0.16	0.16
16.	58/16	0.18	0.18
17.	58/17	0.24	0.24
18.	58/18	0.29	0.29
19.	58/19	0.15	0.15
20.	59/1	0.63	0.63
21.	59/2	0.20	0.20
22.	59/3	0.22	0.22
23.	59/4	0.23	0.23
24.	59/5	0.23	0.23
25.	59/6	0.20	0.20
26.	59/7	0.23	0.23
27.	59/8	0.20	0.20
28.	59/9	0.13	0.13
29.	59/10	0.26	0.26
30.	59/11	0.20	0.20
31.	59/12	0.18	0.18
32.	59/13	0.32	0.32
33.	59/14	0.21	0.21
34.	59/15	0.28	0.28
35.	59/16	0.25	0.25
Total		7.72	7.72

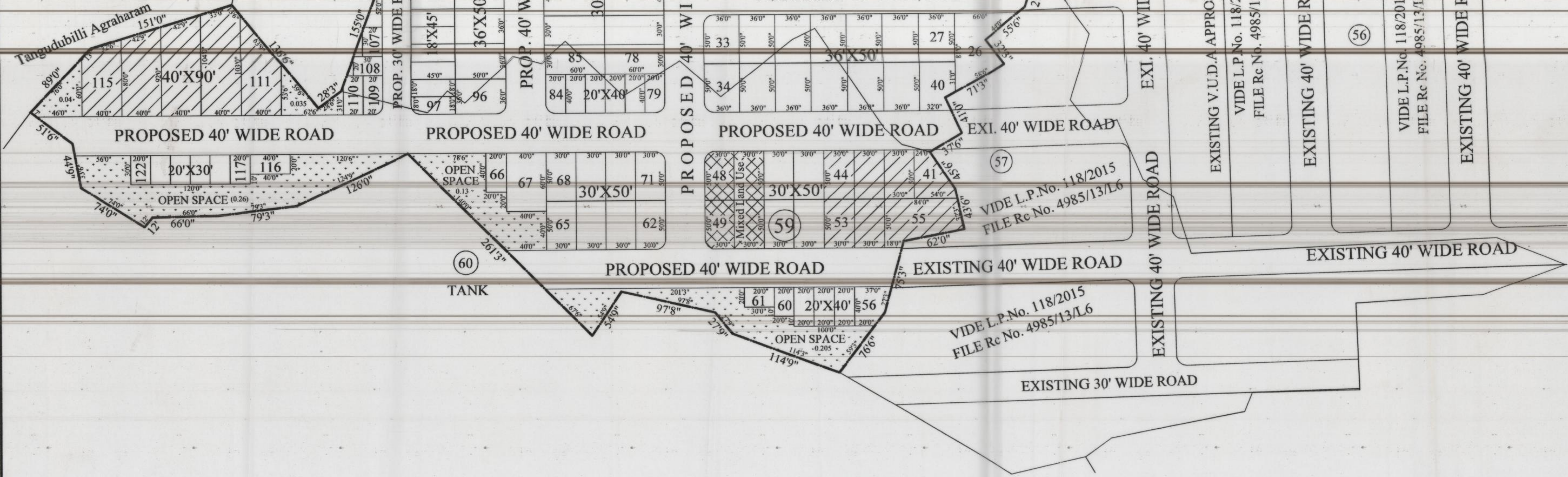
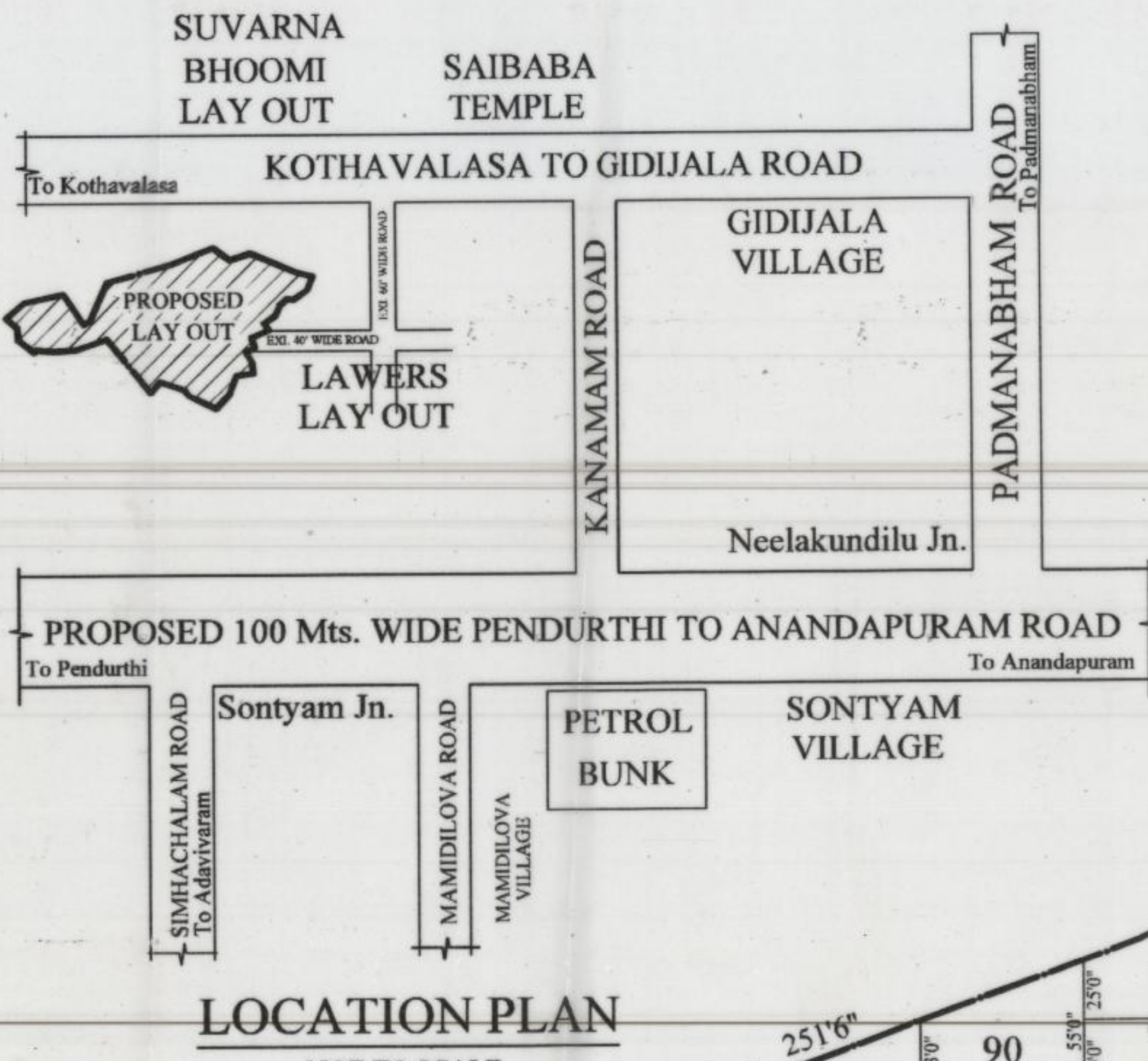

**PLAN SHOWING THE PROPOSED LAY OUT IN S. Nos. 58 & 59 OF GIDIJALA VILLAGE ANANDAPURAM MANDAL VISAKHAPATNAM DISTRICT**

**BELONGS TO :**  
M/s LAKSHMI GANESH CONSTRUCTIONS  
Rep By: Sri. S.S.R.K.S.PRASAD Managing Partner  
S/o Late NARAYANA RAO

LAND USE ANALYSIS			
S.No.	DESCRIPTION	EXTENT IN ACRES	PERCENTAGE
1.	PLOTTED AREA (Including Mixed Land Use area 3% = Ac 0.14 Cts)	4.500	58.29 %
2.	ROADS AREA	2.445	31.67 %
3.	OPEN SPACE AREA	0.775	10.04 %
TOTAL AREA		7.720	100.00 %

PLOTING DETAILS			
S.No.	SIZE OF PLOT	AREA OF PLOT	No. OF PLOTS
1.	40' 0" X 90' 0"	400.00 SqYds	4
2.	40' 0" X 60' 0"	266.66 SqYds	8
3.	30' 0" X 60' 0"	200.00 SqYds	34
4.	36' 0" X 50' 0"	200.00 SqYds	19
5.	30' 0" X 50' 0"	166.66 SqYds	23
6.	18' 0" X 45' 0"	90.00 SqYds	10
7.	20' 0" X 40' 0"	88.88 SqYds	14
8.	20' 0" X 30' 0"	66.66 SqYds	10
TOTAL PLOTS			122

SCALE : 1" = 66'0"  
NORTH  
LAY OUT BOUNDARY

PLOTS MORTGAGED TO VUDA  
PLOT Nos:- 41 to 44, 53 to 55 & 111 to 115 = 12 Plots  
EXTENT:- Ac 0.675 Cts ( 3267 SqYds )  
File R.C.No.-: 6947/2016/L6  
L.P.No.-: 36/2017

For Lakshmi Ganesh Constructions  
Managing Partner  
SIGN. OF OWNER  
K.V.H. Sundara Rao  
Licensed Civil Engineer  
Regd. No. 62/2013-16  
Urban Development Authority  
VISAKHAPATNAM  
Cell: 9440146933, 2569936(R)  
SIGN. OF L. SURVEYOR

SK. *[Signature]*  
19/12/2016  
S/D.MAN  
CHIEF URBAN PLANNER

*[Signature]*  
20/12/16  
Asst. PLANNING OFFICER  
VICE CHAIRMAN

**VISAKHAPATNAM URBAN DEVELOPMENT AUTHORITY**