

**PROPOSED LAY OUT PLAN  
IN S. Nos. 176/1, FOR  
AN EXTENT OF AC 7.90 CTS OF  
SARIKA VILLAGE  
VIZIANAGARAM MANDAL  
VIZIANAGARAM DISTRICT.**

**LAND USE ANALYSIS:-**

Sl. No	LAND USED FOR	EXTENT IN ACRES	PERCENTAGE
1.	PLOTTED AREA	4.08	51.65 %
2.	ROADS AREA	3.03	38.35 %
3.	OPEN SPACE AREA	0.79	10.00 %
<b>TOTAL AREA</b>		<b>7.90</b>	<b>100.00 %</b>

**PLOTS DETAILS:-**

SL.NO.	PLOT SIZE	PLOT AREA IN Sq Yds	NO. OF PLOTS	PLOT AREA IN ACRES	PERCENTAGE
1	30' X 60'	200.00	13	0.55	13.48 %
2	30' X 55'	183.33	36	1.41	34.56 %
3	36' X 45'	180.00	15	0.57	13.97 %
4	30' X 50' (LIG)	166.66	29	1.05	25.74 %
5	18' X 40' (EWS)	80.00	28	0.50	12.25 %
			<b>121</b>	<b>4.08</b>	<b>100.00 %</b>

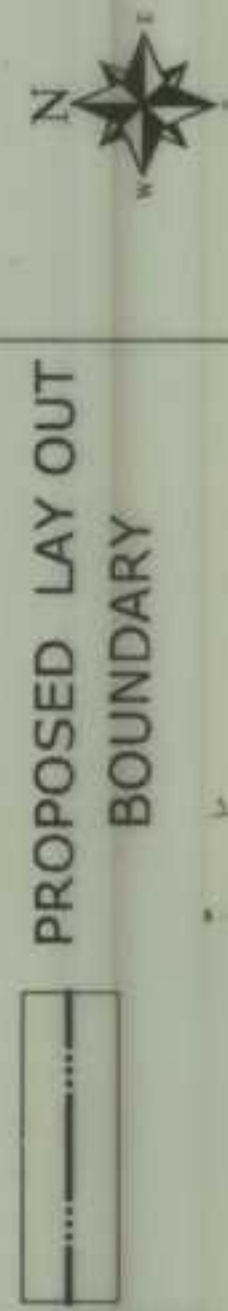

FILE R.C.No:  
1299/2012/L8  
L.P.No.:37/2013

SCALE:  
1" = 132'-0"

PLOTS MORTGAGED TO VUDA  
PLOT Nos.: 86 TO 93, 114 TO 121  
TOTAL PLOTS MORTGAGED = 16  
EXTENT : AC 0.64 CTS



*S. Sripala Rao*  
Licenced Civil Engineer / Surveyor  
Regd. No. 304/2010  
Vizianagaram Urban Development Authority  
VIZIANAGARAM

LICENCED SURVEYOR

OWNERS SIGN.

*Bechara*  
25/6/13  
S/D' man.

Planning Officer

*Divya*  
27/12  
Chief Urban Planner

VICE CHAIRMAN

VISAKHAPATNAM URBAN  
DEVELOPMENT AUTHORITY

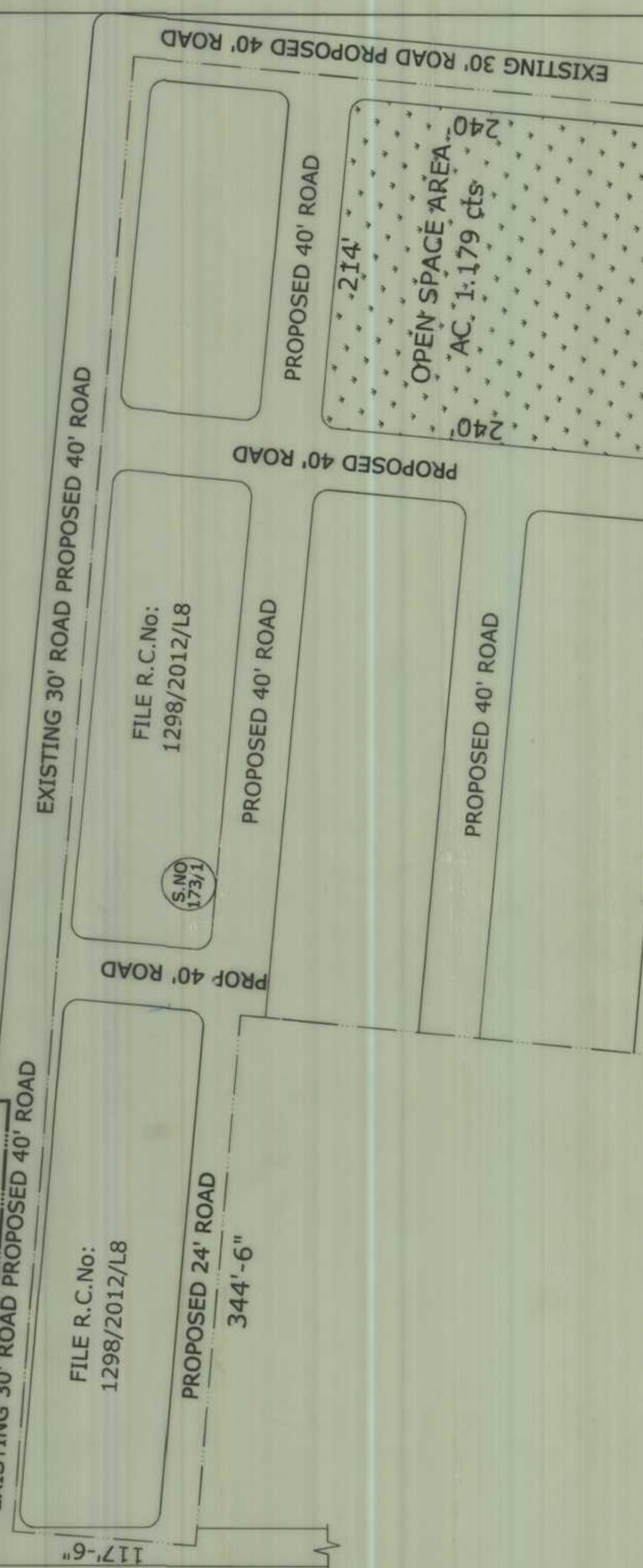
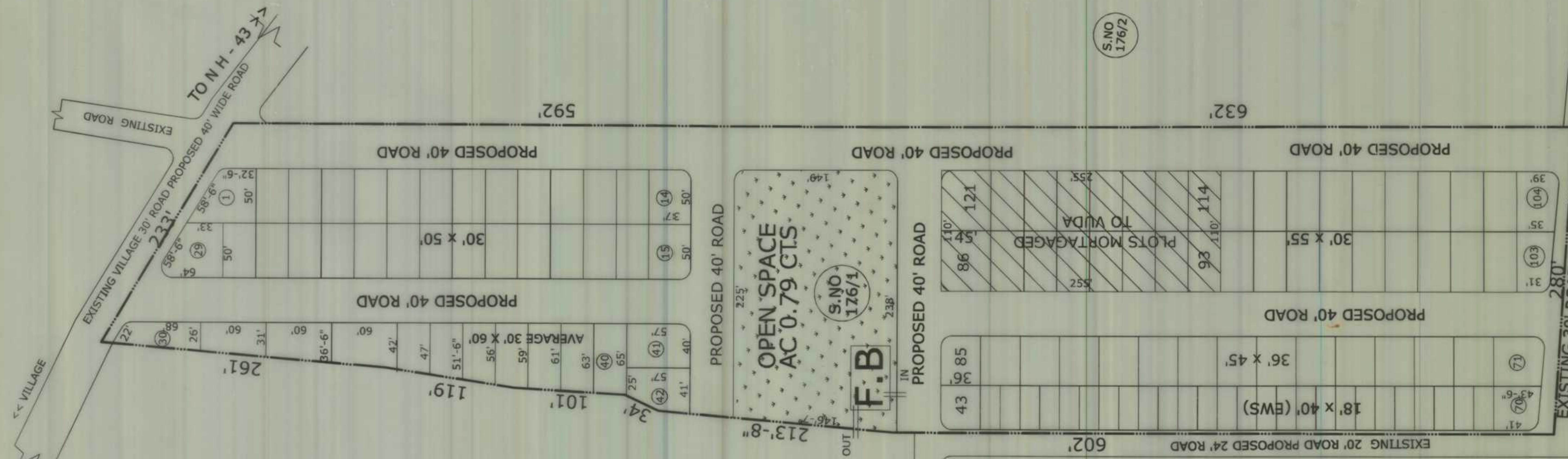

S.NO  
176/2

S.NO  
173/1

FILE R.C.No:  
1298/2012/L8

FILE R.C.No:  
1298/2012/L8