

REVISED LAY-OUT
 PLAN (OF SNO): 4 / PART
 (OF MAIDHURAWDA
 (VILLAGE)
 VISAKHAPATNAM DIST.

BELONGS TO OWNER
 SRI. SIVA RAMAKRISHNA & OTHERS

LAND USE ANALYSIS

S.NO.	DESCRIPTION	EXTENT	PERCENTAGE
1.	PLOTTED AREA	4.72	57.21%
2.	ROADS AREA	2.70	32.73%
3.	OPEN AREA	0.83	10.06%
TOTAL EXTENT		8.25	100.00%
NO	SIZE OF PLOTS	NO. OF PLOTS	
1.	40' 0" X 70' 0"	49	
2.	30' 0" X 50' 0"	44	
TOTAL PLOTS		93	

SCALE : 1" = 132' 0"
 FILE NO: 3123/88/94
 I.P. NO: 30/91
 (B.L.P. NO: 4/91)

Ch. Ramakrishna
 SURVEYOR / A.M.

Ch. Ramesh Babu
 JUNIOR PLANNING OFFICER

Ch. Venkatesh
 ASST. PLANNING OFFICER

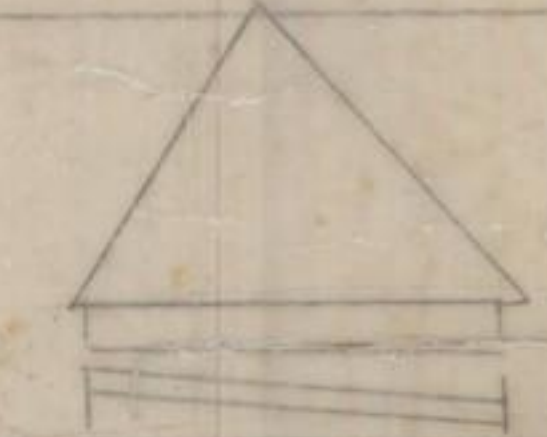

Ch. Ramesh Babu
 CHIEF PLANNING OFFICER

Ch. Ramesh Babu
 VICE CHAIR MAN

VISAKHAPATNAM URBAN
 DEVELOPMENT AUTHORITY.



NOTE: OVER HEAD ELE LINES ARE RUNNING THROUGH PLOT NO 79 TO 81 THE APPROVAL OF B.A WILL BE CONSIDERED ONLY AFTER OVER HEAD ELE LINES ARE SHIFTED BY THE LAYOUT OWNER.

REFERENCE
 ROAD TO BE FORMED BY BOTH PARTIES
 LAND TO BE HANDED OVER TO SIDE OWNERS TO BUILT THE REGULAR PLOTS