

<<<< N.H.5 ROAD

TO TUDEM VILLAGE >>>

EXISTING B.T ROAD

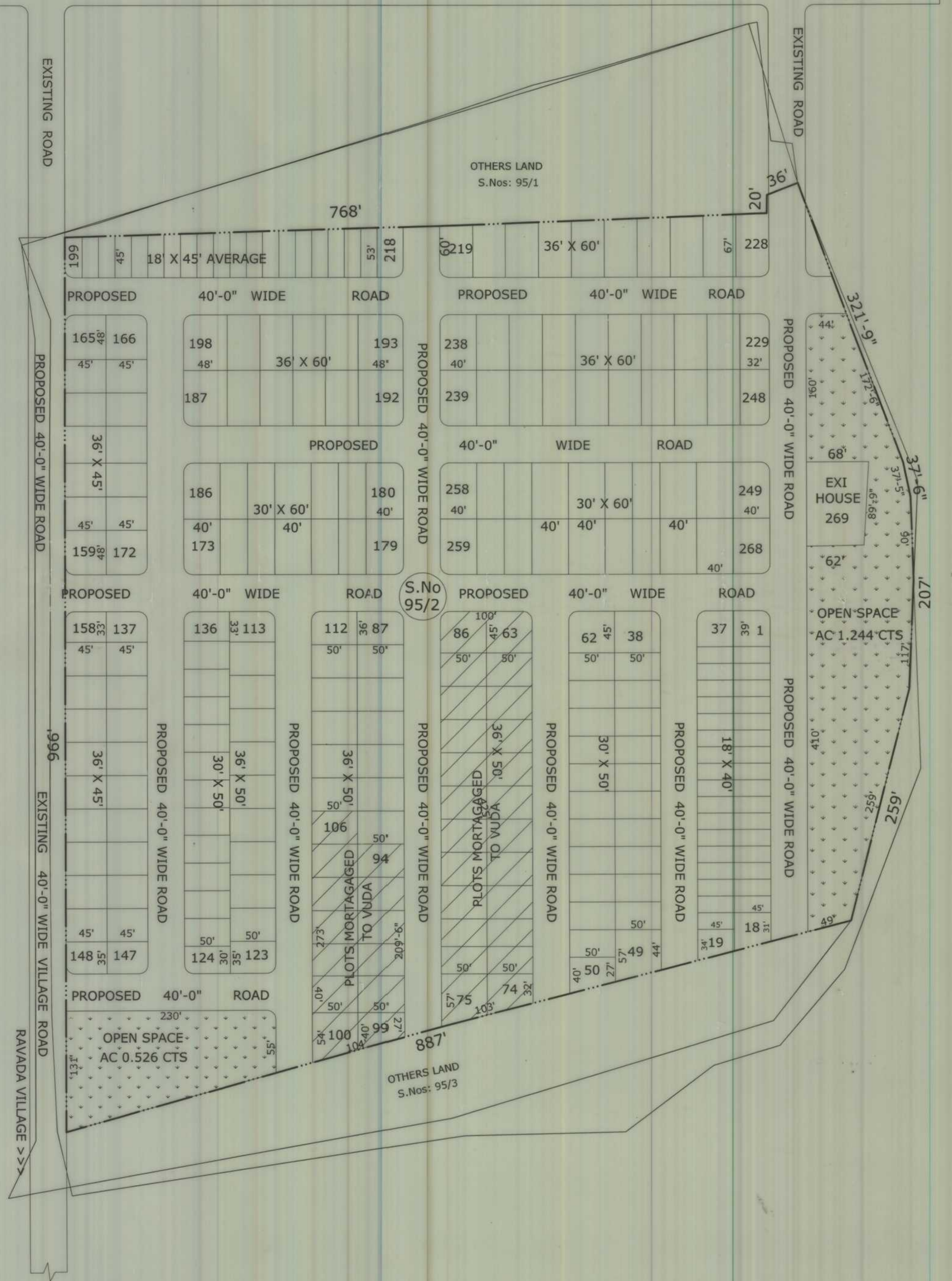

**PROPOSED LAYOUT PLAN  
IN S.Nos: 95/2 OF  
RAVADA VILLAGE,  
BHO GAPURAM- MANDAL,  
VIZIYANAGARAM- DISTRICT.**

**LAND USE ANALYSIS :-**

SL.NO.	DESCRIPTION	EXTENT Ac.-cts.	PERCENTAGE
1.	PLOTTED AREA	10.33	58.53 %
2.	ROADS AREA	5.55	31.44 %
3.	OPEN SPACE AREA	1.77	10.03 %
TOTAL AREA		17.65	100.00 %

**PLOTS DETAILS :-**

SL.NO.	PLOT SIZE	PLOT AREA IN Sq Yds	NO OF PLOTS	PLOT AREA IN ACRES	PERCENTAGE
1.	62' X 98'	675.00	01	0.13	01.26 %
2.	36' X 60'	240.00	42	2.16	20.91 %
3.	30' X 60'	200.00	34	1.65	15.97 %
4.	36' X 50'	200.00	61	2.54	24.59 %
5.	30' X 50'	166.66	38	1.37	13.26 %
6.	36' X 45'	180.00	36	1.38	13.36 %
7.	18' X 45'	90.00	20	0.41	10.65 %
8.	18' X 40'	80.00	37	0.69	
			269	10.33	100.00 %

— — — — — PROPOSED LAYOUT BOUNDARY.

FILE RC.NO: 2159/2012/ L8 L.P.NO: 4/2013

SCALE :  
1" = 66'-0"

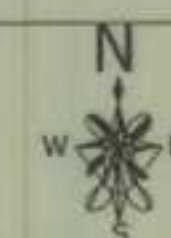

PLOTS MORTGAGED TO VUDA

Plot Nos.: 63 To 86  
94 To 106

TOTAL PLOTS MORTGAGED = 37  
EXTENT : AC 1.56 CTS

*M. Sijamala Devi*  
*M. Banubhathi Nuth*

*DRG*  
*SRM*

*Nithya*

For Raja Infra Projects Pvt. Ltd.  
Manager's Director

**OWENERS SIGN.**

*S. S. S. S.*  
S. GOPALA RAO  
Licenced Civil Engineer / Surveyor  
Ragd. No. 394/2013

Visakhapatnam Urban Development Authority  
**LICENCED SURVEYOR**

*S/D man.*  
S/D' man.

As a Planning Officer

*Y. K. S.*  
29/11/12  
Planning Officer

*Ch. S. S.*  
Chief Urban Planner

VICE CHAIRMAN

**VISAKHAPATNAM URBAN  
DEVELOPMENT AUTHORITY**