

PLAN SHOWING THE PROPOSED LAY-OUT SRI SATYA SAI NAGAR IN SNOS 85/p 86/p 87/p & 88/p OF LAKSHMIPURAM (V) PENDURTY(M) VISAKHAPATNAM DISTRICT

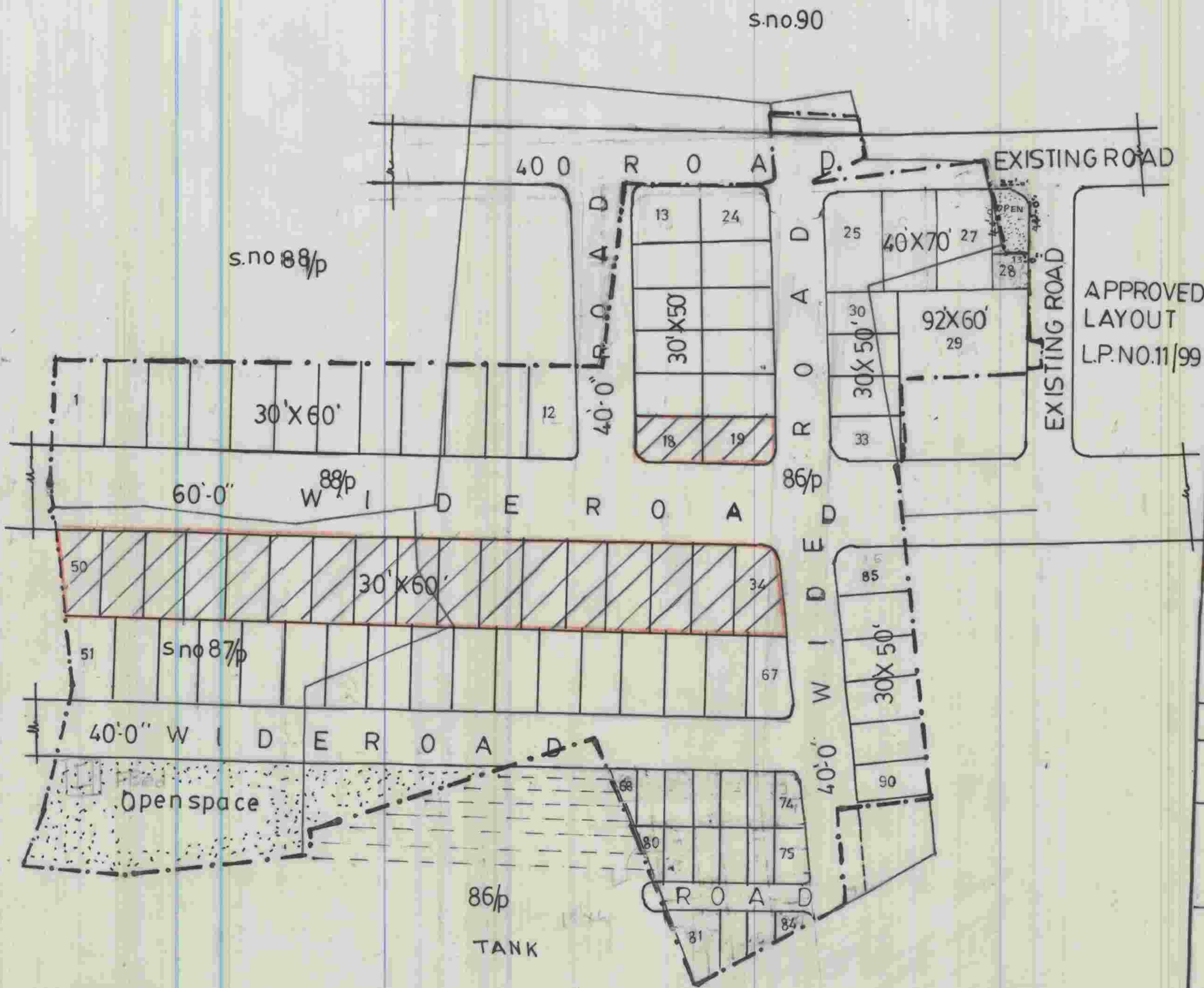

LAND USE ANALYSIS

S.NO	DESCRIPTION	EXTENT	PERCENTAGE
1.	PLOTTED AREA	3.08	57.25
2.	ROADS AREA	1.92	35.69
3.	OPEN SPACE AREA	0.38	7.06
TOTAL EXTENT		5.38	100.00

S.NO	PLOT SIZE	SQ. YARDS	NO PLOTS
1.	40'0"X 70'0"	311.11	3
2.	30'0"X 60'0"	200.00	46
3.	30'0"X 50'0"	167.66	22
4.	18'0"X 40'0"	80.00	18
5.	92'0"X 60'0"	613.33	1

TOTAL NO.OF PLOTS 90

--- LAY-OUT BOUNDARY

SCALE: 1" = 66'0"  
L.P.No: 40/04

FILE.RC.NO:  
4495/04/A.P.O



K. Venkateswara Reddy  
SIGNATURE OF OWNER

Hema Sundar K.V.S.  
D.C.E.  
LICENCED SUPERVISOR  
LICENCED SURVEYOR  
VISAKHAPATNAM

K.V. Jayaram Reddy  
28/7/04  
A.D.M

Chief Urban Planner

B. Vijayalakshmi  
28/7/04  
ASST. PLANNING OFFICER

Vice-Chairman

VISAKHAPATNAM URBAN DEVELOPMENT AUTHORITY

▨ PLOTS MORTGAGED TO VUDA.  
EXTENT: ACS 0.77 Cts  
PLOT NOS 18, 19, 34 TO 50  
30'0"X 50'0": 2 NOS  
30'0"X 60'0": 17 NOS

Deed of Relinquishment of above mortgaged plots were executed by Vuda vide document no 6469/2004 in this office orders R.C.no 4495/04/dt. 12-04

A.D.M  
A.P.O  
C.U.P