

BALAJI GARDENS LAYOUT FOR NSTL EMPLOYEES CO-OP H.B SOCIETY REG NO: B1755 IN S.NO: 124/P OF VEPAGUNTA

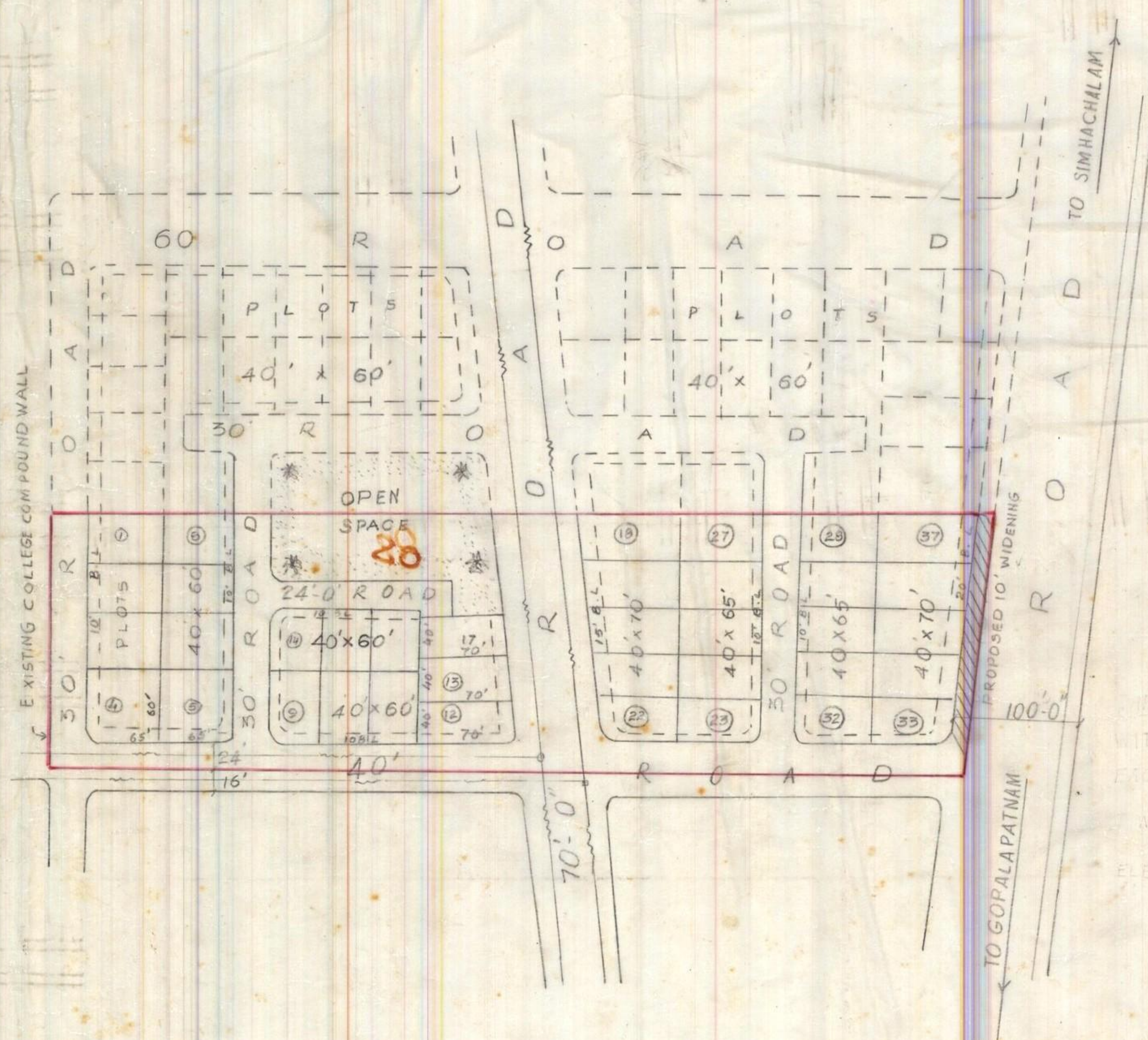

LAND USE ANALYSIS

TOTAL NO OF PLOTS	37 NOS.
SIZE OF THE PLOTS	
60' x 65'	2
40' x 60'	12
40' x 65'	10
40' x 70'	13
PLOTTED AREA	AC. 2.27 - 60.21%
ROADS AREA	AC 1.25 - 33.16%
OPEN SPACE AREA	AC. 0.25 6.63%
TOTAL EXTENT AC.	AC 3.77 100.00

LAY-OUT BOUNDARY

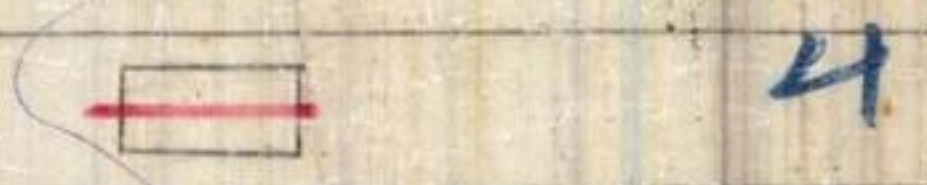

SCALE 1"=66'-0"

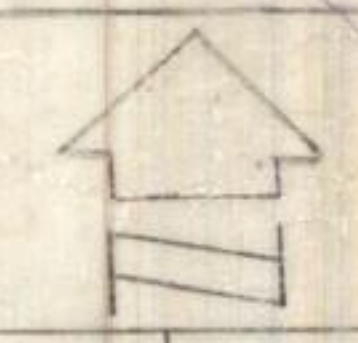

LP NO: 44/88
(Rev 13/88)
FILE NO: 3905/86
BLP NO: 2/87

Ch. Ramasubrahmaniam
A.D.M. 2-6-88

CHIEF TOWN PLANNER & PROJECT DIRECTOR

L.S. Hanumanth
J.P.O. 3/6/88

ASST. TOWN PLANNER

VICE CHAIR MAN

VISAKHAPATNAM
DEVELOPMENT

THE SOCIETY HAS MORTGAGED PLOTS WITH VUDA AND FROM PLOT NO. 1-35 EACH MEASURING ABOUT 31% TOWARDS SECURITY FOR PROVIDING ELECTRIFICATION