

**PROPOSED LAY - OUT PLAN IN S.NO.31 / 4 TO 7,17P  
18P TO 21 AC 4 - 90 CENTS OF CHELLURU VILLAGE,  
VIZIANAGARAM MANDAL & DISTRICT**

**Belongs to:-**  
1. YANDA PALLI SHAYAMALA  
W/O NARSINGA RAO.

**LAND USE ANALYSIS:**

SL. NO.	DESCRIPTION	EXTENT IN Ac - cts.	PERCENTAGE
1.	PLOTTED AREA	2 - 86	58.37 %
2.	ROAD AREA	1 - 55	31.63 %
3.	OPEN SPACE	0 - 49	10.00 %
4.	TOTAL AREA	4 - 90	100.00 %

**PLOT DETAIL:**

NO. SL.	PLOT SIZE	PLOT AREA IN Sq. Yds	NO. OF PLOTS
1.	30' X 60'	200.00	7
2.	30' X 56'	186.66	4
3.	30' X 50'	166.66	54
4.	107'-6" X 50'	597.22	01
5.	18' X 45' E.W.S	90.00	16

TOTAL NO. OF PLOTS 82

--- PROPOSED LAYOUT BOUNDARY  
PLOTS MORTGAGED TO VUDA 12 nos  
PLOT NOS: 56 to 61, 66 to 71  
EXTENT: AC 0 - 45 CENTS or SQ 2178.00 YARDS

Y. Shyamala  
OWNER'S SIGN  
R. NEMAKUMAR  
Licenced Surveyor No. 4/2012  
VUDA, VISAKHAPATNAM  
Cell : 9441416799  
LICENSED SURVEYOR

SCALE : 1" = 66'-0"  
FILE RC. NO: 8316/13/14  
L.P. NO: 44/2014

Bairdy  
3/5/14  
A.D.M.

V. Narasayamma  
3/6/14  
JUNIOR PLANING OFFICER

Planning Officer - II  
VICE CHAIRMAN

**VISAKHAPATNAM URBAN  
DEVELOPMENT AUTHORITY.**

**BADU KONDA PETA TO CHELLURU ROAD**

**VISAKHAPATNAM TO VIZIANAGARAM**

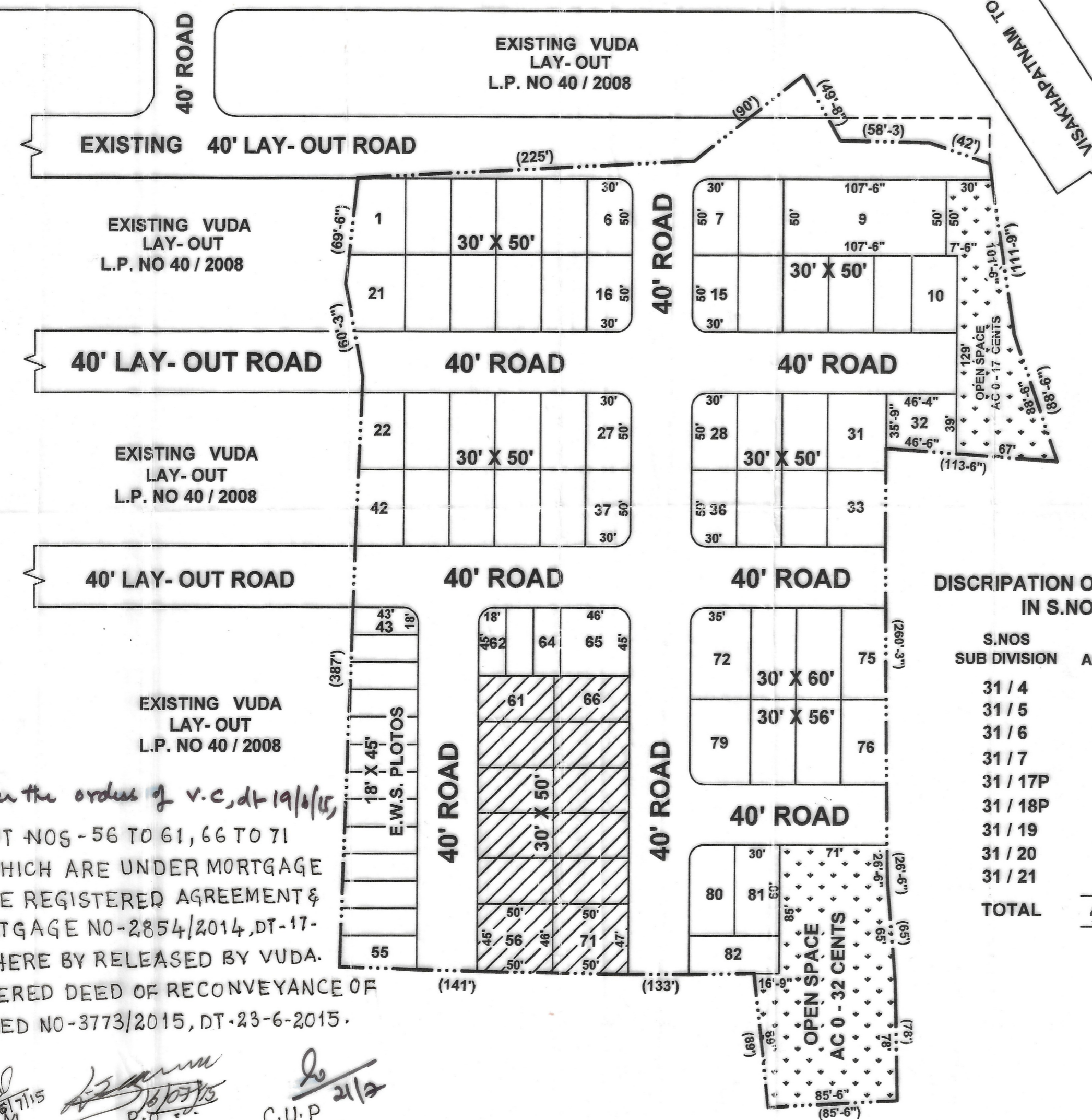

**DISCRIPATION OF LAYOUT  
IN S.NOS**

S.NOS	EXTENT
SUB DIVISION	AC - CENTS
31 / 4	1 - 77
31 / 5	0 - 48
31 / 6	0 - 52
31 / 7	0 - 47
31 / 17P	0 - 13
31 / 18P	0 - 79
31 / 19	0 - 19
31 / 20	0 - 18
31 / 21	0 - 37
<b>TOTAL</b>	<b>4 - 90</b>

**NOTE:** As per the orders of v.c, dt 19/6/15,  
THE PLOT NOS - 56 TO 61, 66 TO 71  
(12 PLOTS) WHICH ARE UNDER MORTGAGE  
TO VUDA, VIDE REGISTERED AGREEMENT &  
DEED OF MORTGAGE NO-2854/2014, DT-17-  
6-2014 ARE HERE BY RELEASED BY VUDA.  
VIDE REGISTERED DEED OF RECONVEYANCE OF  
MORTGAGE DEED NO-3773/2015, DT-23-6-2015.

C. Arul  
16/7/15  
A.D.M.  
P.O.  
C.U.P  
2/12