

**PROPOSED LAYOUT PLAN IN
Sy.Nos:49/6P,7,8,9,10P & 50/3p, 4p, 5p, 6
OF BEJJIPURAM VILLAGE,
LAVERU MANDAL,
SRIKAKULAM DISTRICT.**

BELONGS TO :

Sri N. AMARESHWARA REDDY
S/o. Sri N. VENKATA REDDY



M/s. SATYA SRI NIRMANS

LAND USE ANALYSIS :

SL.NO.	DESCRIPTION	EXTENT Ac. Cts.	PERCENTAGE
1.	PLOTTED AREA (INCLUDING EWS & MIXED LAND USE)	4.10	54.23
2.	ROADS AREA	2.66	35.19
3.	OPEN SPACE AREA	0.80	10.58
TOTAL AREA		7.56	100.00

LOTS DETAIL :

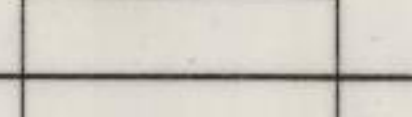
SL.NO.	PLOT SIZE	AREA in Sq.Yds.	No. OF PLOTS
1	33'x120'	440.00	02
2	30'x70'	233.33	03
3	33'x60'	220.00	03
4	33'x55'	201.66	22
5	30'x60'	200.00	04
6	30'x55'	183.33	03
7	30'x50'	166.66	31
8	38'x38'	160.44	13
9	18'x45'	90.00	30
TOTAL			111

-  LAYOUT BOUNDARY
-  PLOTS MORTGAGED TO VUDA
PLOT NOS: 100 to 110 (11 Nos.)
EXTENT: Acs.0.71cts.

AREA STATEMENT

SI. NO	Sy. NO	SUB DIVISION	EXTENT (AC.CTS)
1	49	6P	0.17
		7	0.55
		8	0.76
		9	0.58
		10P	1.01
		3p	0.90
		4p	1.28
		5p	0.60
		6	1.71
TOTAL			7.56

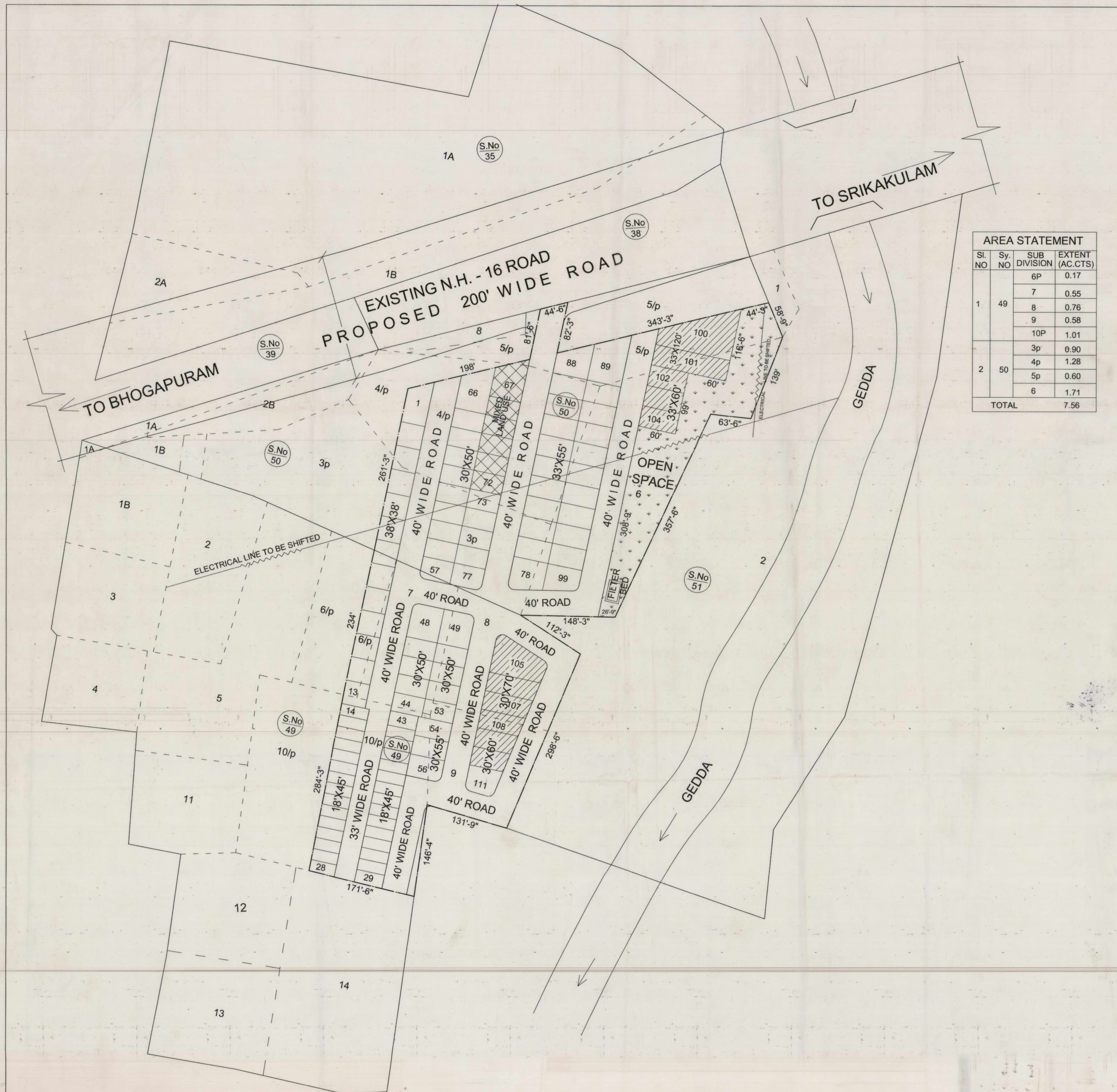

For M/s. SATYA SRI NIRMANS
N. Amareshwara Reddy
Managing Partner

SIGNATURE OF THE OWNER

SCALE = 1" = 66'
FILE Rc.No.7922/2016/L9
L.P.No : 44/2017

K. Ravana Reddy 28/3/17
S/D'MAN

SIGNATURE OF LICENSED SURVEYOR
R. RAMESH
VUDA Licenced Surveyor
Regd. No: 143/2016-15
Visakhapatnam Urban Development Authority
VISAKHAPATNAM
Cell No: 7416763692

SIGNATURE OF
Jr. PLANNING OFFICER
28-3-2017

SIGNATURE OF
Asst. PLANNING OFFICER
28/3/17

SIGNATURE OF
CHIEF URBAN PLANNER
28/3/17

SIGNATURE OF
VICE CHAIRMAN

**VISAKHAPATNAM URBAN
DEVELOPMENT AUTHORITY**