

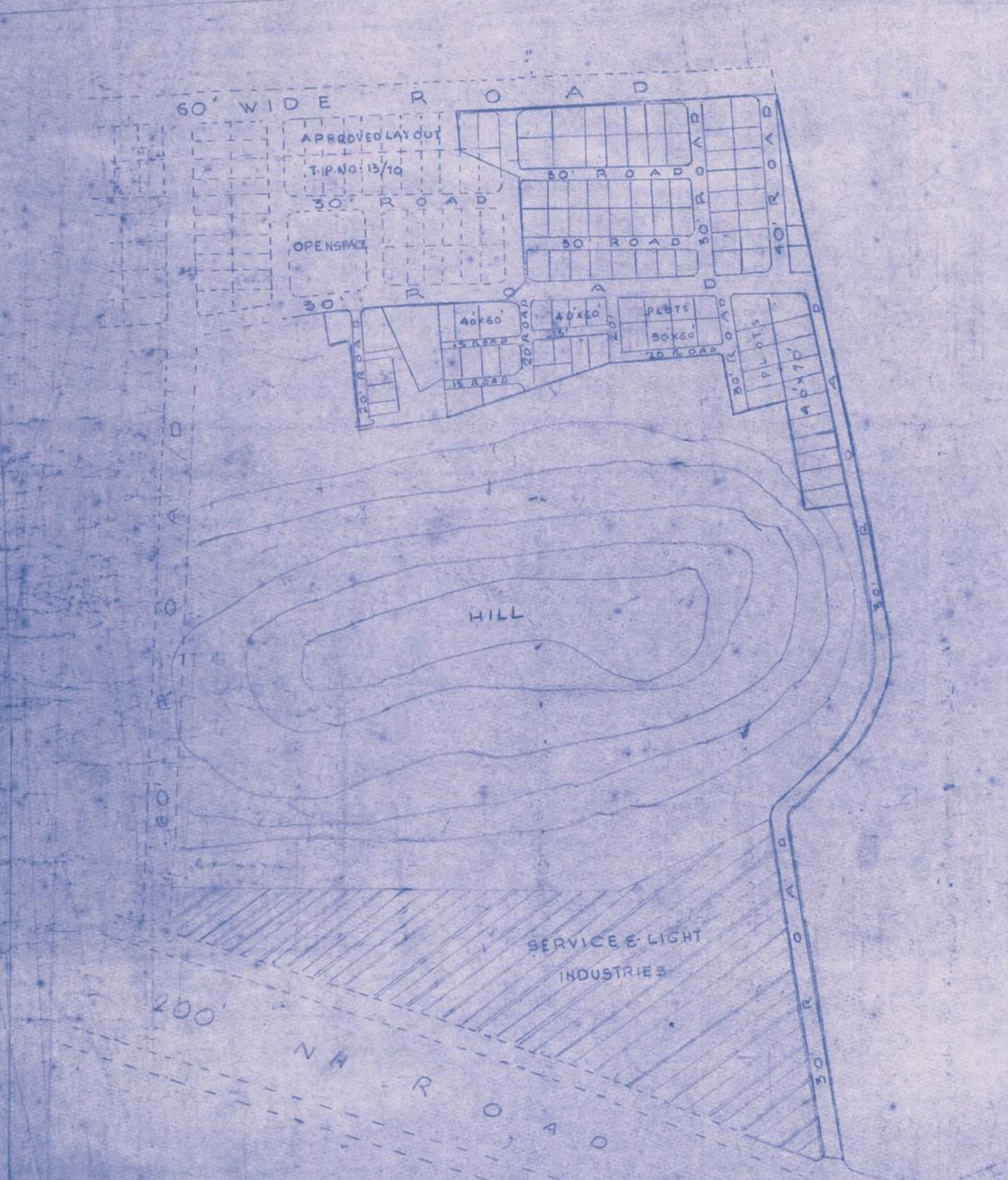

PROPOSED REGULARISED LAY-OUT
 IN S NO: 50/P OF MADHAVADHARA
 AND SNO: 9/P OF KAPARADA

SCALE: 1" = 132'

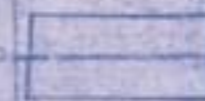

REFERENCE

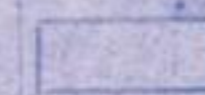
-  BOUNDARY OF REGULARISED LAY-OUT
-  EXISTING ROADS
-  PROPOSED ROADS



L.P. NO: 43/85-VUDA
 FILE R.C. NO: 743/84-FI

[Signature]
 T.P.S.

[Signature]
 CHIEF TOWN PLANNER
 &
 PROJECT DIRECTOR

[Signature]
 J.P.O.

VISAKHAPATNAM URBAN
 DEVELOPMENT AUTHORITY