

2005

PROPOSED LAYOUT FOR
R.K TOWN SHIP PROMOTERS
(P) LTD IN S.NO. 219/P OF
TALLAVALASA VILLAGE BHEE
MUNIPATNAM MANDAL VISA-
KHAPATNAM DISTRICT.

TOTAL EXTENT OF THE LAYOUT AREA AC 7.83
AFFECTED 100-0 ROADPORTION AREA 0.11CT.
NET LAYOUT AREA AC 7.72CT.

LAND USE ANALYSIS

SL.NO.	DESCRIPTION	EXTENT AC-CT	PERCENTAGE
1	PLOTTED AREA	4.45	57.65
2	RODS AREA	2.49	32.25
3	OPEN SPACE AREA	0.78	10.10
TOTAL EXTENT OF LAYOUT		7.72	100.00

LAYOUT BOUNDARY

SL.NO.	SIZE OF PLOTS	NO OF PLOTS
1	50-0 X 90-0	08 NOS
2	30-0 X 60-0	27 NOS
3	35-0 X 55-0	36 NOS
4	36-0 X 50-0	17 NOS
TOTAL NO OF PLOTS		88 NOS

NOTE:  LAND TO BE ACQUIRED/EXCHANGE TO GET FORM FULL PLOTS. (NOT TO BE BUILT PLOTS)

SCALE. 1" = 66'-0"
FILE. RC.NO. 553/2000G,
L.P. NO. 5/2002

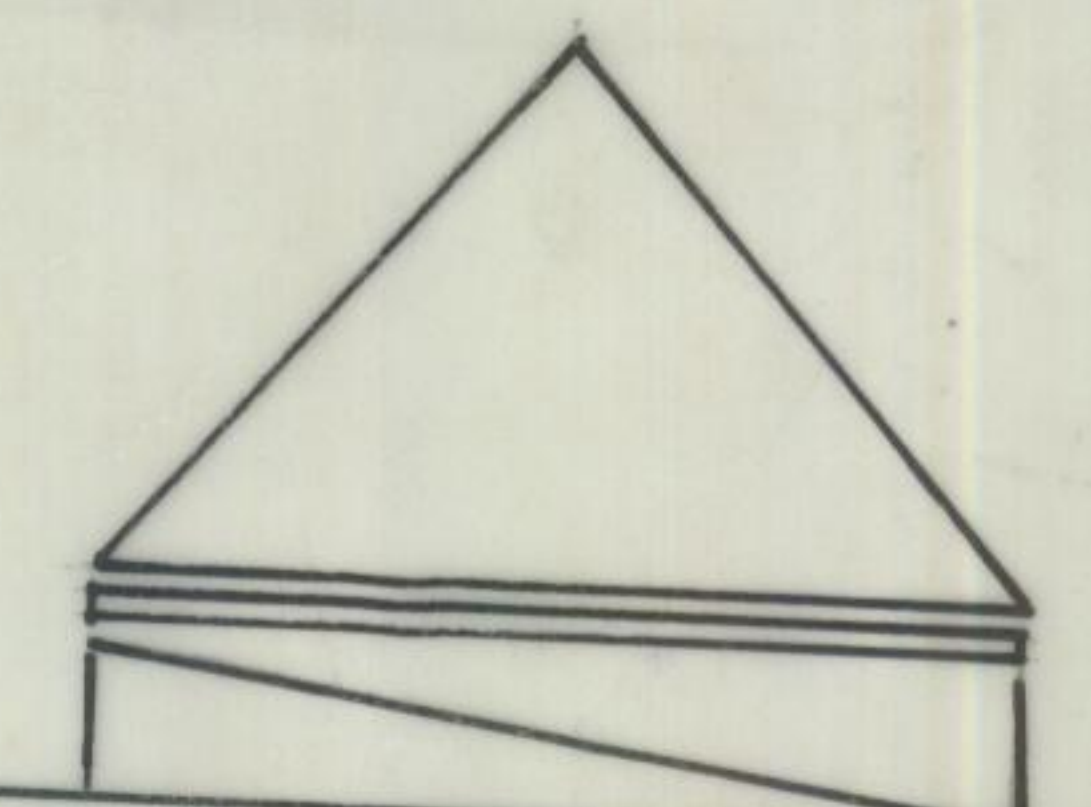

G. Sundar
T.P.S. 27/12/2001

[Signature]
CHIEF PLANNING OFFICER

[Signature]
JUNIOR PLANNING OFFICER

[Signature]
ASST PLANNING OFFICER

[Signature]
VICE-CHAIRMAN

VISAKHAPATNAM URBAN
DEVELOPMENT AUTHORITY

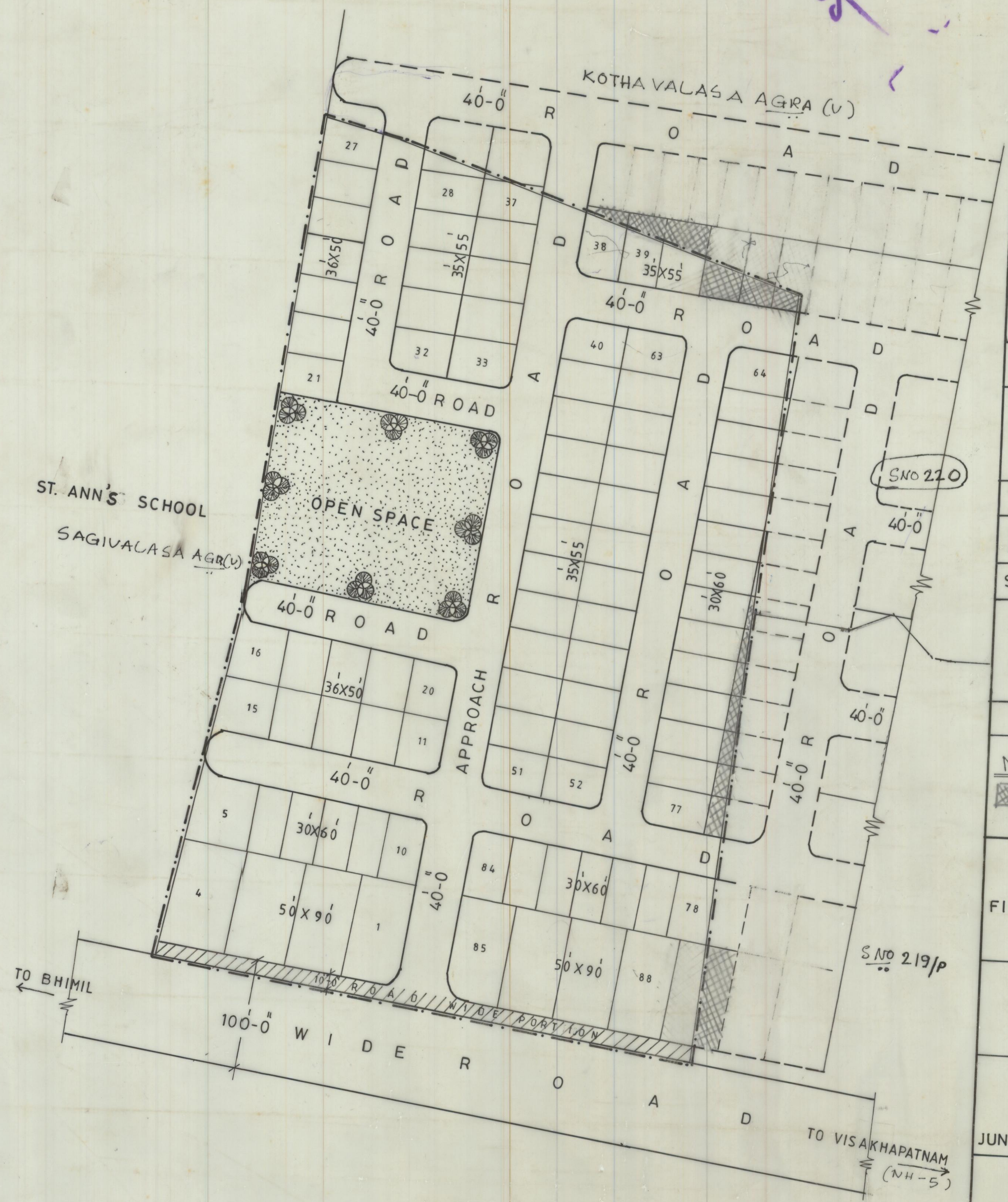

ST. ANN'S SCHOOL
SAGIVALASA AGR(V)

SNO 219/P

SP