

PROPOSED LAYOUT PLAN FOR RESIDENTIAL PLOTS IN S.NOS 39/2P; & 40/1P,2P,3P OF RELI VILLAGE, KOTHAVALASA -MANDAL, VIZIANAGARAM-DIST.

DESCRIPTION OF LAYOUT IN SNOS	
S.NO	EXTENT
39/2p	5.85
40/1p	1.08
40/2p	3.86
40/3p	1.41

TOTAL EXTENT AC 12.20 CTS
 BELONGING TO
Sri. SREEMITRA TOWNSHIPS (P) LTD

LAND USE ANALYSIS :-

S.NO.	DESCRIPTION	EXTENT ACs.	PERCENTAGE
1.	PLOTTED AREA	6.52	53.45 %
2.	ROADS AREA	4.46	36.55 %
3.	OPEN SPACE AREA	1.22	10.00 %
TOTAL AREA		12.20	100.00 %

LOTS DETAILS :-

SL.NO.	LOT SIZE	PLOTTED AREA IN Sq Yds	NO. OF PLOTS
1	30' X 66'	220.00	10
2	30' X 65'	216.66	11
3	30' X 60'	200.00	105
4	30' X 50' (LI)	166.66	10
5	18' X 45' (EWS)	90.00	35
6	18' X 30' (EWS)	60.00	04
TOTAL PLOTS		60.00	175

PROPOSED LAYOUT BOUNDARY.
 APPROVED LAYOUT

FILE RC.NO: 6379/2012
 L.P.NO:51/2013
 PLOTS MORTGAGED TO VUDA
 PLOT Nos.: 102 to 124
 TOTAL PLOTS 23
 EXTENT : AC 1.00 CTS

SCALE : 1" = 66'-0"

For Sreemitra Townships (P) Ltd
 Managing Director
 OWENERS SIG. V.
 LICENCED SURVEYOR

Chief Urban Planner

Planning Officer
 VISAKHAPATNAM URBAN DEVELOPMENT AUTHORITY

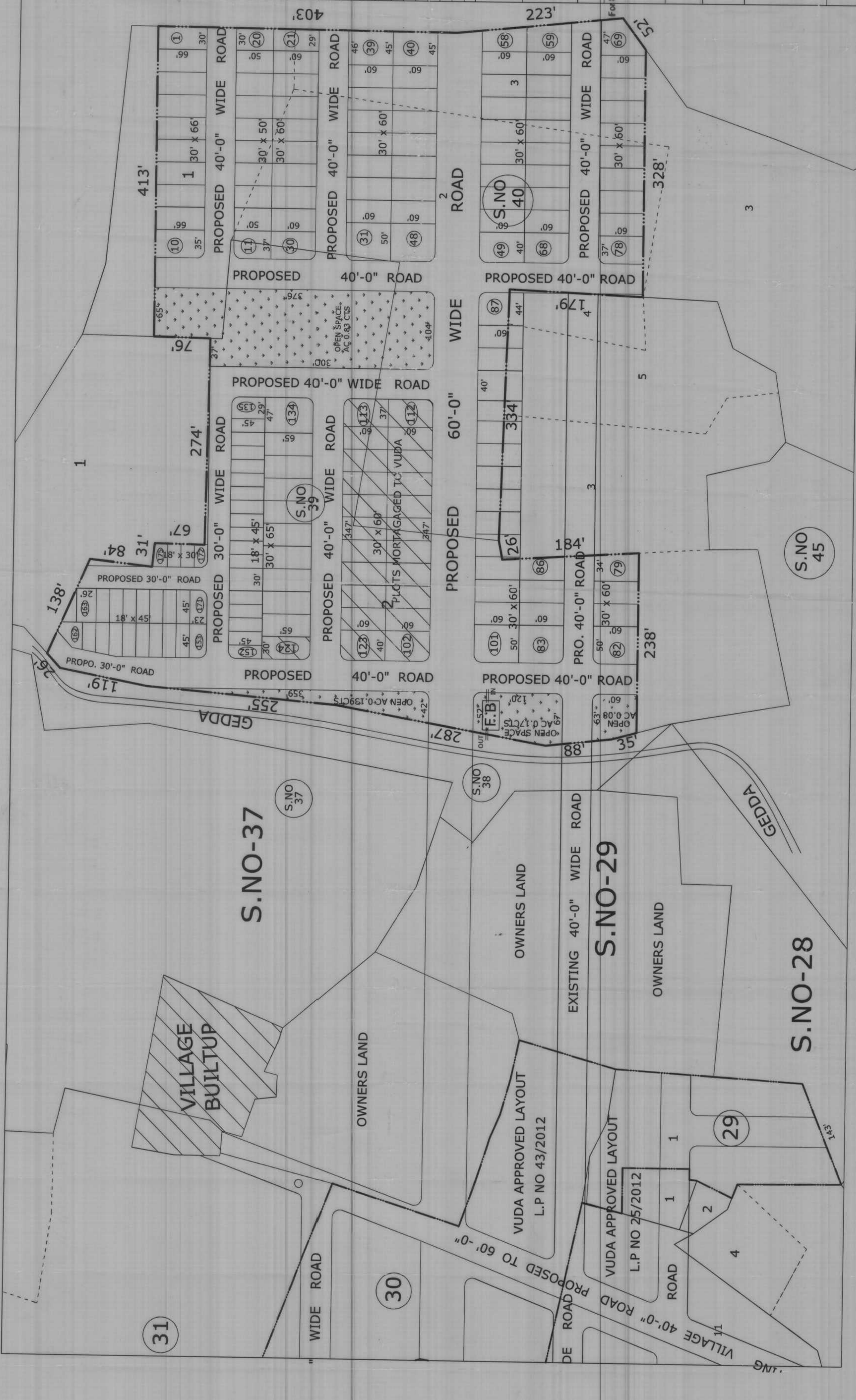

S.NO-37

S.NO-29

S.NO-28

31

30

29

S.NO 45

S.NO 40

S.NO 39

S.NO 38

S.NO 37

138'

179'

179'

179'

179'

179'

179'

179'

179'

179'

179'

179'

179'

179'

179'

179'

179'