

PLAN SHOWING THE REVISED LAYOUT IN R.S.NO.101P, 102P, 103P,104P OF JAGGARAJUPETA VILLAGE , GAJUWAKA MANDAL VISAKHAPATNAM Dt.,

Belongs to :- S T B L PROJECTS Ltd.

PROPOSED LAND USE ANALYSIS :-

SL.NO.	DESCRIPTION	EXTENT IN Acs.-cts.	PERCENTAGE
1	PLOTTED AREA INCLUDING EWS(10%)	6.80	55.60
2	COMMERCIAL AREA	0.06	0.50
3	ROADS AREA	4.11	33.60
4	OPEN SPACE	1.26	10.30
TOTAL AREA		12.23	100 %

PLOTS DETAIL :-

SL.NO.	PLOT SIZE	PLOT AREA IN Sq. yds.	NO. OF PLOTS	SURVEY NO	EXTENT	SURVEY NO	EXTENT
1	30 x 40(AVERAGE)	133.33	24	102/58	0.06	102/24	0.19
2	30x45	170.00	11	102/6	0.33	103/1	0.40
3	30 x 50(AVERAGE)	166.66	19	102/7	0.10	103/2	0.16
4	36 x 40	160.00	07	102/8	0.29	104/1	0.67
5	36 x 50	200.00	11	102/9	0.27	104/2	0.17
6	36 x 55	220.00	16	102/10	0.26	104/3	1.54
7	36 x 60(AVERAGE)	240.00	13	102/11	0.48	104/4	0.32
8	36 x 65(AVERAGE)	260.00	10	102/12	0.45	104/5	0.22
9	40 x 40	177.77	04	102/13	0.24	104/6	0.84
10	40 x 45	200.00	02	102/14	0.41	104/8	0.40
11	40 x 50	222.22	04	102/15	0.16	104/9	0.30
12	40 x 55	244.44	04	102/16	0.22	101/1B2	0.13
13	40 x 60	266.66	16	102/17	0.16	101/1C	0.30
				102/18	0.46	101/1D	0.33
14	30x60	200.00	10	102/19	0.27	101/1E	0.35
15	30x55	188.33	10	102/20	0.30	101/1F	0.36
16	36x63	252.00	05	102/21	0.18	101/2	0.10
17	40 x 25	111.11	02	102/22	0.13	101/3	0.31
18	18 x 47 (EWS)	94.00	10	102/23	0.08	101/4	0.29
TOTAL NO. OF PLOTS			178	TOTAL EXTENT		AC 12.23	

PREVIOUS LAYOUT AREA AC 9.64 L.P.NO.16/2010
 PROPOSED LAYOUT BOUNDARY
 PLOTS MORTGAGED TO VUDA (15% ON PLOTTED AREA AC 108) PLOT NOS 56 TO 61, 69 TO 73, 96 TO 99, 122 TO 129 AND 141 TO 146 (29 PLOTS) WHICH ARE UNDER MORTGAGEMENT TO VUDA VIDE REGISTERED AGREEMENT & DEED OF MORTGAGED NO. 2952/2010 Dt. 28.7.2010 AND 1240/2013 Dt. 2.4.13 ARE HEREBY RELEASED BY VUDA VIDE REGISTERED DEED OF RELINQUISHMENT MORTGAGAGE NO. 4724/2015 Dt. 15.10.2015 AND 4725/2015 Dt. 15.10.2015.

OWNER'S SIGN
 STBL PROJECTS LTD.
 AUTHORIZED SIGNATURE

SCALE : 1" = 60'-0"
 FILE R.C.No: 9880/2010
 L.P.NO : 16/2013

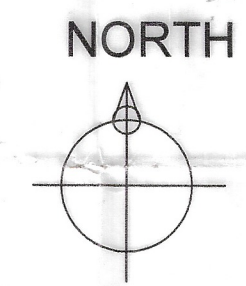

LICENSED SURVEYOR
 G. HARI RAO D.S.
 25-3-13

THIS REVISES L.P.NO: 16/2010

ADM
 25-3-13

Planning officer

Chief urban planner

Vice-Chairman

VISAKHAPATNAM URBAN DEVELOPMENT AUTHORITY

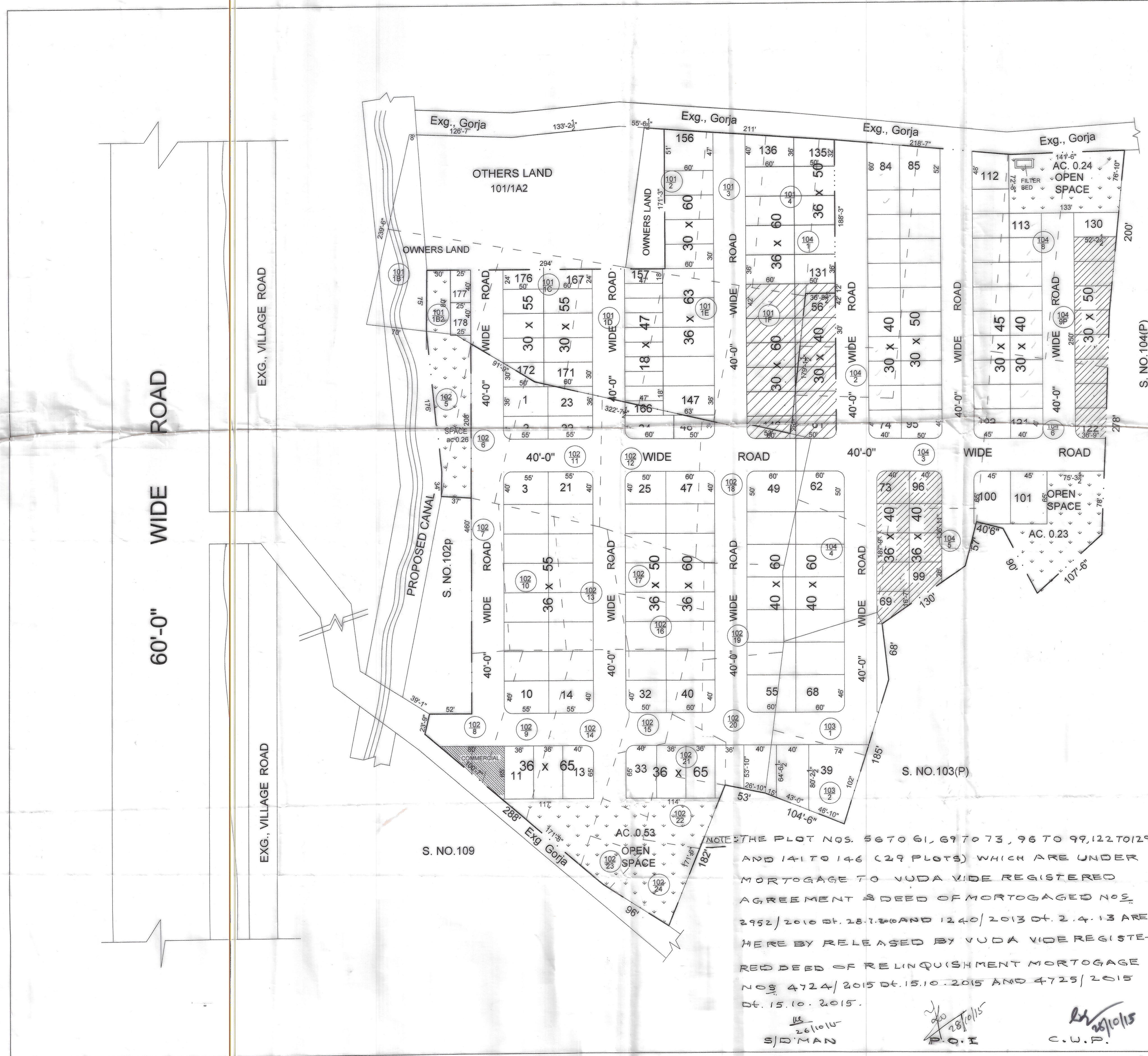

NOTE: THE PLOT NOS. 56 TO 61, 69 TO 73, 96 TO 99, 122 TO 129, AND 141 TO 146 (29 PLOTS) WHICH ARE UNDER MORTGAGEMENT TO VUDA VIDE REGISTERED AGREEMENT & DEED OF MORTGAGED NO. 2952/2010 Dt. 28.7.2010 AND 1240/2013 Dt. 2.4.13 ARE HEREBY RELEASED BY VUDA VIDE REGISTERED DEED OF RELINQUISHMENT MORTGAGAGE NO. 4724/2015 Dt. 15.10.2015 AND 4725/2015 Dt. 15.10.2015.

S.D. MAN
 26/10/15
 P.O. I
 28/10/15
 C.U.D.
 25/10/15