

As per the order of the court.

NOTE:- THE PLOT NOS. 41 TO 43 (3 PLOTS) WHICH ARE UNDER MORTGAGE TO VUDA, VIDE REGISTERED AGREEMENT AND DEED OF MORTGAGE NO-4923/2013, DT-2-12-2013 ARE HERE BY RELEASED BY VUDA VIDE REGISTERED DEED OF RE-CONVEYANCE OF MORTGAGE DEED NO-6570/2015, DT-7-8-2015.

A.D.M
J.P.O

J.P.O

C.U.P

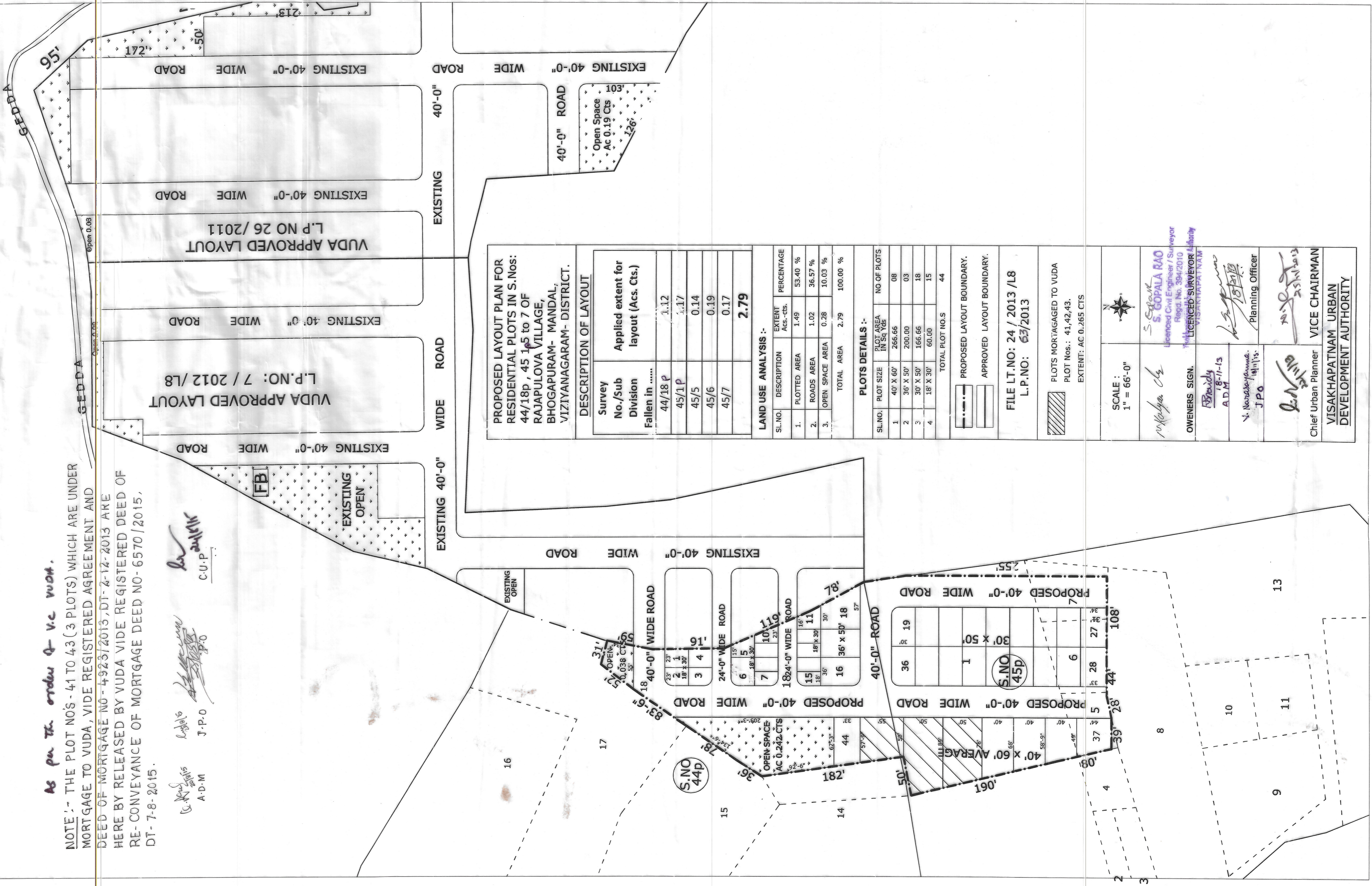

VUDA APPROVED LAYOUT
L.P.NO: 7 / 2012 / L8

EXISTING 40'-0" WIDE ROAD

VUDA APPROVED LAYOUT
L.P NO 26 / 2011

EXISTING 40'-0" WIDE ROAD

EXISTING 40'-0" WIDE ROAD

EXISTING 40'-0" WIDE ROAD

EXISTING 40'-0" WIDE ROAD

PROPOSED LAYOUT PLAN FOR RESIDENTIAL PLOTS IN S.Nos: 44/18p, 45 15 to 7 OF RAJAPULOVA VILLAGE, BHOGAPURAM- MANDAL, VIZIYANAGARAM- DISTRICT.

DESCRIPTION OF LAYOUT		Applied extent for layout (Ac. Cts.)
Survey No./Sub Division	44/18P	1.12
45/1P	1.17	
45/5	0.14	
45/6	0.19	
45/7	0.17	
		2.79

LAND USE ANALYSIS :-

SL.NO.	DESCRIPTION	EXTENT Ac.-cts.	PERCENTAGE
1.	PLOTTED AREA	1.49	53.40 %
2.	ROADS AREA	1.02	36.57 %
3.	OPEN SPACE AREA	0.28	10.03 %
TOTAL AREA		2.79	100.00 %

PLOTS DETAILS :-

SL.NO.	PLOT SIZE	PLOT AREA IN SQ Yds	NO OF PLOTS
1	40' X 60'	266.66	08
2	36' X 50'	200.00	03
3	30' X 50'	166.66	18
4	18' X 30'	60.00	15
TOTAL PLOT NOS			44

PROPOSED LAYOUT BOUNDARY.
APPROVED LAYOUT BOUNDARY.

FILE LT.NO: 24 / 2013 / L8
L.P.NO: 63/2013

PLOTS MORTGAGED TO VUDA
PLOT Nos.: 41,42,43.
EXTENT: AC 0.265 CTS

SCALE : 1" = 66'-0"



OWNERS SIGN.
S. GOPALA RAO
Licenced Civil Engineer / Surveyor
Regd. No. 394/2010
LICENCED SURVEYOR Authority
VIZIYANAGARAM

Chief Urban Planner
J.P.O

Planning Officer

Chief Urban Planner
VICE CHAIRMAN

VISAKHAPATNAM URBAN DEVELOPMENT AUTHORITY