

PROPOSED LAY-OUT IN S.No. 91/4 AND 6 PART. OF CHINAMUSHIDIVADA VILLAGE, PENDURTI MANDALAM, VISAKHAPATNAM  
 OWNER: SRI N.V.R.K. SURYA CHANDRA RAO

LAND USE ANALYSIS:

SLNO.	DESCRIPTION	EXTENT	PERCENTAGE
1.	PLOTTED AREA	0.66	76.65%
2.	ROADS AREA	0.19	23.35%
TOTAL		0.85	100.00%

SLNO.	SIZE OF PLOTS	NO. OF PLOTS
1.	40'0" X 60'0"	12 Nos.
TOTAL		12 Nos.

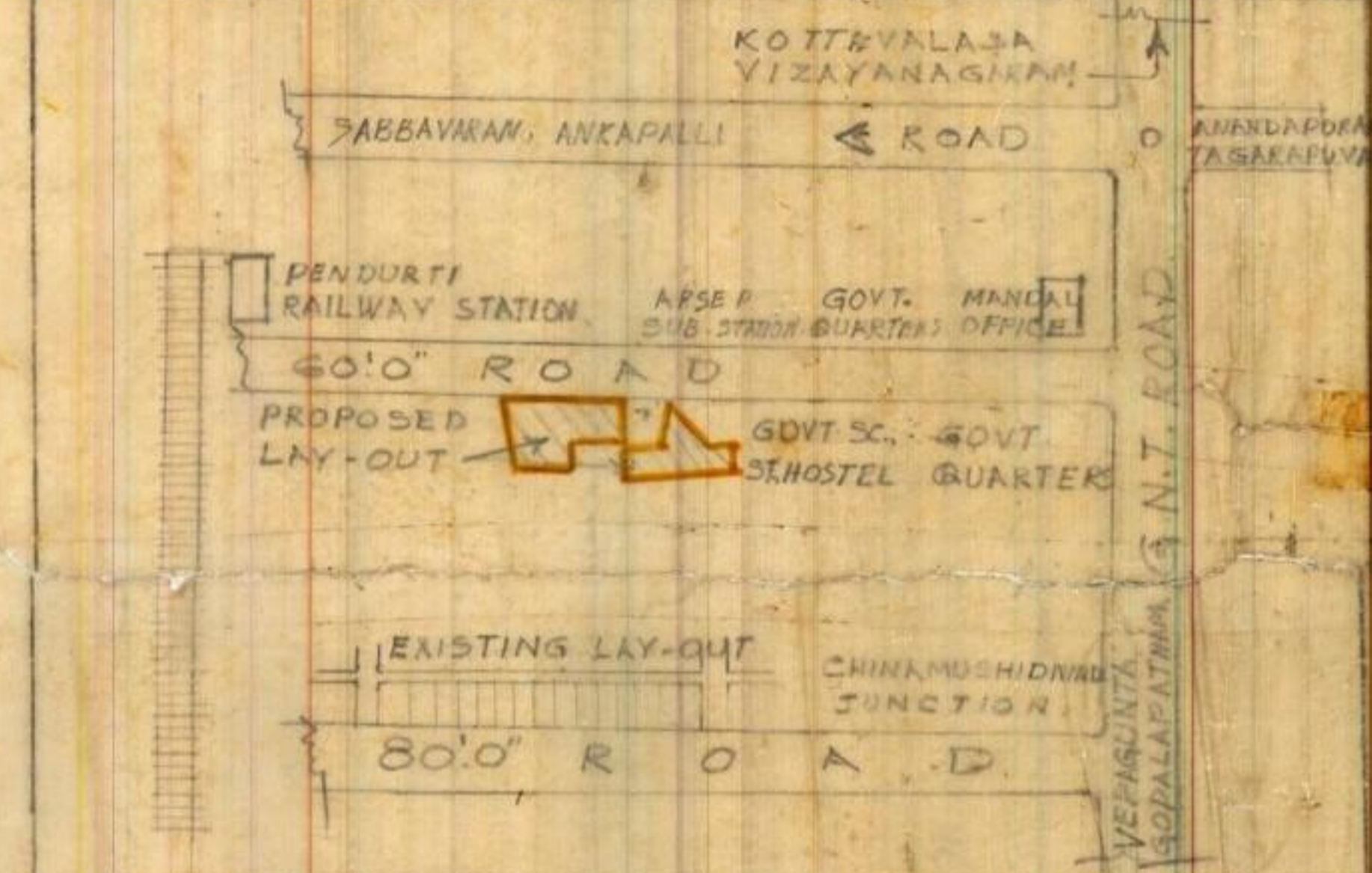

LAY-OUT BOUNDARY  
 SCALE: 1" = 60'0"  
 FILE R.C. NO. 3154/89  
 L.P.No.: 7/89

Ch. Kiranandam  
 ADM  
 W. Narasimha Rao  
 JPO  
 11/1/89  
 C.T.P & P.D/O  
 VICE CHAIRMAN

VISAKHAPATNAM URBAN DEVELOPMENT AUTHORITY

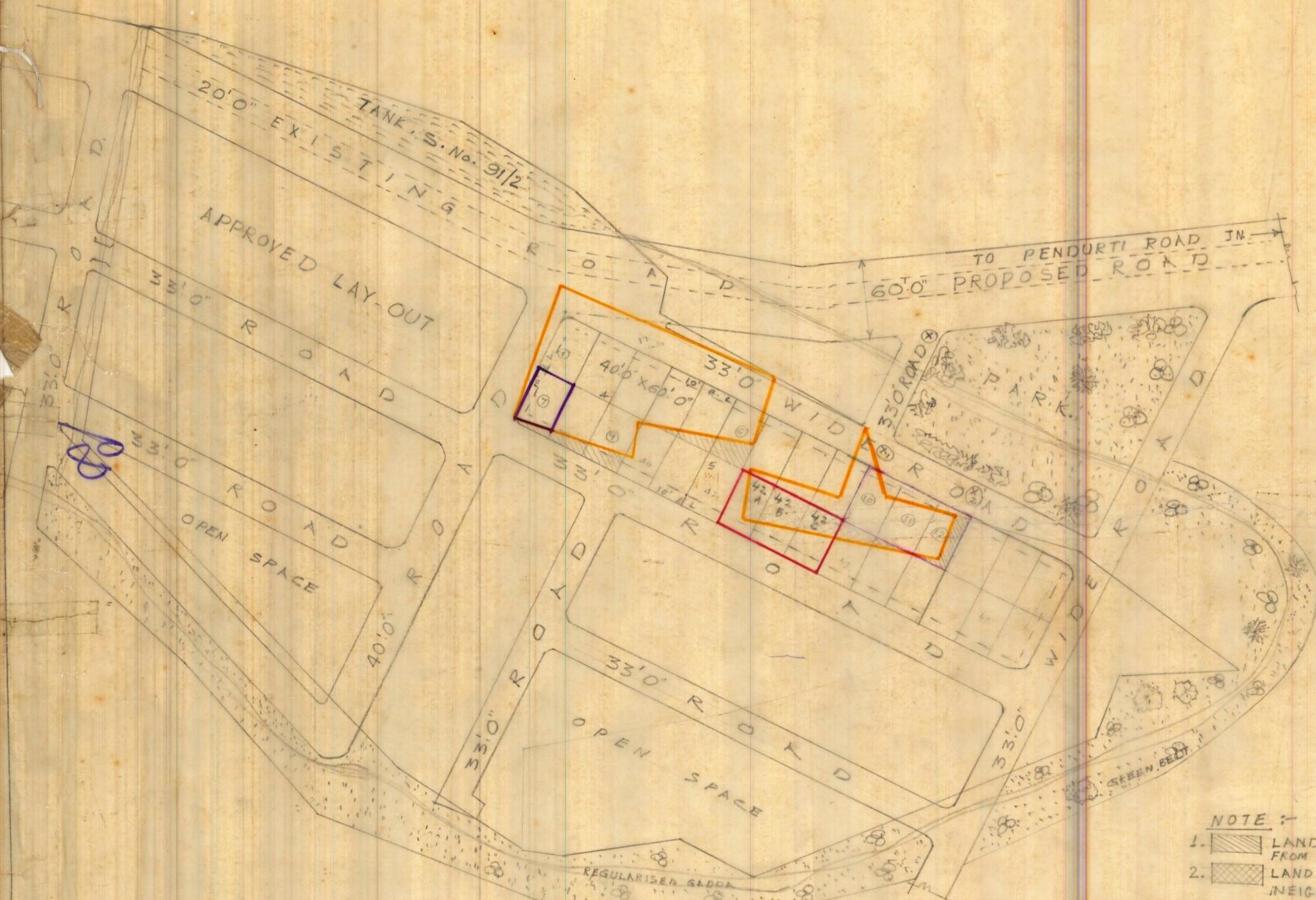

- NOTE :-
- LANDS TO BE PURCHASED FROM NEIGHBOURS.
  - LAND TO BE SOLD TO NEIGHBOURS.

NOTE :-  
 PLOT NO. 7 (SEVEN) IS MORTGAGED TO VUDA FOR STREET LIGHTING. PARTY SHOULD NOT SELL THESE PLOTS UNTIL AND UNLESS ELECTRICITY IS PROVIDED

NOTE  
 PLOT NOS 42A, 42B, 42c COMES UNDER LPNO 17/89  
 AS PER THE ORDERS OF CPO IN FILE R.C NO. 2400/8964 (APPEAL LAYOUT CONDITIONS)

Handwritten signatures and initials at the bottom of the page.