

REVISED LAYOUT FOR S-NOS 67/PARTS 1A,B,C,D, 2A,B,3 TO 5 AND 7 TO 9 OF BAKKANAPALEM VILLAGE OF VISAKHAPATNAM DISTRICT BELONGS TO S.E. RAILWAY OFFICERS CO-OP HOUSE BUILDING SOCIETY Ltd. WALT AIR REGD NO.103

LAND USE ANALYSIS

SL.NO.	DESCRIPTION	EXTENT AC-CT	PERCENTAGE
1.	PLOTTED AREA	3.28	53.25
2.	ROADS AREA	1.65	29.11
3.	OPEN SPACE AREA	0.605	18.33
TOTAL EXTENT OF LAYOUT		5.535	100.00

— LAY-OUT BOUNDARY

SL.NO.	SIZE OF PLOTS	NO OF PLOTS
1.	40'-0" X 60'-0"	20 NOS.
2.	45'-0" X 60'-0"	36 NOS.
TOTAL NO OF PLOTS		56 NOS.

LAYOUT APPROVED AS PER G.O RT NO 1408 M.A D/17-290

▨ LANDS TO BE ACQUIRED TO CONSTITUTE FULL PLOTS AND TO GET APPROACH

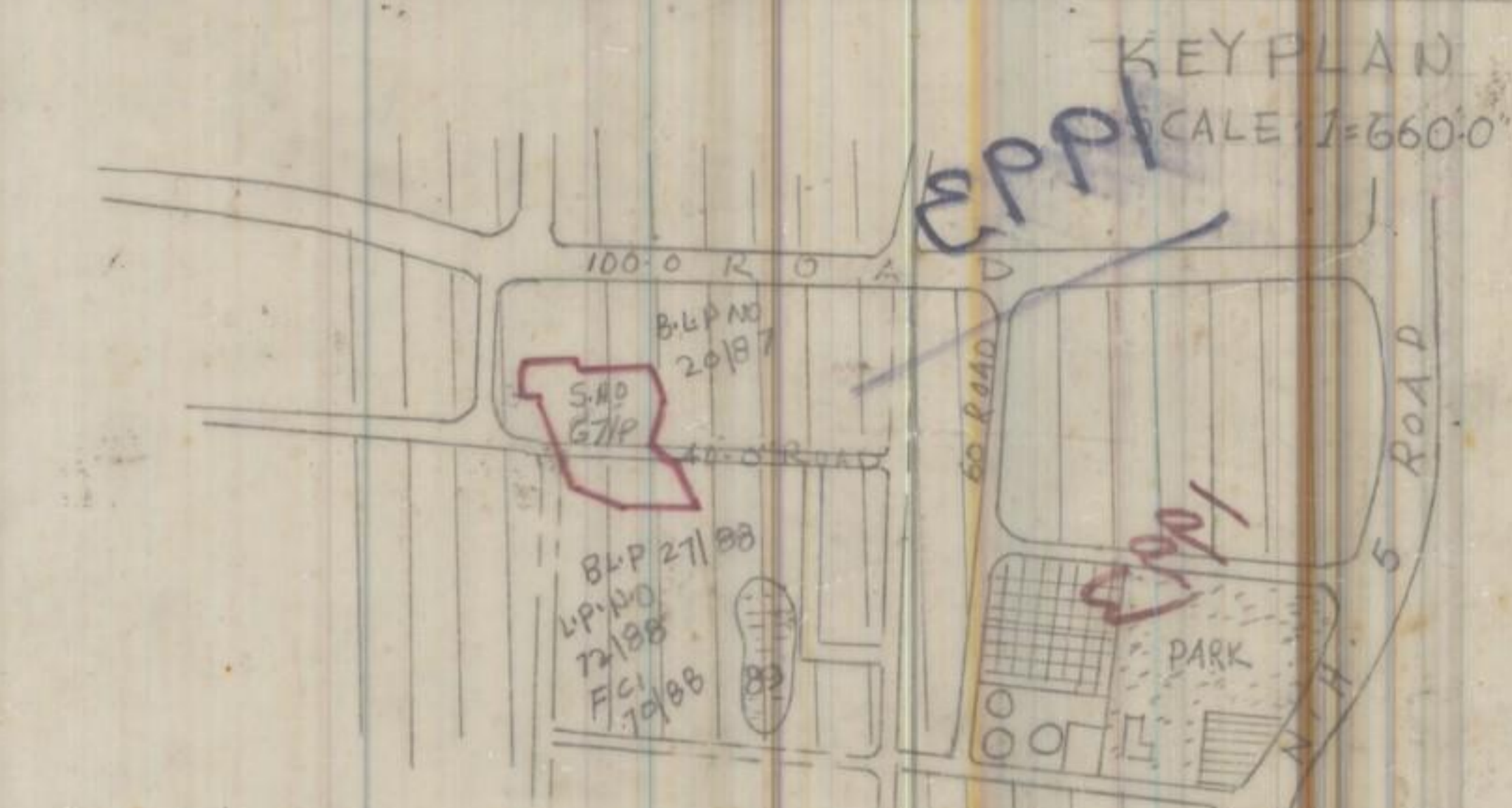

LAY OUT APPROVED AS PER G.O RT. NO. 1408 M.A OF 17-12-90.

SCALE: 1"=66'-0"
FILE: RC-NO 838/89H3
L.P. NO. 7/93

A. Ramasubramanian
A.D.M.

CHIEF PLANNING OFFICER

JUNIOR PLANNING OFFICER

ASST. PLANNING OFFICER

VICE CHAIRMAN

VISAKHAPATNAM URBAN DEVELOPMENT AUTHORITY

