

LAY-OUT FOR S.NO: 46/9A,
9B, 9c, 16 & 17 OF CHINAMUSHI
DIWADA VILLAGE,
PENDURTI MANDAL.

L.P.NO: 64/87

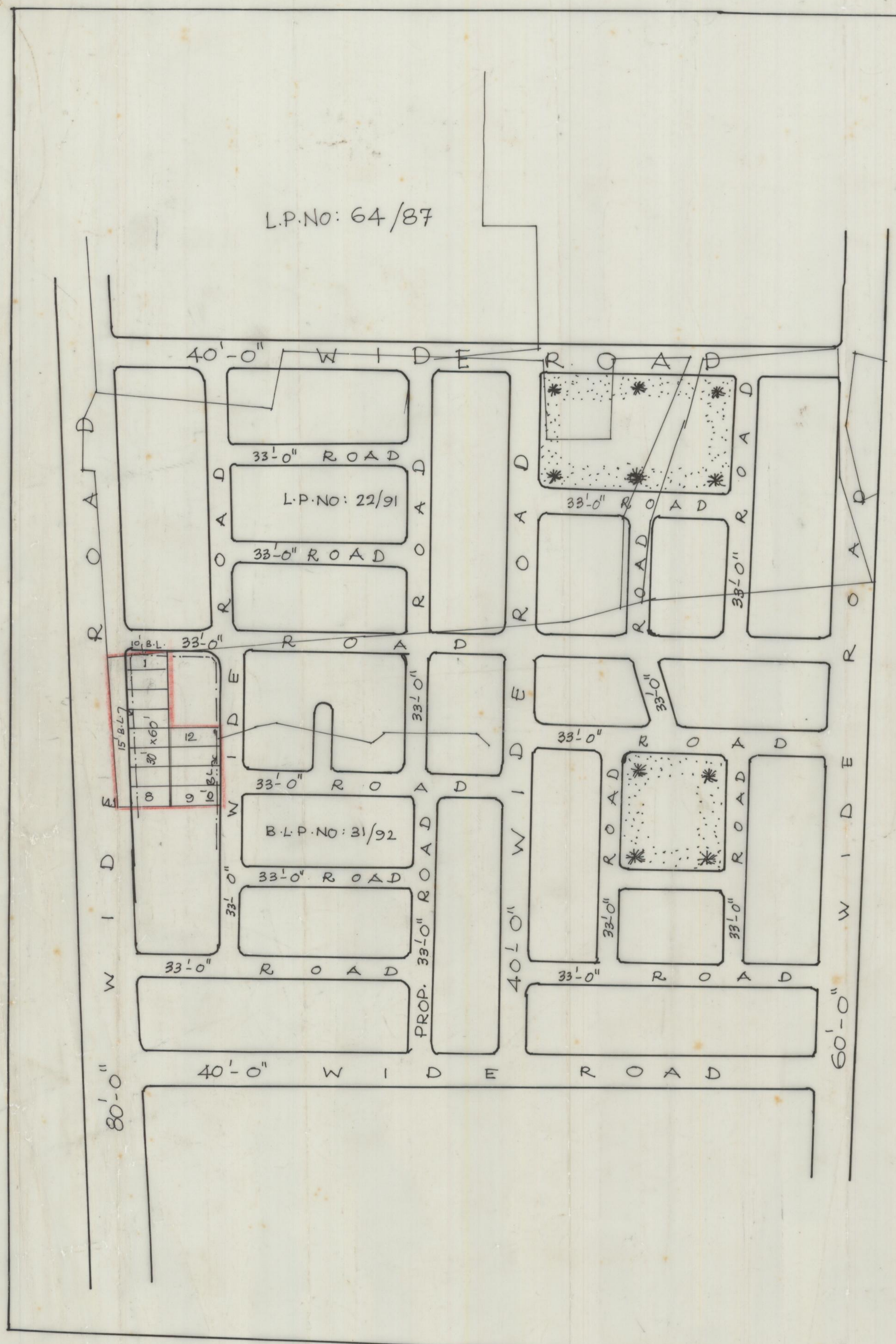

LAND USE ANALYSIS:

S.NO:	DESCRIPTION	Extent ACS - Cents	PERCENTAGE
1.	PLOTTED AREA	0.47	74.61%
2.	ROADS AREA	0.16	25.39%
3.	OPEN SPACE	—	—
TOTAL		0.63	100.00%

SCALE: 1"=132'-0"
FILE RC-NO: 1521/93G2
L.P. NO: 7/96
VUDA R NO: 463
DT. 26-12-93



LAY-OUT BOUNDARY

SIZE OF THE PLOT : 30' x 60'
TOTAL NO. OF PLOTS: 12

<i>Popal</i> 24/4/96 T.P.S.	<i>W.M.J.</i> 25/4/96 PLANNING OFFICER
G.Kamleshwari 24/4/96 J.P.O.	<i>Santhosh</i> 25/4/96 CHIEF PLANNING OFFICER
<i>John - y - zansse</i> 24/4/96 Asst. planning officer	<i>Praveen</i> VICE-CHAIRMAN

URBAN DEVELOPMENT
AUTHORITY VISAKHAPATNAM.