



REVISED HOUSING SCHEME
LAYOUT IN S.No: 16p, 17p OF
JAGGARAJUPETA VILLAGE
GAJUWAKA MANDAL,
VISAKHAPATNAM DISTRICT.

BELONGS TO: **STBL** Projects Limited.

LAND USE ANALYSIS :-			
SL.NO.	DESCRIPTION	EXTENT IN	PERCENTAGE
1.	PLOTTED AREA	2.00	57.63%
2.	COMMERCIAL AREA	0.05	1.44%
3.	ROADS AREA	1.06	30.54%
4.	OPEN SPACE AREA	0.36	10.37%
TOTAL AREA		3.47	100.00 %

PLOT DETAILS :-			
SL.NO.	PLOT SIZE	PLOT AREA IN Sq. yds.	NO. OF PLOTS
1.	30' x 50'	166.66	23
2.	30' x 45' (Average)	150.00	14
3.	34' x 55' (Average)	207.77	06
4.	36' x 45' (Average)	180.00	09
5.	30' x 55'	183.33	03
6.	40' x 80' (Average)	355.55	01
7.	45' x 90' (Average)	450.00	02
8.	COMMERCIAL PLOT	228.66	01

TOTAL NO. OF PLOTS 59

-  LAYOUT BOUNDARY
-  PLOTS ALREADY MORTGAGED TO VUDA
5% ON PLOTTED AREA
PLOT Nos. 29 TO 32 No. of UNITS-4
- DELETED PLOT NOS. - 1 TO 9; AREA : Ac.0.50 Cents

For STEL PROJECTS LIMITED

Managing Director

G. HARI BABU
LICENCED SURVEYOR
Licence No. 379/2010
Urban Development Authority
LICENCED SURVEYOR.
Cell: 9781896111

OWNER'S SIGN.

SCALE : 1" = 66'-0"
FILE R.C. No: 232/09/L2
L.P.No: 74/2014
THIS REVISED L.P.No-18/2009

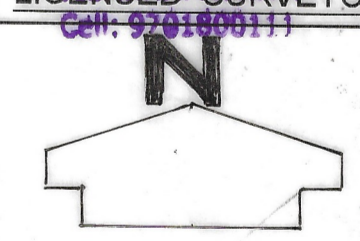

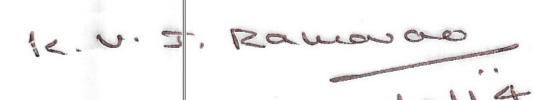
S/D' MAN. 4/3/14

9/4/14
CHIEF URBAN PLANNER

PLANNING OFFICER - I

15/4/2014
VICE-CHAIRMAN

VISAKHAPATNAM URBAN
DEVELOPMENT AUTHORITY

AREA STATEMENT			
S.No.	SURVEY No.	EXTENT AS PER DOCUMENT in Ac. Cents	EXTENT APPLIED in Ac. Cents
1	16/7	0.96	0.46
2	16/8	0.07	0.07
3	16/9	0.19	0.19
4	16/10	0.11	0.11
5	16/11	0.21	0.21
6	16/12	0.29	0.29
7	16/13	0.24	0.24
8	16/14	0.22	0.22
9	16/15	0.18	0.18
10	16/16	0.16	0.16
11	17/1	0.34	0.34
12	17/2	0.35	0.35
13	17/6	0.68	0.14
14	17/8	0.29	0.27
15	17/9	0.30	0.15
16	17/10	0.19	0.04
17	17/13	0.31	0.03
18	17/14	0.56	0.02
TOTAL EXTENT		5.15	3.47

