

**PROPOSED LAYOUT PLAN FOR RESIDENTIAL PLOTS IN S.Nos:39/1P,3P OF**

**PANDALAPAKA - VILLAGE ANANDAPURAM - MANDAL, VISAKHAPATNAM - DISTRICT.**  
 Belongs to: G.LATCHIRAJU & others

LAND USE ANALYSIS :-		
SL. NO.	DESCRIPTION	EXTENT Ac.-cts. PERCENTAGE
1.	PLOTTED AREA	1.69 } 59.93 %
2.	AMENITIES AREA	0.06
3.	ROADS AREA	0.875
4.	OPEN SPACE AREA	0.295
TOTAL AREA		2.920 100.00 %

AREA STATE MENT		
S.NO:	EXTENT	
39/1P	2.46	
39/3P	0.46	
TOTAL	AC 2.92 CTS	

PLOTS DETAILS :-		
SL.NO.	PLOT SIZE	PLOT AREA IN Sq Yds NO OF PLOTS
1	60' X 120'	800.00 02
2	55' X 127'	776.11 01
3	60' X 100'	666.66 05
4	60' X 65' (Amenities)	433.33 02
5	40' X 50'	222.22 04
6	30' X 50'	166.66 07
7	18' X 45' (EWS)	90.00 11
TOTAL PLOTS		32

PROPOSED LAYOUT BOUNDARY

SCALE :- 1" = 66'-0"

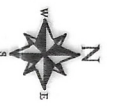

FILE R.C.No: 3246/2015/L6  
 L.P.No: 74/2015

PLOTS MORTGAGE TO VUDA  
 PLOT NO'S : 29 & 31  
 NO. OF PLOTS: 2  
 AREA: AC 0.27 CTS

*G. Latchiraju*  
 H. Lakshmi NARAYANA  
 Vuda Licenced Civil Engineer / Surveyor  
 Regd. No. 104/2015-2018  
 Visakhapatnam Urban Development Authority  
 VISAKHAPATNAM  
 Ph : 7093144567

OWNERS SIGN.  
 LICENCED SURVEYOR

Slps man  
 Chief Urban Planner

VICE CHAIRMAN  
 VISAKHAPATNAM URBAN DEVELOPMENT AUTHORITY

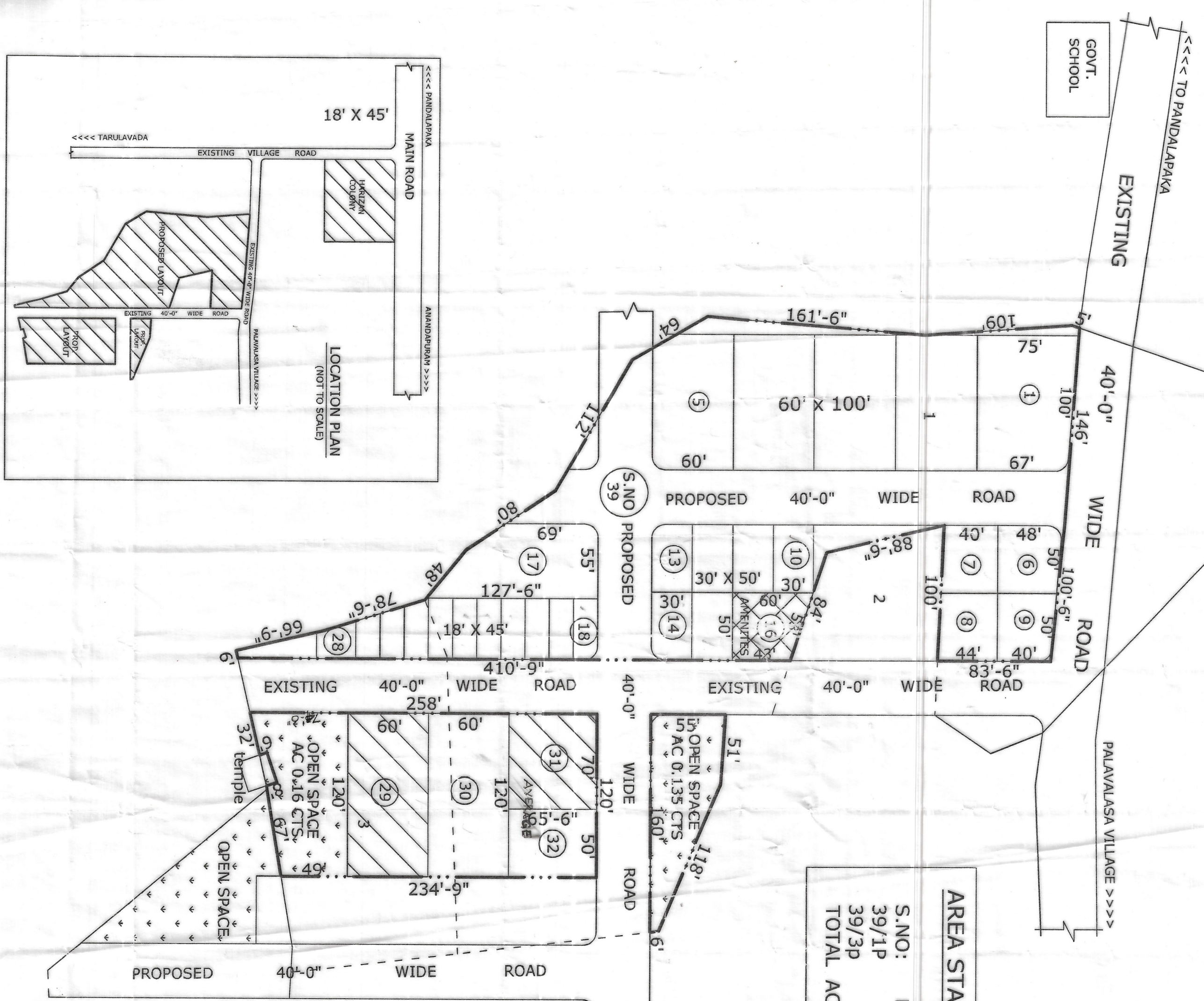

LOCATION PLAN (NOT TO SCALE)

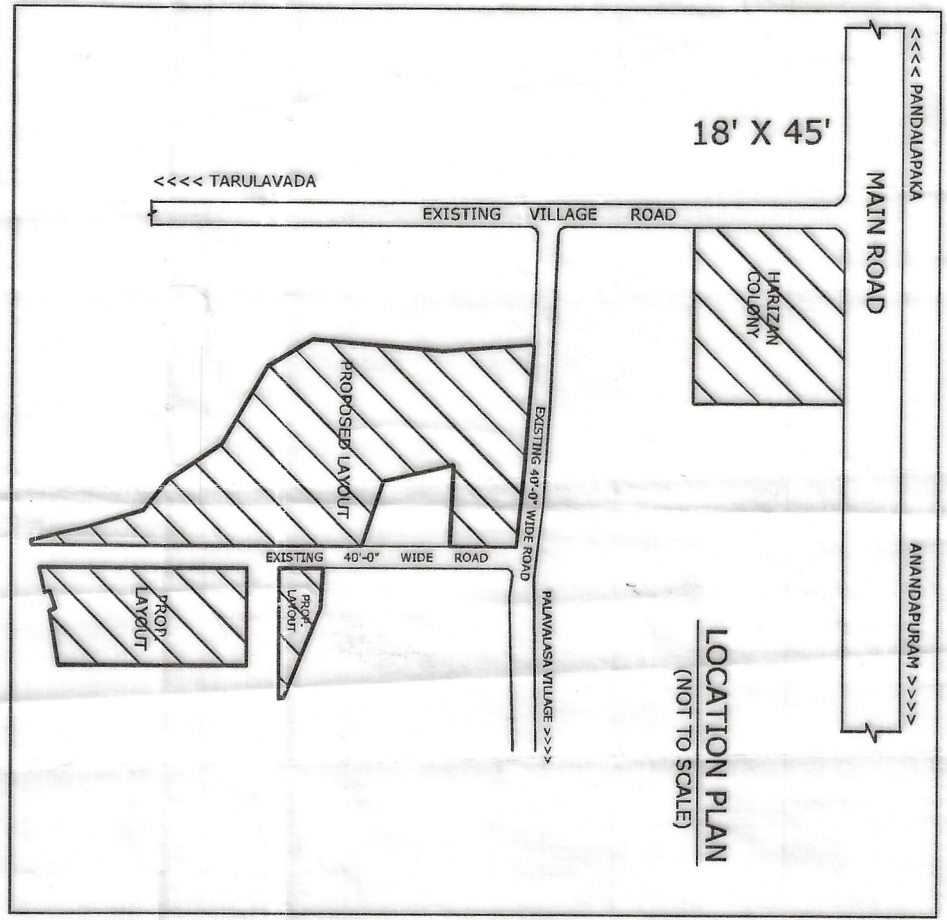

VUDA SUBMISSION LAYOUT  
 FILE RC.NO: 2711 /2015/L6