

PROPOSED LAY-OUT FOR
S.NO. 34/2 OF BAKKANNA
PALEM VILLAGE OF VISAKHA-
PATNAM MANDAL BELONGS
TO P. GOVINDA RAO.

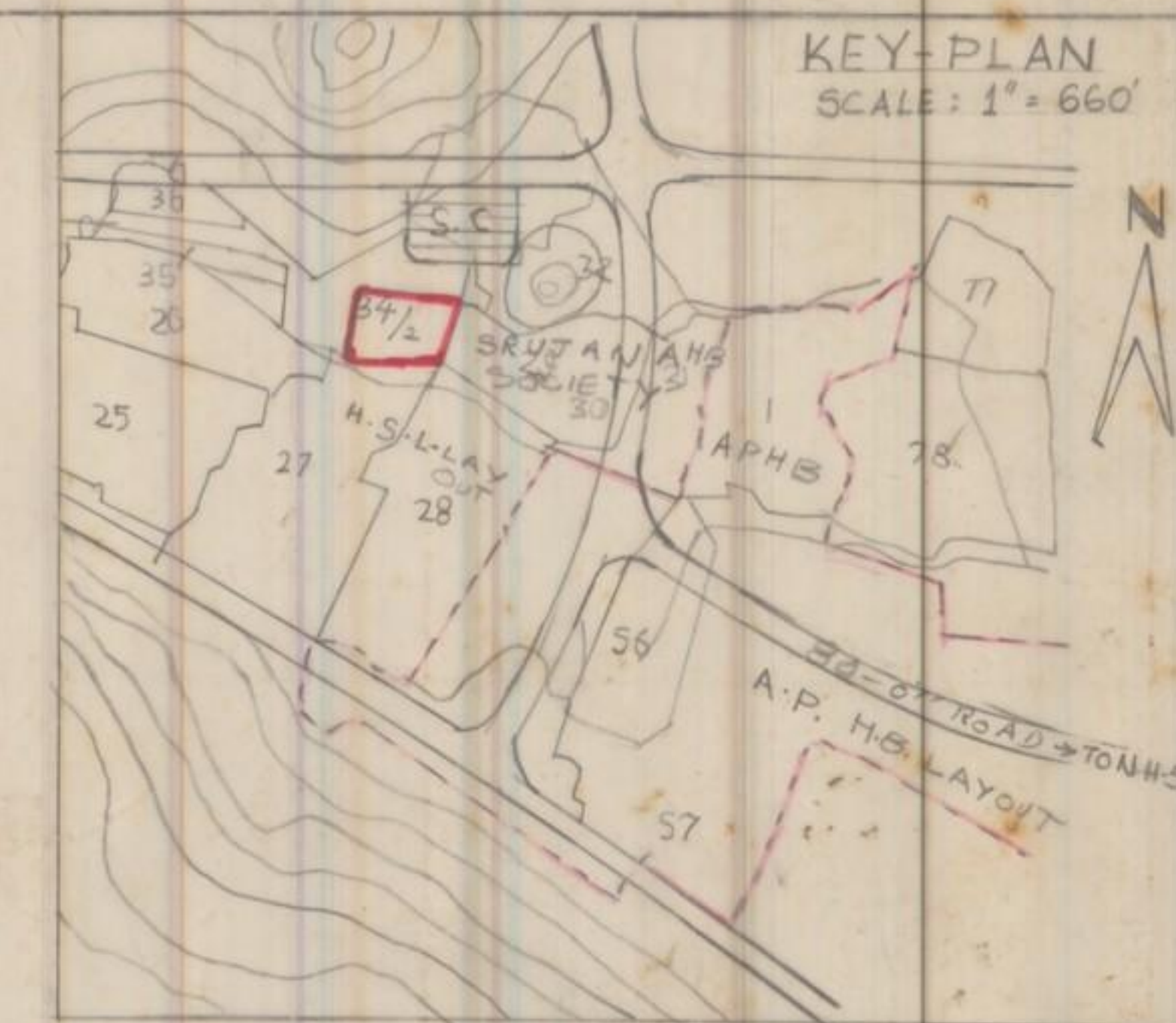

LAND-USE ANALYSIS

SL.NO.	DESCRIPTION	EXTENT AC. - CT.	PERCENTAGE
1.	PLOTTED AREA	0.88	58.67
2.	ROADS AREA	0.47	31.33
3.	OPEN SPACE AREA	0.15	10.00
TOTAL EXTENT OF LAY-OUT:		1.50	100.00

- LAY-OUT BOUNDARY.

SL.NO.	SIZE OF PLOTS	NO. OF PLOTS
1.	40' X 60'	7
2.	30' X 60'	9
3.	30' X 50'	2
TOTAL :		18

SCALE : 1"=66'
FILE RC.NO:968/88H
BLP.NO :
L.P.NO : 8/93

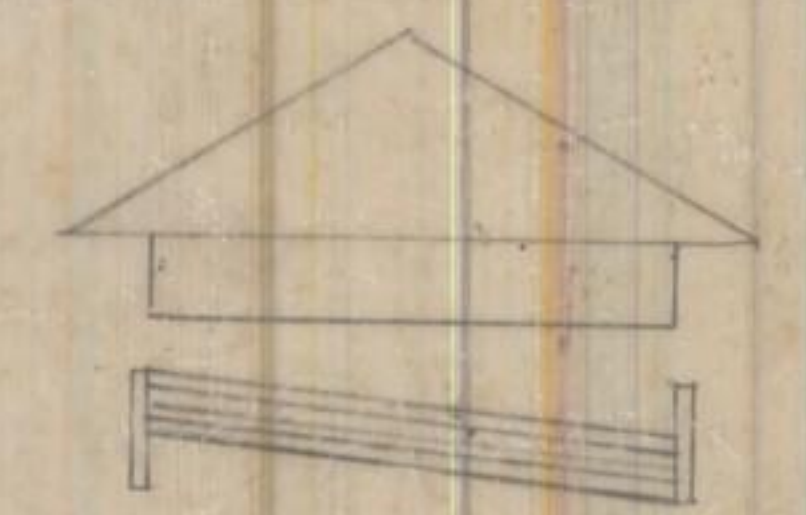

V. Sridhar
SURVEYOR / D.M.A.N.

P. Govinda Rao
CHIEF TOWN PLANNER
&
PROJECT DIRECTOR / C.

V. Srinivas
JUNIOR PLANNING OFFICER

S. Prasad
ASSISTANT TOWN PLANNER

VICE CHAIRMAN

VISAKHAPATNAM URBAN
DEVELOPMENT AUTHORITY.

