

140
 REVISED LAY-OUT PLAN FOR
 S. NOS. 5, 8, 9, 10, 11, 12, 13 & 14 OF
 RUSHIKONDA VILLAGE BELONGS
 TO SRI KRISHNA CO-OP. H.B.
 SOCIETY LTD REGD. NO. B-624.

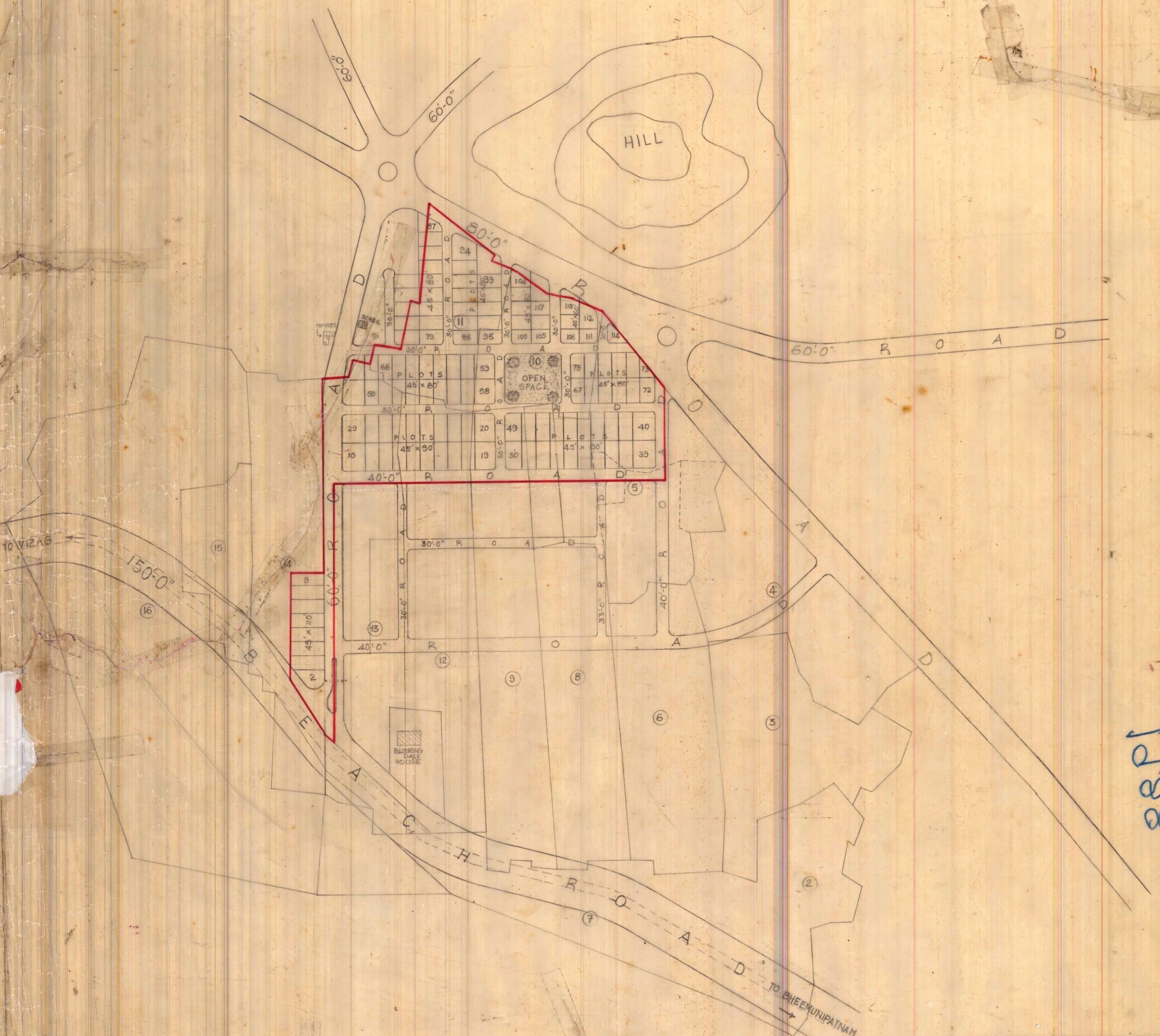

LAND USE ANALYSIS

SL. NO	DESCRIPTION	EXTENT A.C.C.T	PERCENTAGE
1.	PLOTTED AREA	9.89	67.19
2.	ROADS AREA	4.09	27.78
3.	OPEN SPACE AREA	0.74	5.03
TOTAL EXTENT OF LAYOUT		14.72	100.00

— LAY OUT BOUNDARY

SL. NO	SIZE OF PLOTS	NO OF PLOTS
1	45'-0" X 110'-0"	8
2	45'-0" X 90'-0"	40
3	45'-0" X 80'-0"	50
4	45'-0" X 60'-0"	14
TOTAL NO OF PLOTS:		112

NOTE:

1. THE PLOT NO. 1 AS PER APPROVED LAYOUT L.P. NO. 5/80 HAVE BEEN DELETED AS THEY WERE AFFECTED IN 150'-0" WIDE BHEEMILI-BEACH ROAD WIDENING.
2. THE PLOT NOS. 113 & 115 HAVE BEEN DELETED AS THEY WERE AFFECTED BY THE PROPOSED 80'-0" WIDE ROAD ALIGNMENT.
3. THE PLOT NOS. 87 & 73 WERE PARTIALLY AFFECTED BY THE PROPOSED 80'-0" WIDE ROAD ALIGNMENT.

SCALE: 1" = 132'
 FILE R.C. NO. 193/85H,
 L.P. NO : 85/88
 (THIS REVISES L.P. NO 5/80
 IN FILE R.C. NO: 512/80H)

W. S. Reddy
 20/9/88
 SURVEYOR/D.M.A.

V. Adarsh
 20/9/88
 JUNIOR PLANNING OFFICER

[Signature]
 ASSISTANT TOWN PLANNER



[Signature]
 CHIEF TOWN PLANNER I/C.

[Signature]
 VICE CHAIR MAN

VISAKHAPATNAM URBAN
 DEVELOPMENT AUTHORITY

8891