

**PROPOSED LAYOUT PLAN OF
IN S.Nos: 177p,178p,179p,
180p,181p & 182p OF
KOTHURU - VILLAGE
RAMBILI - MANDAL
VISAKHAPATNAM - DISTRICT.**

Belongs To:-
Indur Developers and Agencies Pvt. Ltd.

TOTAL SITE AREA : AC 17.53 CTS
M.P.ROAD WIDENING AREA : AC 0.58 CTS
NET AREA : AC 16.95 CTS

LAND USE ANALYSIS :-

SL. NO.	DESCRIPTION	EXTENT IN ACs. - CTS.	PERCENTAGE
1.	PLOTTED AREA	9.16	56.87 %
2.	AMENITIES AREA	0.48	33.10 %
3.	ROADS AREA	5.61	10.03 %
4.	OPEN SPACE AREA	1.70	100.00 %
TOTAL AREA		16.95	100.00 %

PLOTS DETAILS :-

SL.NO.	PLOT SIZE	PLOT AREA IN Sq Yds	NO OF PLOTS
1	60 X 101'	673.33	01
2	60 X 89'	603.22	01
3	50' X 70'	388.88	04
4	40' X 70'	311.11	11
5	40' X 60'	266.66	31
6	36' X 60'	240.00	09
7	36' X 55'	220.00	19
8	30' X 60'	200.00	52
9	36' X 45'	180.00	06
10	30' X 50'	166.66	27
11	30' X 30'	100.00	03
12	18' X 45'	90.00	67
TOTAL NO OF PLOTS		900.00	231

PROPOSED LAYOUT BOUNDARY.

FILE R.C.NO: 3356 / 2015 / L.I.
L.P.NO: 87/2015

PLOTS MORTGAGED TO VUDA
PLOT NOS: 91 TO 93, 135 TO 145 &
152 TO 157
EXTENT: AC 1.46 CTS
TOTAL NO. OF PLOTS - 20

SCALE :
1" = 100'-0"

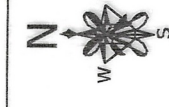

H. Adeshwar Murthy
LICENCED SURVEYOR
VISA KHAPATNAM
Ph: 7093144567

OWNERS SIGN.

20.7.2015
A.D.M
Planning Officer

Chief Urban Planner

VICE CHAIRMAN

VISAKHAPATNAM URBAN
DEVELOPMENT AUTHORITY

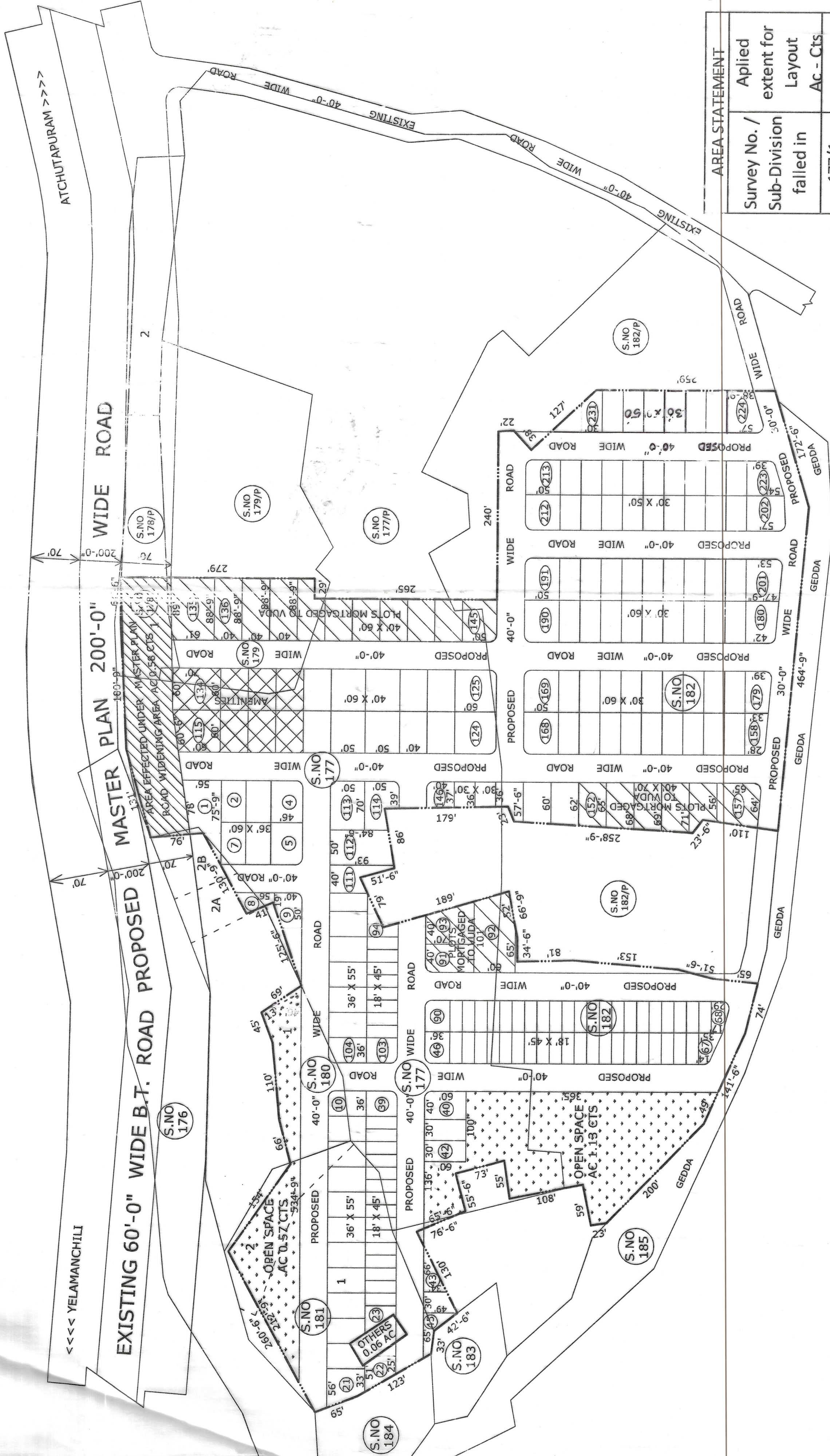

AREA STATEMENT	
Survey No. / Sub-Division	Applied extent for Layout Ac - Cts
177/1	6.230
177/2	0.250
178/1	0.700
179	0.500
180/1	0.030
180/2a	0.020
180/2b	1.320
181/1a	0.330
181/1b	8.150
181/2	
182	
TOTAL	17.530