

PROPOSED LAYOUT IN SNO

47, 49, 51 & 52 OF VADLA PUDI

(W); GAJUMAKA MANDAL

BELONGS TO SRI Y. RAJU TALKI OTS

LAND USE ANALYSIS

S.NO	DESCRIPTION	EXTENT	PERCENTAGE
1.	PLOTTED AREA	6.30	56.02
2.	ROADS AREA	3.68	32.24
3.	COMMUNITY FACILITIES	0.14	1.24
4.	OPEN SPACE	1.12	9.90
TOTAL		11.24	100.00

LAYOUT BOUNDARY

NO. OF PLOTS: 50

SIZE OF PLOTS: 30x50, 40x50, 35x55

TOTAL NOS: 50

TOTAL NO. OF PLOTS: 125 NOS

FILE NO: 9/93

L.P. NO: 13/91

SCALE: 1 INCH = 66'

KEY PLAN

PLANNING OFFICE

URBAN DEVELOPMENT

AUTHORITY

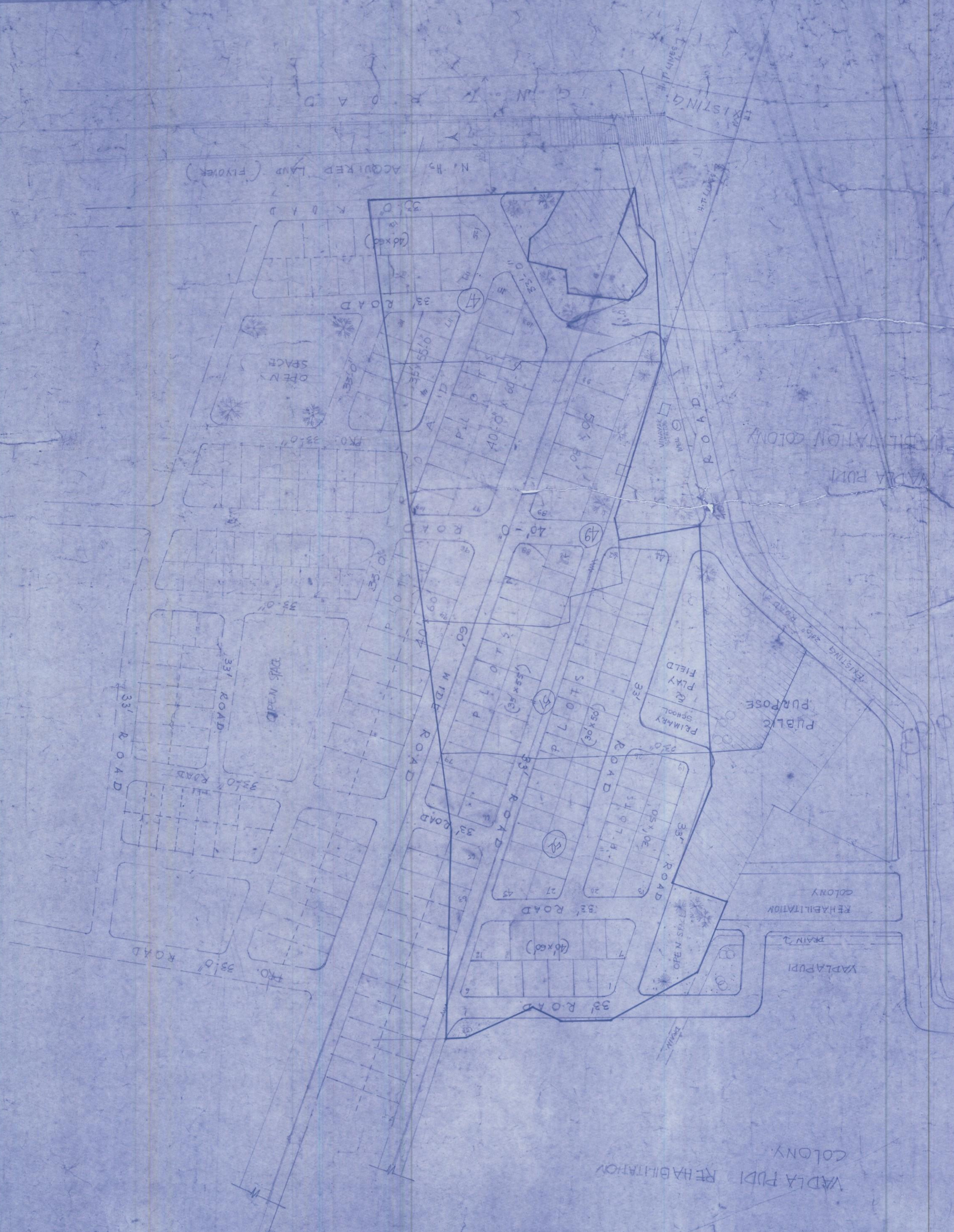

80'0" WIDE

EXISTING

EXISTING

EXISTING

EXISTING

EXISTING