

PROPOSED LAY OUT FOR
S.NOS. 348/P 349/P & 350/P OF
KAPULUPPADA VILLAGE OF
BHIMILIPATNAM MANDAL
BELONGS TO SRI M.V. RAMA RAO
AND 3 OTHERS.

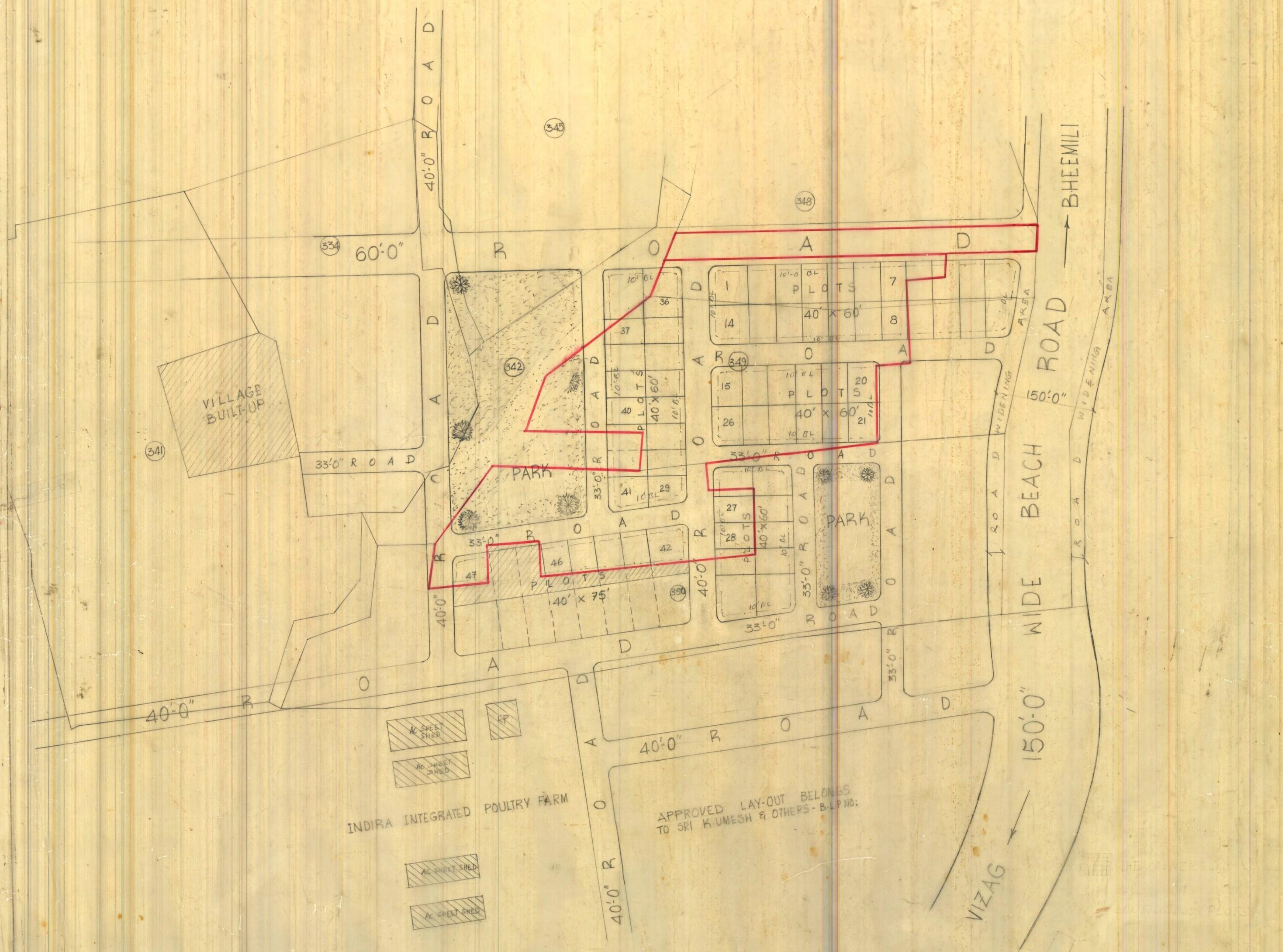

LAND USE ANALYSIS

SL. NO.	DESCRIPTION	EXTENT AC-CT	PERCENTAGE
1	PLOTTED AREA	2-80	59.96
2	ROADS AREA	1-37	29.33
3	OPEN SPACE AREA	0-50	10.71
TOTAL EXTENT OF LAY-OUT:		4-67	100.00

— LAY-OUT BOUNDARY

SL. NO.	SIZE OF PLOTS	NO. OF PLOTS
1.	40'-0" x 60'-0"	41
2.	40'-0" x 75'-0"	6
TOTAL PLOTS		47

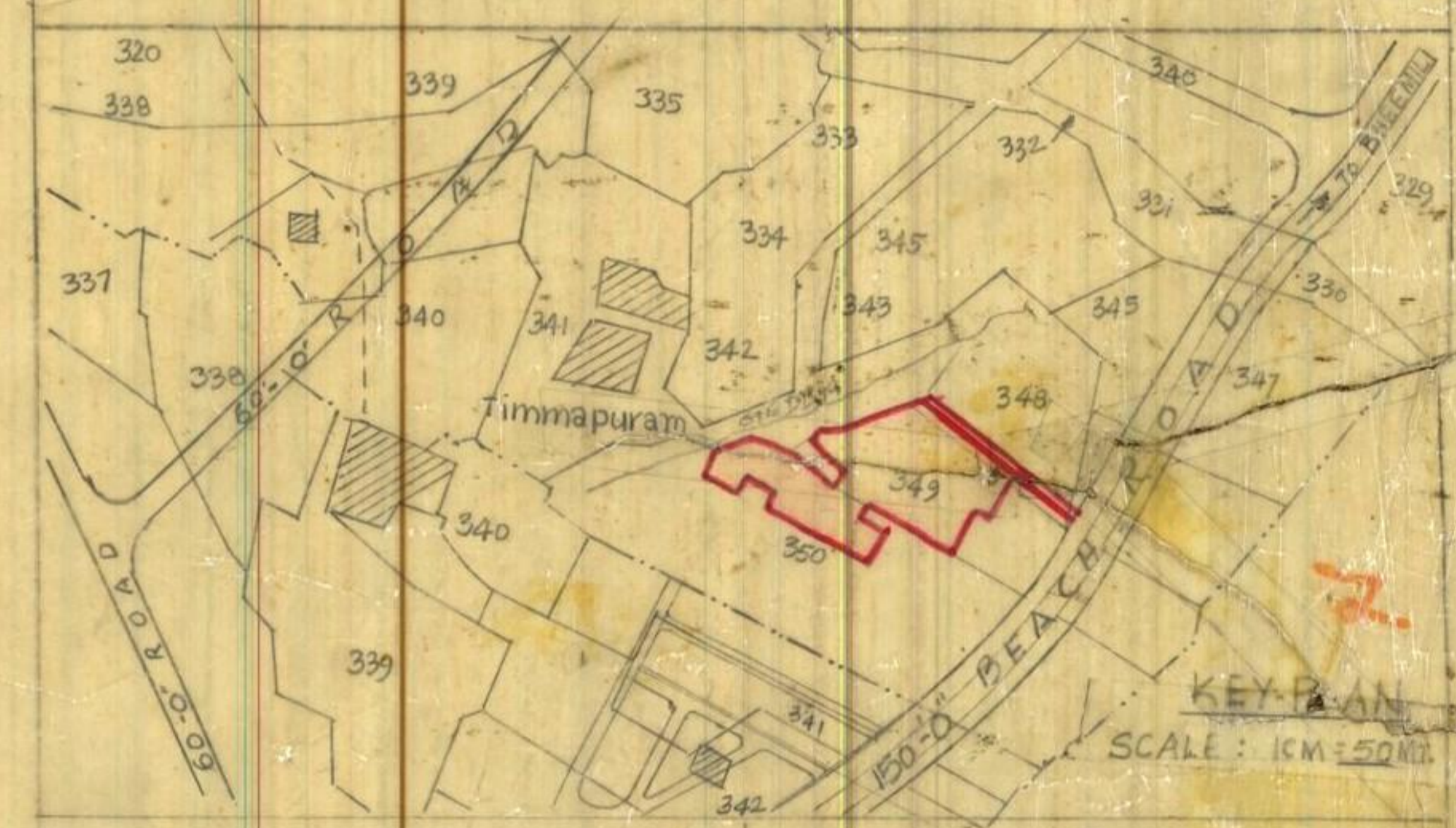

SCALE: 1" = 66'-0"
FILE R.C NO. 2762/88 H1
L.P. NO: 91/89
(B.L.P. 32/88)

INDIRA INTEGRATED POULTRY FARM

APPROVED LAY-OUT BELONGS
TO SRI K. UMESH & OTHERS - B.L.P. NO:

M. Venkatesh
SURVEYOR/D.M.A.N.

V. Subrahmanyam
JUNIOR PLANNING OFFICER

S. Prasad
ASSISTANT TOWN PLANNER

K. Chandra
CHIEF TOWN PLANNER I/C

VICE CHAIRMAN

VISAKHAPATNAM URBAN
DEVELOPMENT AUTHORITY

THE LAY-OUT OWNER SHOULD
ACQUIRE THE LANDS TO HAVE
REGULAR PLOTS.