

PROPOSED LAYOUT PLAN FOR RESIDENTIAL PLOTS IN S.Nos: 38p OF MODAVALASA VILLAGE, DENKADA MANDAL, VIZIANAGARAM-DIST.

S.NO / SUB DIVISION	EXTENT AC-CTS
38/4p	0.10
38/5	0.16
38/6	0.15
38/7	0.33
38/8	0.16
38/9	0.16
38/10	0.22
38/15	0.52
38/16	0.25
38/47	0.22
TOTAL	7.75

SL. NO.	DESCRIPTION	EXTENT ACs.- CTS.	PERCENTAGE
1.	PLOTTED AREA (INCLUDING ST. AMENITIES)	4.60	59.35 %
2.	ROADS AREA	2.37	30.59 %
	OPEN AREA	0.78	10.06 %
	TOTAL AREA	7.75	100.00 %

SL.NO.	PLOT SIZE	PLOT AREA IN Sq Yds	NO OF PLOTS
1	60' X 87'	580.00	01
2	70' X 72'	560.00	01
3	60' X 60'	400.00	06
4	40' X 80'	355.55	11
5	40' X 60'	266.66	02
6	49' X 45'	245.00	04
7	40' X 50'	222.22	02
8	30' X 60'	200.00	55
9	18' X 45'	90.00	25
TOTAL			107

S.NO / SUB DIVISION	EXTENT AC-CTS
38/4p	0.10
38/5	0.16
38/6	0.15
38/7	0.33
38/8	0.16
38/9	0.16
38/10	0.22
38/15	0.52
38/16	0.25
38/47	0.22
TOTAL	7.75

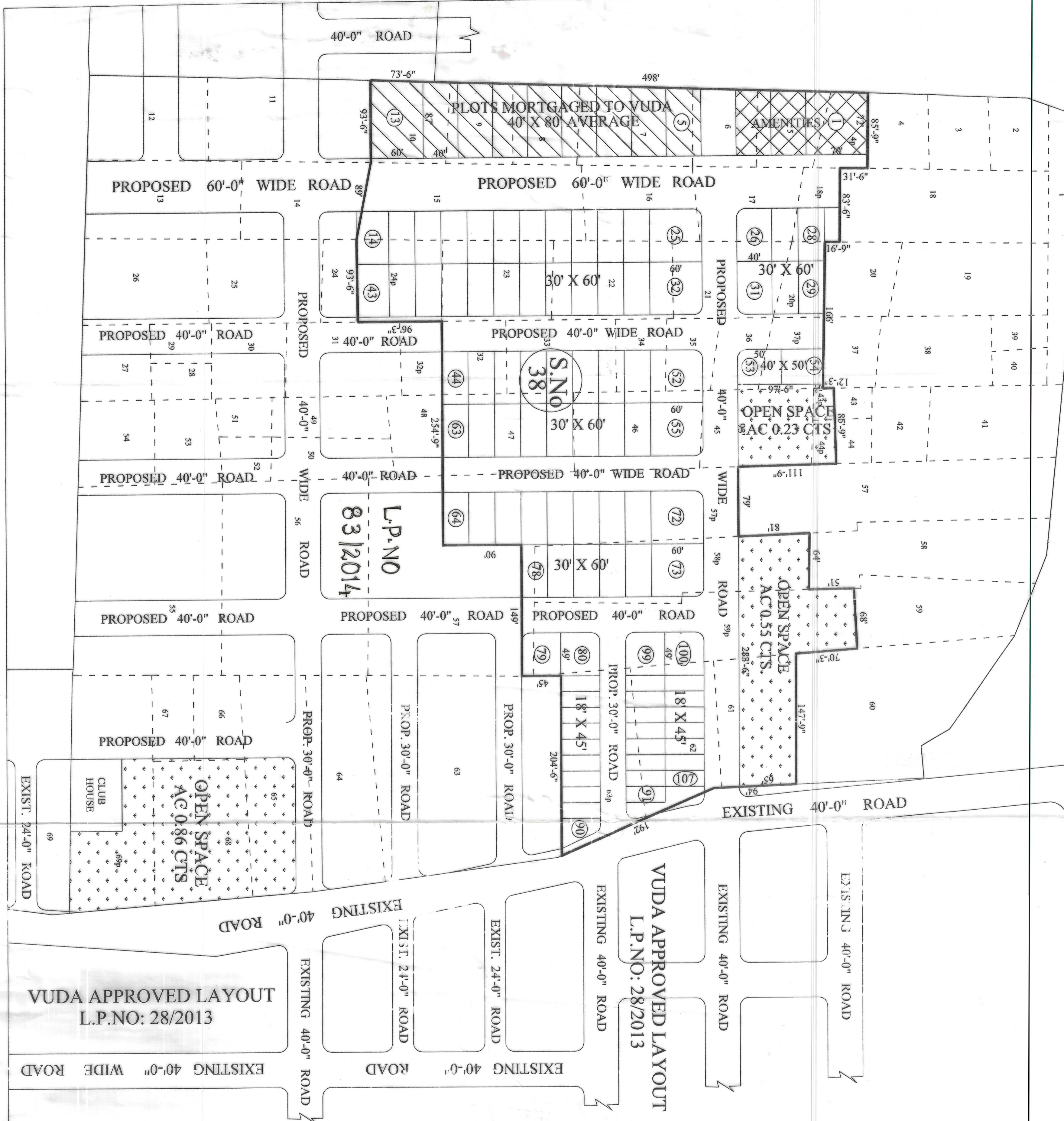

AREA STATEMENT

LAND USE ANALYSIS:-

PLOTS MORTGAGED TO VUDA

PLOTS NOS: 5 TO 13

NO. OF PLOTS: 09

EXTENT: AC 0.72 CTS

SCALE: 1" = 66'-0"

FILE R.C.NO: 10909/2014/L8

L.P.NO: 91/2015

PROPOSED LAYOUT BOUNDARY

OWNERS SIGN.

LICENCED SURVEYOR

PLANNING OFFICER

VICE CHAIRMAN

CHIEF URBAN PLANNER

VISAKHAPATNAM URBAN DEVELOPMENT AUTHORITY