

**PROPOSED LAYOUT IN S.NO.272/P  
274/1p OF ALAMANDA VILLAGE  
JAMI MANDAL,  
VIZIANAGARAM DISTRICT.**

SITE BELONGS TO:  
**K.S.SATYANARAYANA REDDY**



**LAND USE ANALYSIS**

SL. NO.	DESCRIPTION	EXTENT IN Acs. - cts.	PERCENTAGE
1.	PLOTTED AREA	3.56	55.97 %
3.	ROADS AREA	2.13	
4.	OPEN SPACE AREA (INCLUDING GREEN BELT)	0.67	
<b>TOTAL AREA</b>		<b>6.36</b>	<b>100.00 %</b>

**PLOTS DETAILS :-**

SL.NO.	PLOT SIZE	PLOT AREA IN Sq Yds	NO OF PLOTS
1	40' X 60'	266.67	05
2	40' X 50'	222.22	01
3	30' X 50'	166.67	19
4	18' X 45'	99.00	19
5	30' X 60'	200.00	51

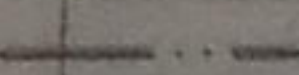
**TOTAL PLOT NO'S 95**

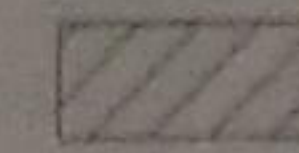
-  PROPOSED LAYOUT BOUNDARY
-  AMENITIES AREA Ac. 0.12 Cts
-  ROAD WIDENING AREA Ac. 0.17 Cts.
-  PLOTS MORTGAGE TO VUDA  
PLOT NO'S : 64 To 71 & 79 To 83  
(13 PLOTS) AREA: AC 0.56 CTS

SCALE:  
1" = 33'-0"

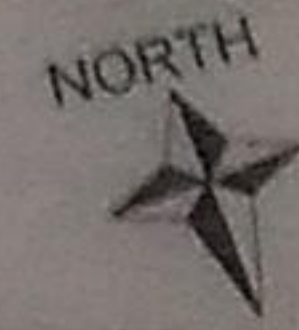

FILE RC.NO:  
L.P.NO: 97/2015

OWNERS SIGN. LICENCED SURVEYOR

A/D MAN

Chief Urban Planner

Planning Officer

VICE CHAIRMAN

**VISAKHAPATNAM URBAN  
DEVELOPMENT AUTHORITY**

AREA DETAILS		
SY.NO	DOC . EXTENT (AC CTS)	APPLIED EXTENT (AC CTS)
272/2	0.25	0.25
272/3	0.32	0.32
272/4	0.99	0.99
272/5	0.82	0.82
272/6	0.86	0.86
272/7p	1.52	1.52
272/9p	1.50	1.50
274/1	0.27	0.27
<b>TOTAL</b>	<b>6.53</b>	<b>6.53</b>
SITE LEFT FOR 100 Mts. MASTER PLAN ROAD WIDENING		(-) 0.17
<b>NET LAYOUT AREA</b>		<b>6.36</b>

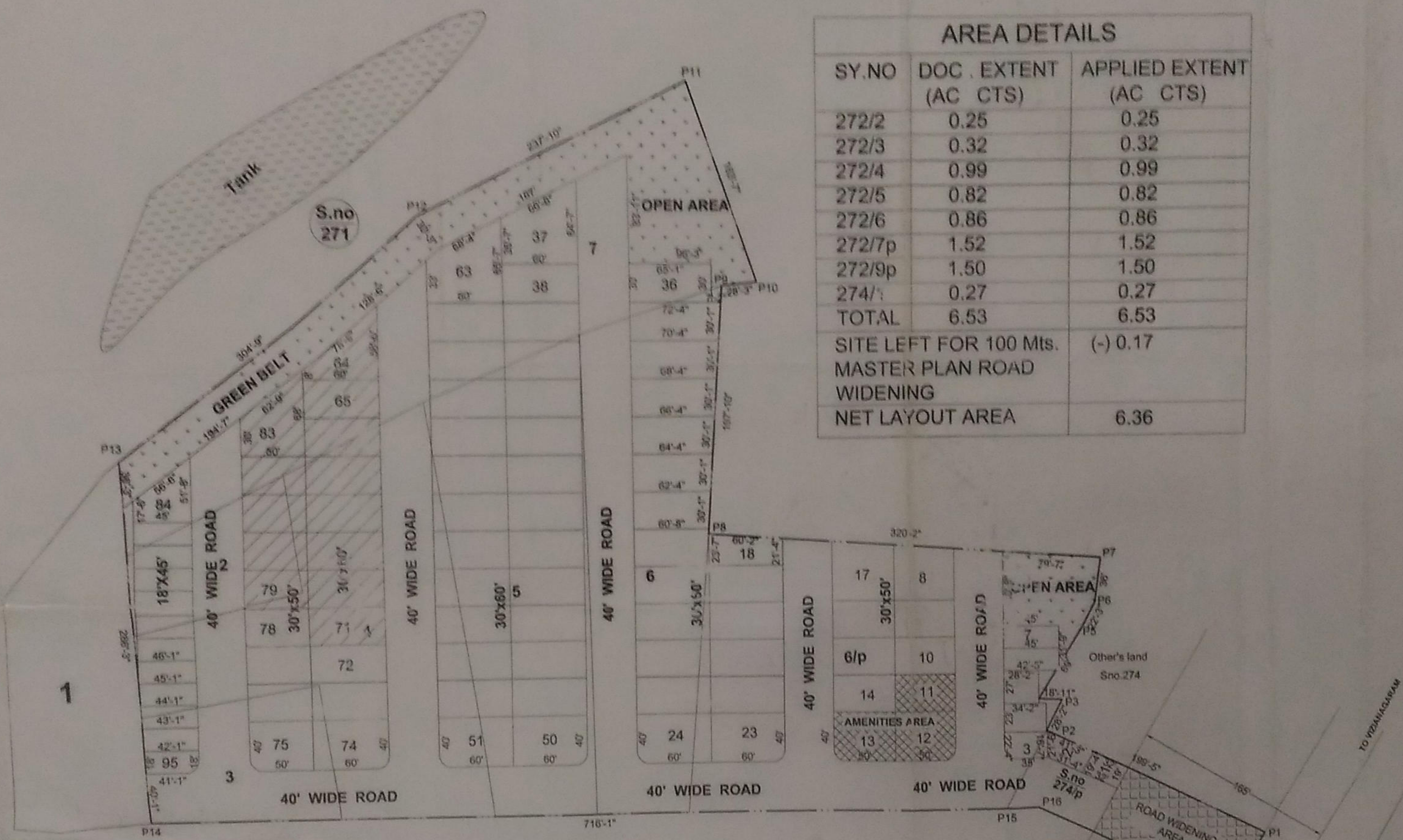

GEO COORDINATES		
Curve point Nos.	LATTUDE	LONGITUDE
P1	17°59'1.072"-N	E-83°13' 52.986"
P2	17°59'0.834"-N	E-83°13'52.691"
P3	17°59'1.0968"-N	E-83°13'51.7018"
P4	17°59'0.942"-N	E-83°13'52.391"
P5	17°59'1.806"-N	E-83°13'52.9032"
P6	17°59'1.9212"-N	E-83°13'52.6692"
P7	17°59'2.49"-N	E-83°13'52.8528"
P8	17°59'2.6808"-N	E-83°13'49.818"
P9	17°59'4.9812"-N	E-83°13'49.4112"
P10	17°59'3.876"-N	E-83°13'50.736"
P11	17°59'6.36"-N	E-83°13'49.8972"
P12	17°58'7.086"-N	E-83°13'57.0864"
P13	17°59'1.3228"-N	E-83°13'44.814"
P14	17°59'1.1328"-N	E-83°13'44.814"
P15	17°59'59.9052"-N	E-83°13'52.338"
P16	17°59'0.2508"-N	E-83°13'52.5792"
P17	17°59'59.4048"-N	E-83°13'53.364"